

SECTION A-A
SECȚIUNEA CURENTĂ A-A

Scale/Scale 1:50

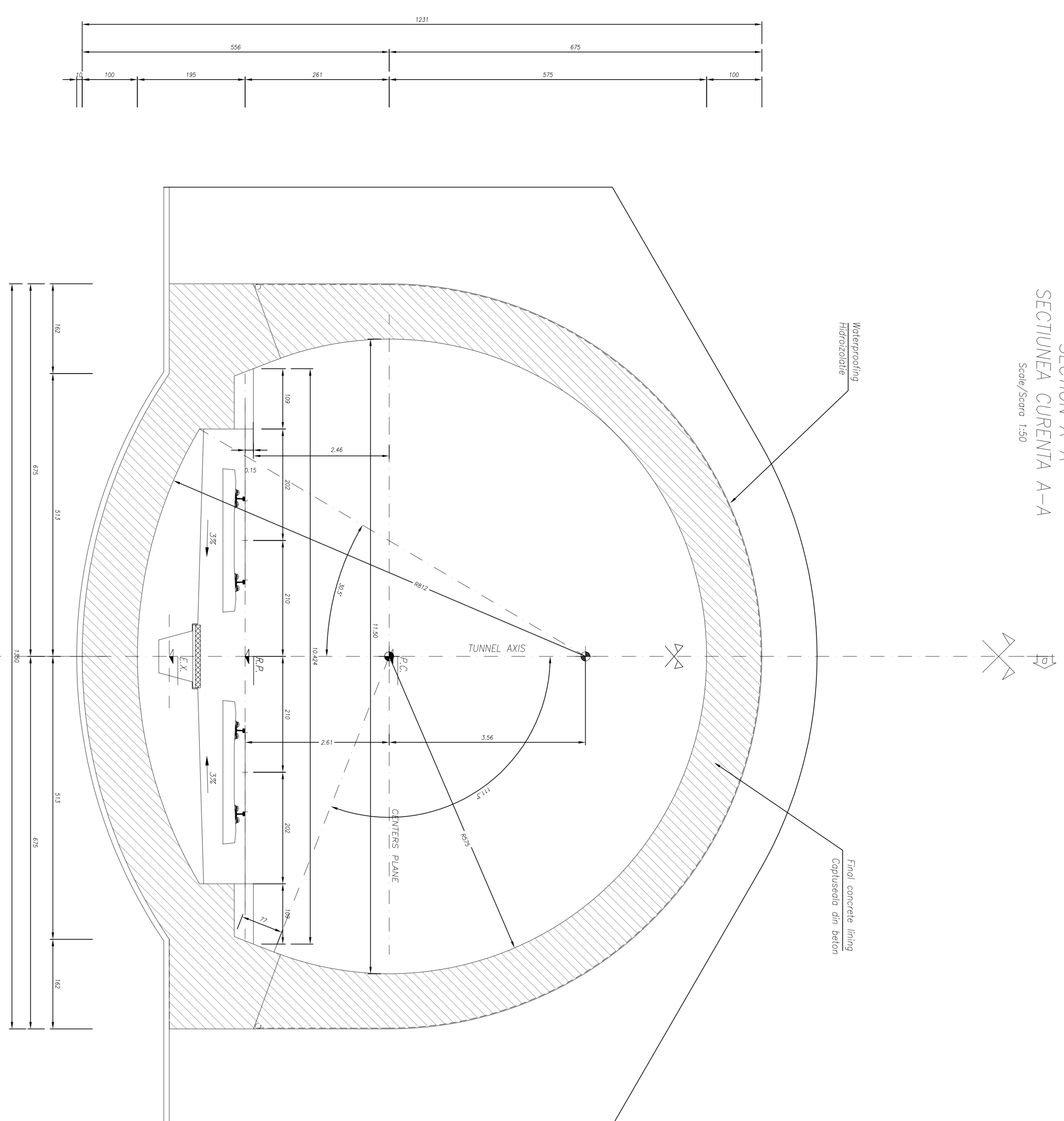

SECTION D-D
SECȚIUNEA D-D

Scale/Scale 1:50

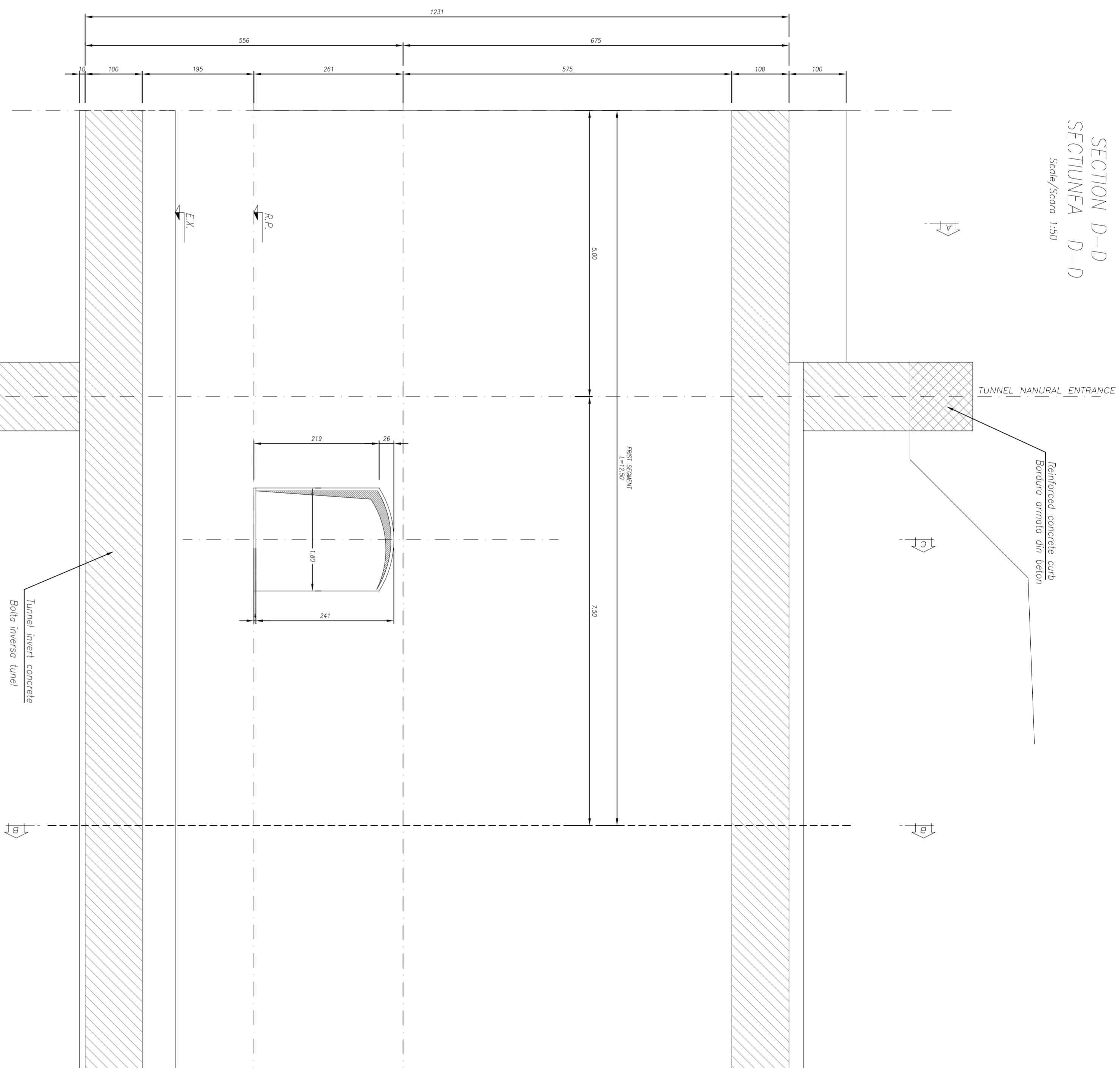

SECTION B-B
SECȚIUNEA CURENTĂ B-B

Scale/Scale 1:50

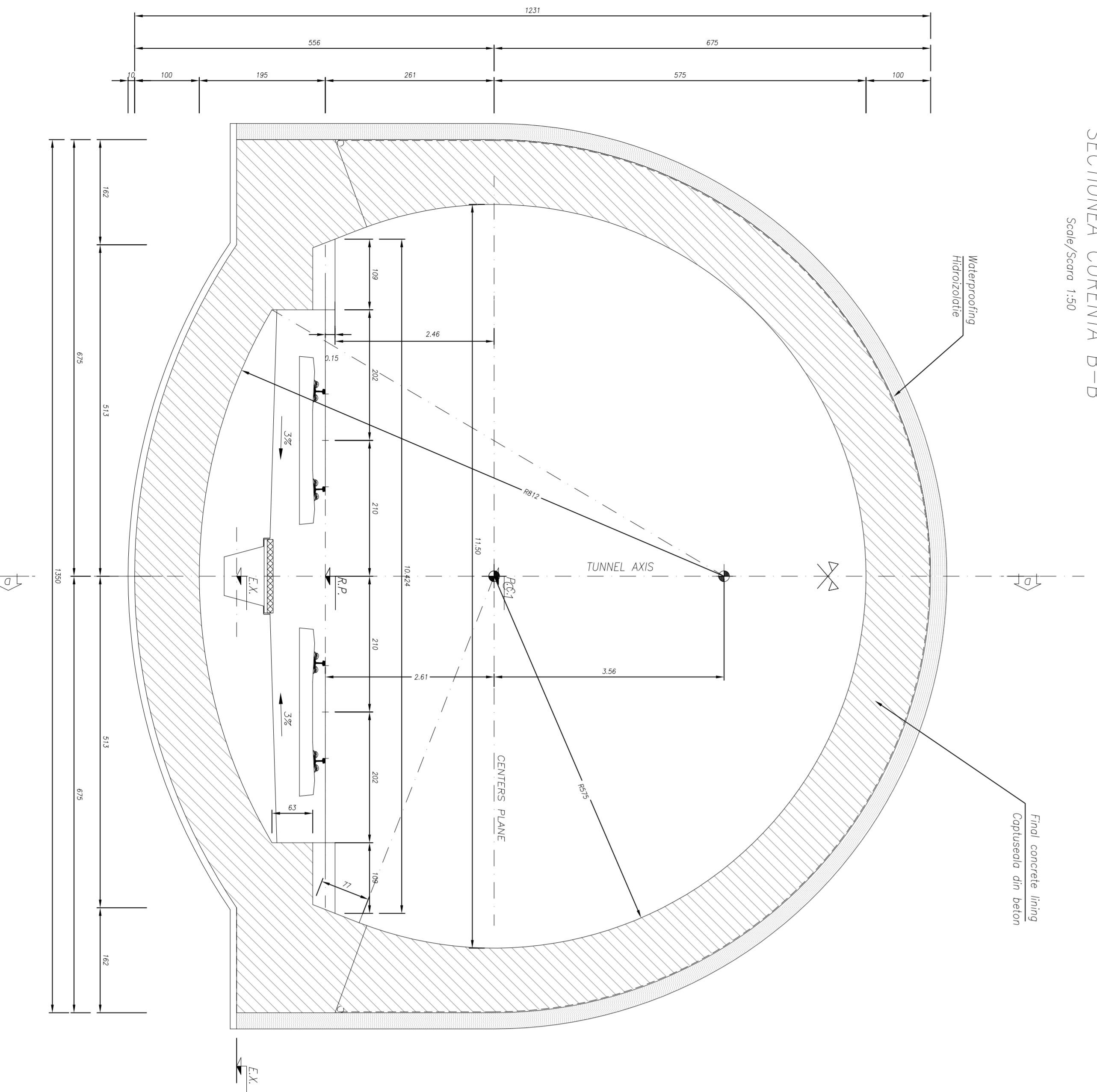

SECTION C-C
SECȚIUNEA CURENTĂ C-C

Scale/Scale 1:50

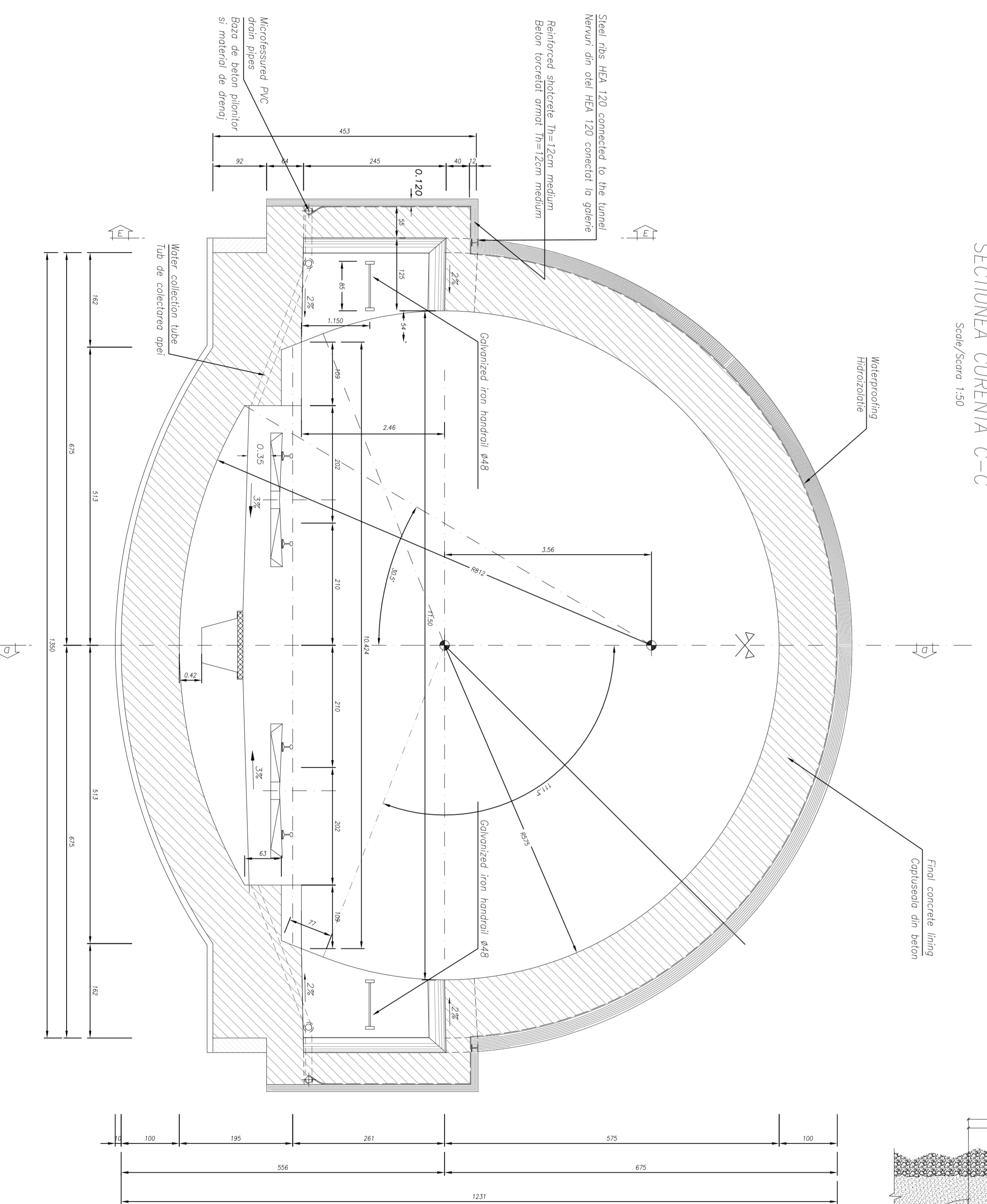

SECTION E-E
SECȚIUNEA CURENTĂ E-E

Scale/Scale 1:50

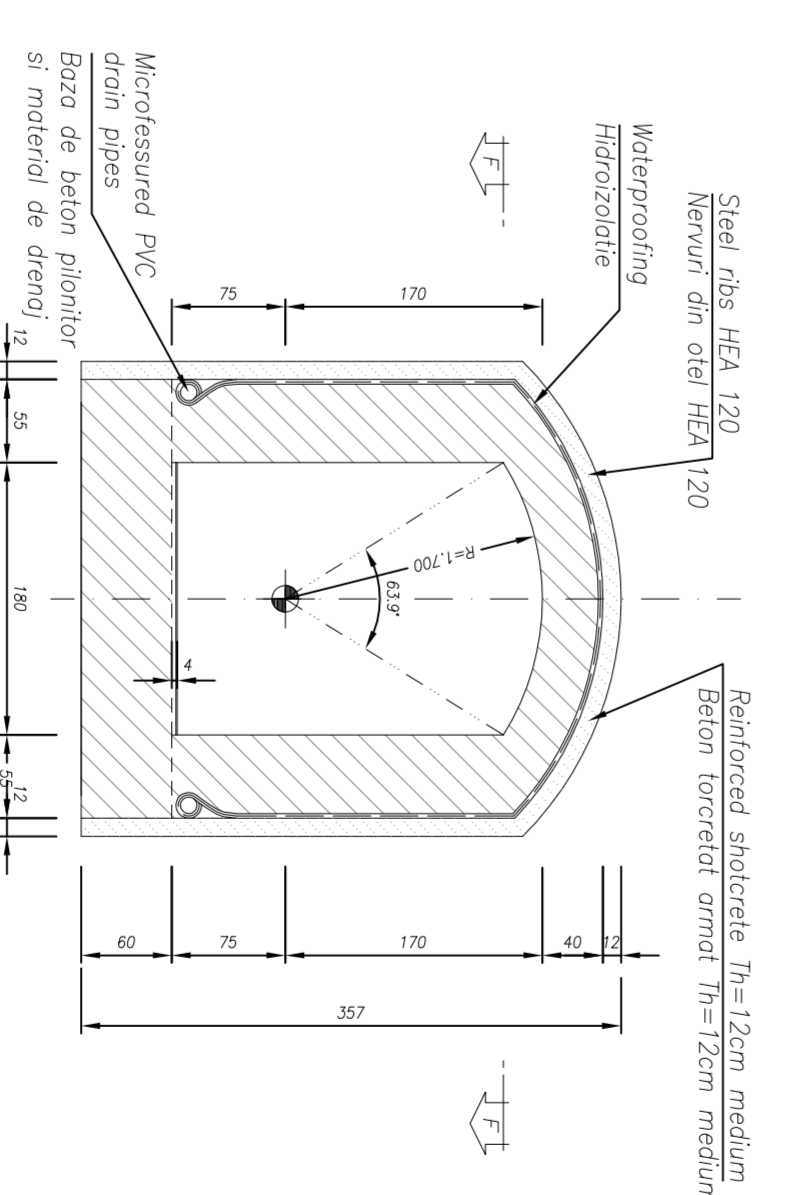

SECTION F-F
SECȚIUNEA CURENTĂ F-F

Scale/Scale 1:50

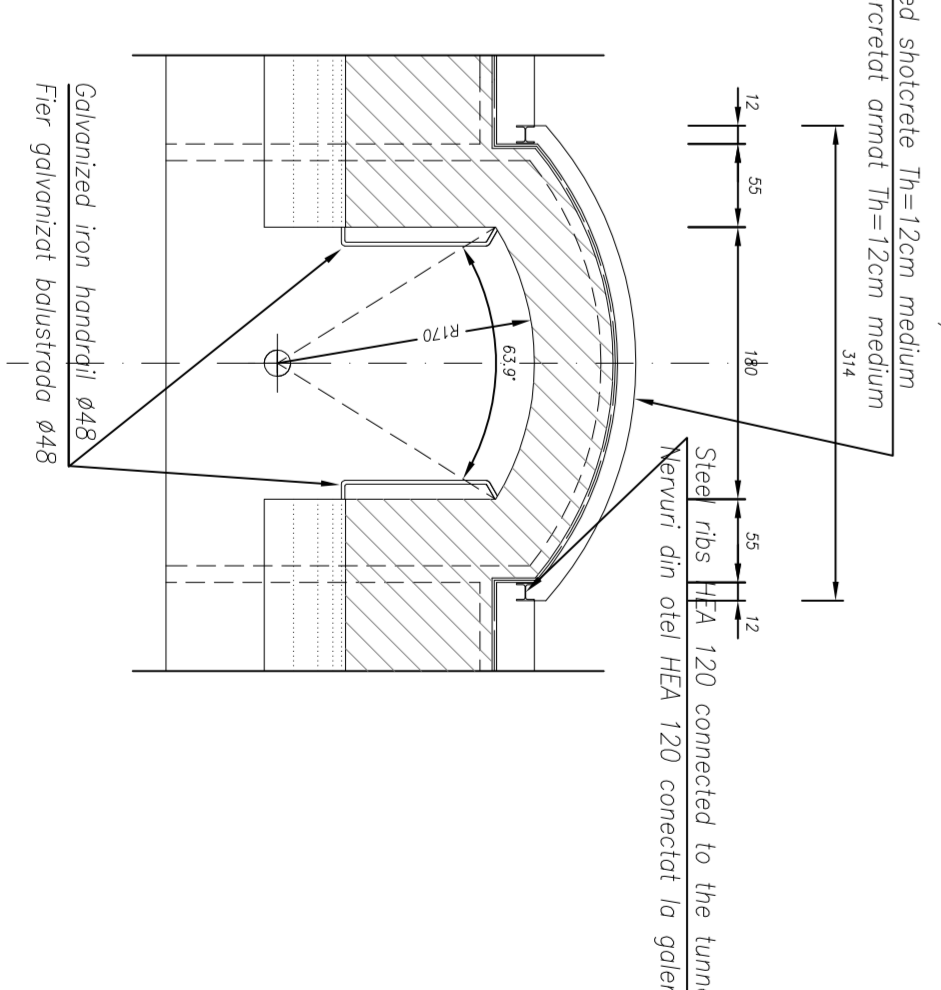

WATERPROOFING DETAIL
DETALIU HIDROIZOLATIE

Scale/Scale 1:10

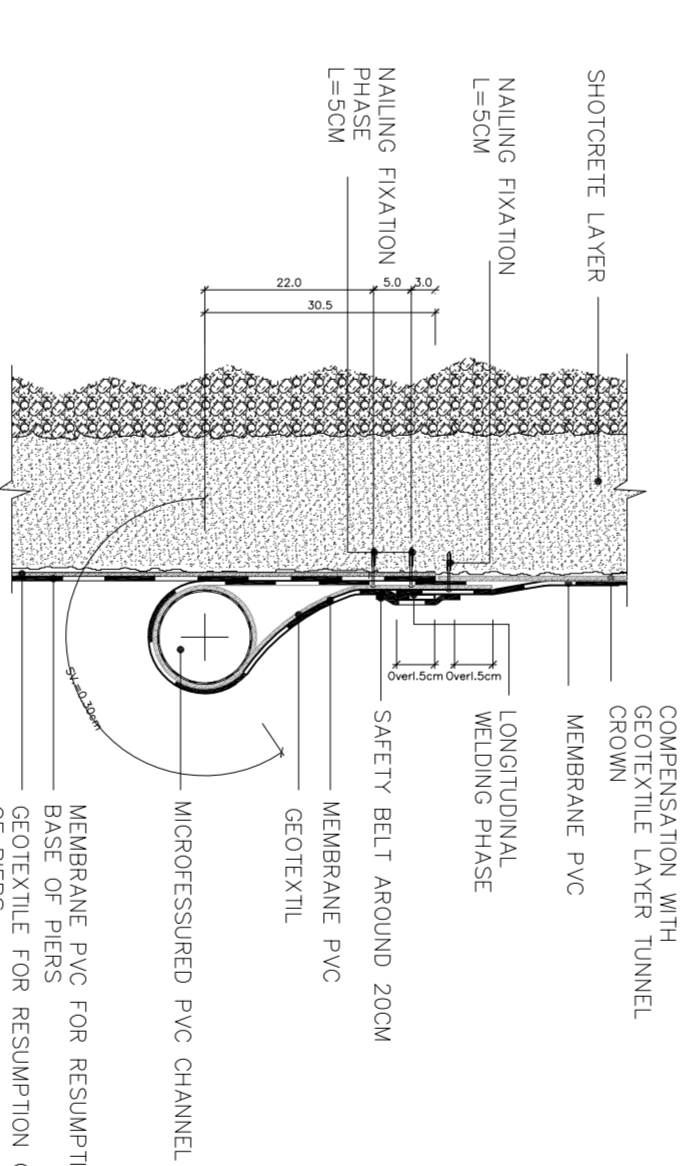

NOTE:
- Elemente de encașare trebuie să fie instalate pe pereți interiori la o distanță maximă între șanuri de encașare de 50m (4.2.2.9 Escape signage S10).

NOTE:
- Escape signs shall be installed on the side walls of a maximum distance between escape signs of 50m (4.2.2.9 Escape signage S10).

NOTE:
- Baza de mână trebuie să fie instalată aproximativ la 1 m deșupra cor de evacuare oferind un traseu într-o zonă sigură (4.2.2.7 enclosure refuge S10).

NOTE:
- Handrail shall be installed approximately of 1 m above walkway providing a route to a safe zone (4.2.2.7 Escape refuge S10).

NOTE:
- Împrejură structura de beton a tunelului artificial și natural, trebuie să rămână integră în caz de incendiu (4.2.2.3 cerințe de protecție în structura S3) (reinforced Specification for integrityS3).

NOTE:
- The integrity of the concrete structures of the artificial and natural tunnels have to be maintained in case of fire (4.2.2.3 fire protection requirements for structure S3) (reinforced Specification for integrityS3).

MATERIAL TABLE

- ITEMS:
 - Class C25/30
 - Water/Cement ratio 0.230
 - Exposure class related to environmental conditions: XE2
 - Concrete cover related to environmental conditions: XE2
 - Class of Reinforcing steel: A 420S
 - # min. ø rebar = 20 mm
 - # max. ø rebar = 32 mm
- ITEMS: CONCRETE
 - Class C30/36
 - Water/Cement ratio 0.230
 - Exposure class related to environmental conditions: XE2
 - Concrete cover related to environmental conditions: XE2
 - Class of Reinforcing steel: A 420S
 - # min. ø rebar = 20 mm
 - # max. ø rebar = 32 mm
- ITEMS: STEEL
 - Rebar covered by endowment
 - Rebar 1: 12 MPa
 - Rebar 2: 12 MPa
 - Rebar 3: 12 MPa
 - Rebar 4: 12 MPa

LEGEND

- RP = REFERENCE PLANE
- EX = EXCAVATIONS PLANE
- PC = CENTER'S PLANE

CLIENT / CLIENT	GOVERNMENT ROMANIA EUROPEAN UNION FINANCED PROJECT
CONSULTANT / CONSULTANT	TECNIC CONSULTING ENGINEERS
SUBCONSULTANT / SUBCONSULTANT	MUREN TUNNEL
CLIENT / CLIENT	C.N.C.F. "C.F.R." - S.A.
CONSULTANT / CONSULTANT	OBERTMEYER
SUBCONSULTANT / SUBCONSULTANT	TECNIC
APPROVED	R. LUTZA
APPROVED	C. GEMHILL
APPROVED	C. GEMHILL
APPROVED	C. GEMHILL
APPROVED	C. GEMHILL

PROJECT INFORMATION

Designation of the railway line: Mureș - Sibiu, component part of the IV Pan-European route, with a maximum speed of 160 km/h.

Project/Project: 204/RSO/16/27/002

Faza / Phase: P.1.H. / 1.D.

Denumire desen / Drawing Title: MUREN TUNNEL

Prima segmente conținutul de construcție

Configurație / Configuration System	Sistem / System	Lot / Lot	Nr. nr. / No.
E A 1 1	0 1	C 1 6	B B G A 1 1 0 0 0 0 4 0