

Total Volume at Station 0+000.00	
Cut Area	2.67
Fill Area	2.94
Cut Vol	0.00
Fill Vol	0.00
Cum Cut Vol	0.00
Cum Fill Vol	0.00
Net Vol	0.00

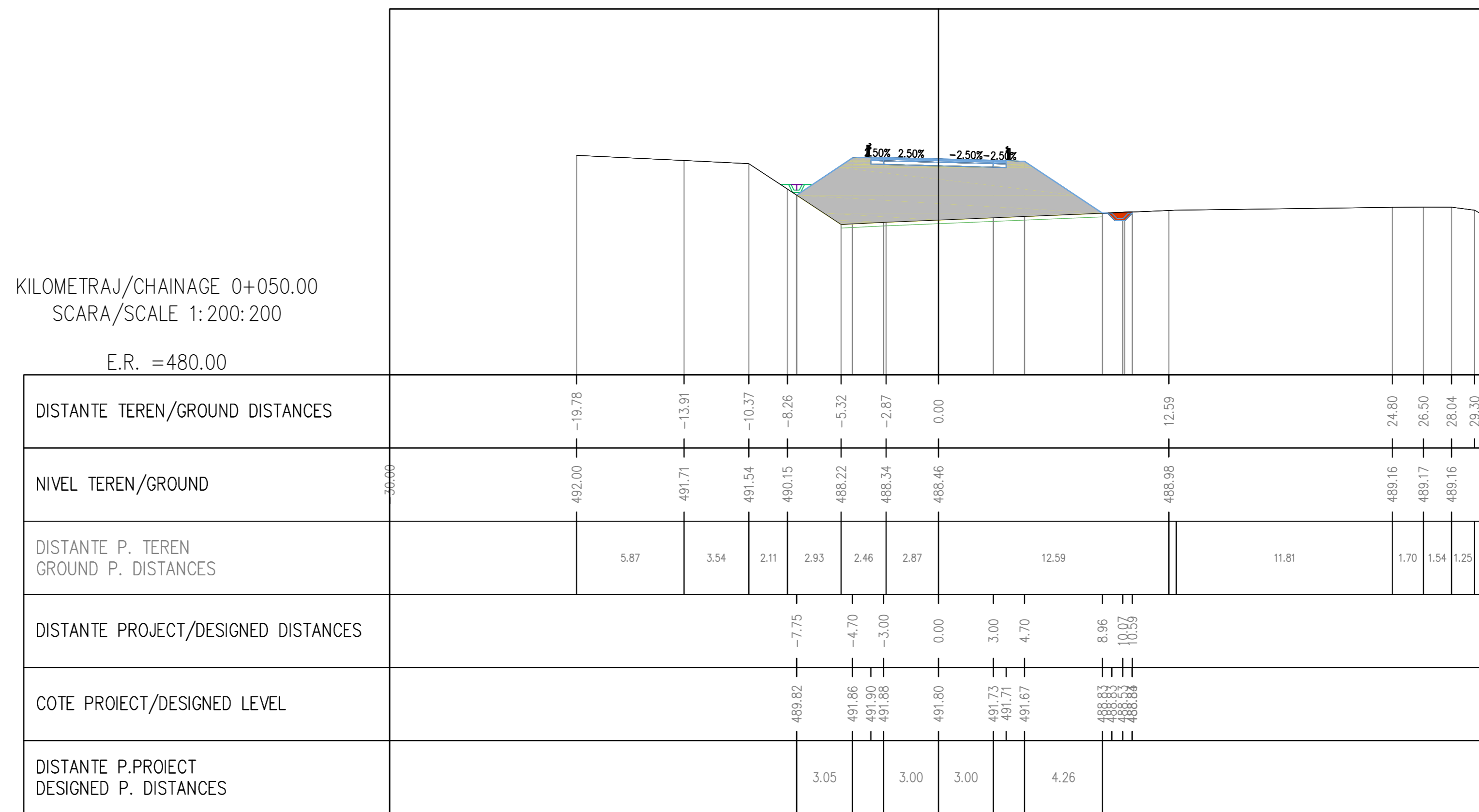

Total Volume at Station 0+050.00	
Cut Area	0.43
Fill Area	41.03
Cut Vol	77.35
Fill Vol	1099.30
Cum Cut Vol	77.35
Cum Fill Vol	1099.30
Net Vol	-1021.95

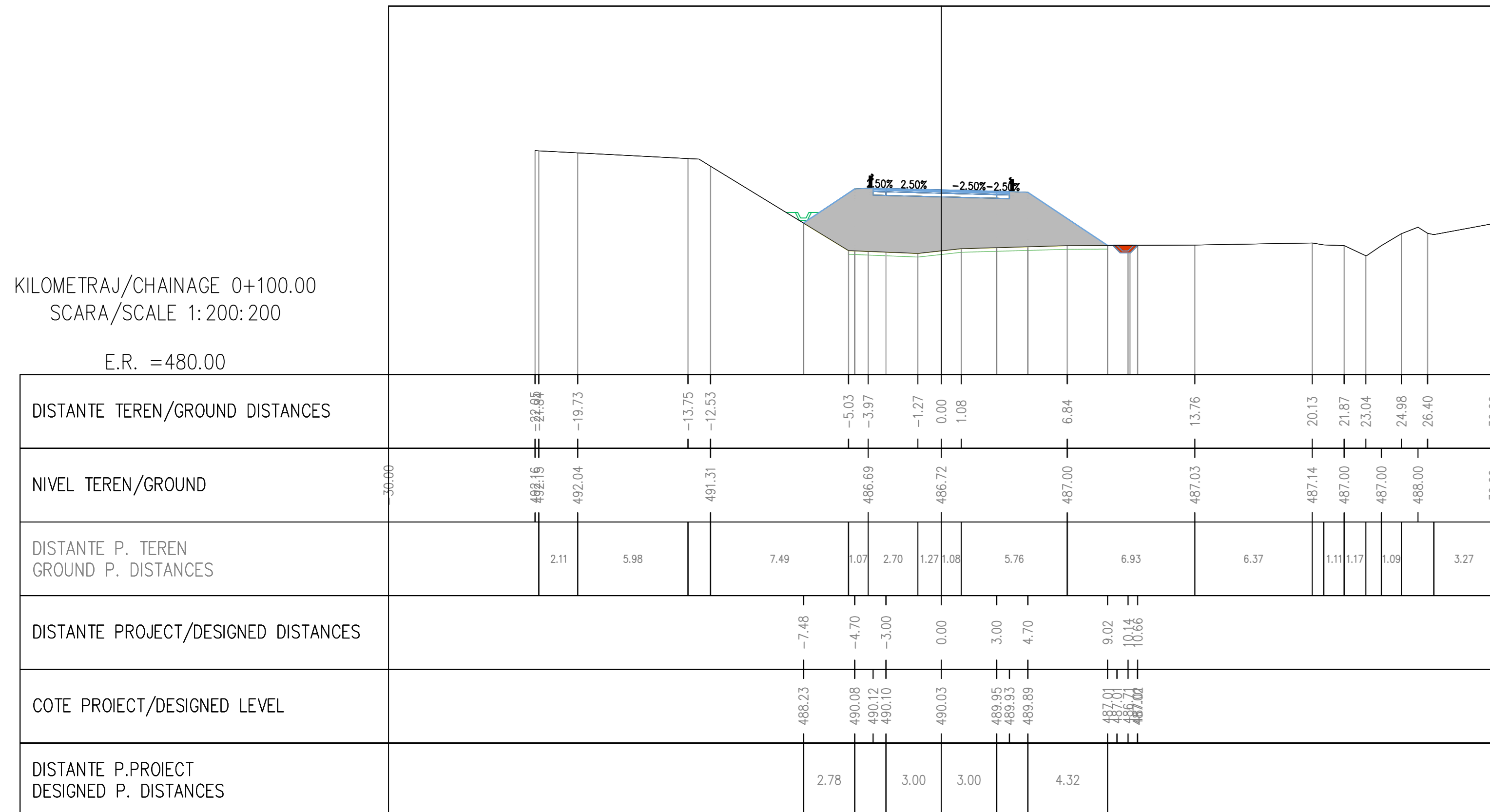

Total Volume at Station 0+100.00	
Cut Area	0.38
Fill Area	39.12
Cut Vol	20.00
Fill Vol	2003.63
Cum Cut Vol	97.35
Cum Fill Vol	3102.93
Net Vol	-3005.58

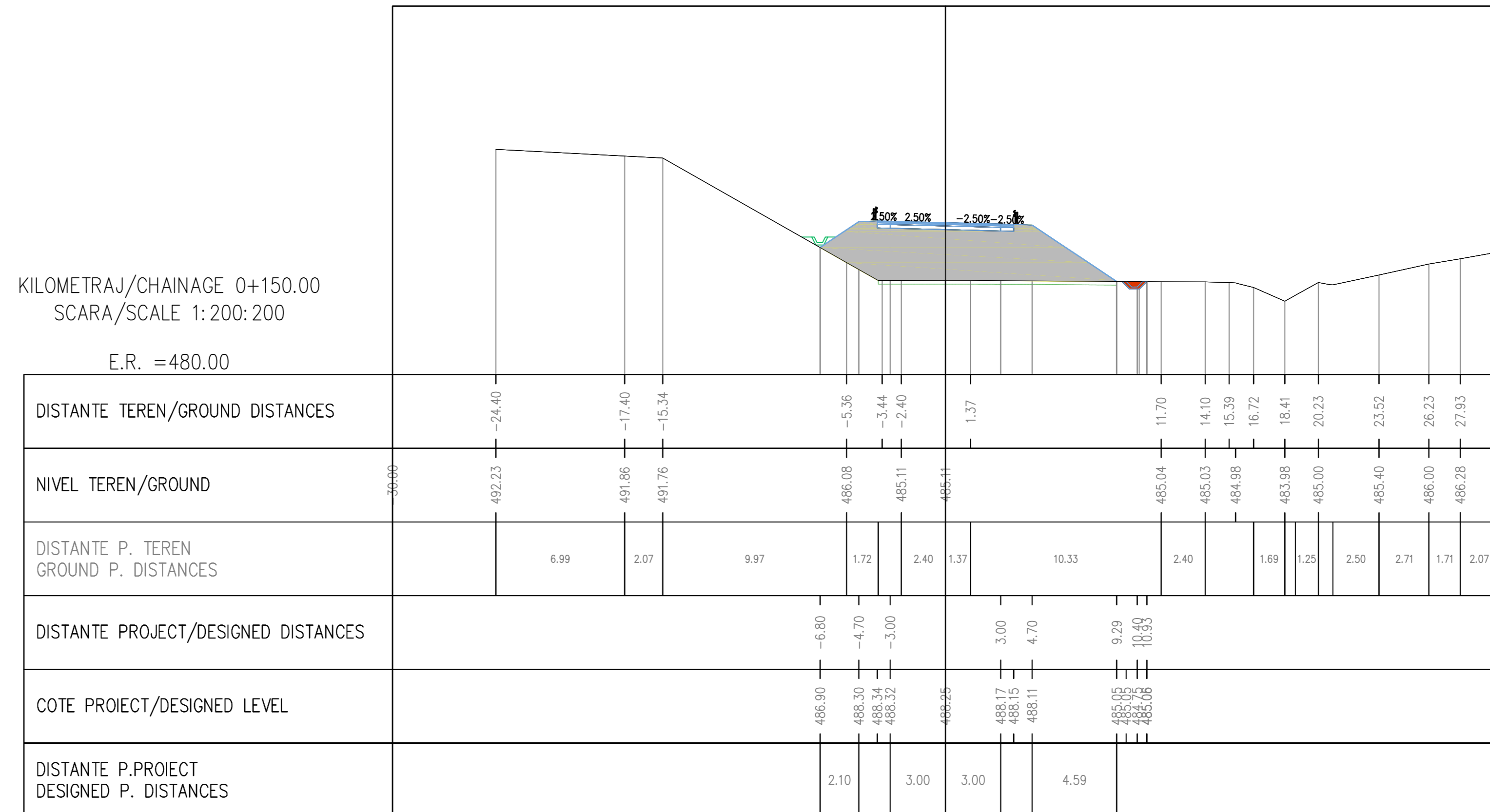

Total Volume at Station 0+150.00	
Cut Area	0.36
Fill Area	36.02
Cut Vol	18.55
Fill Vol	1878.51
Cum Cut Vol	115.91
Cum Fill Vol	4981.44
Net Vol	-4865.53

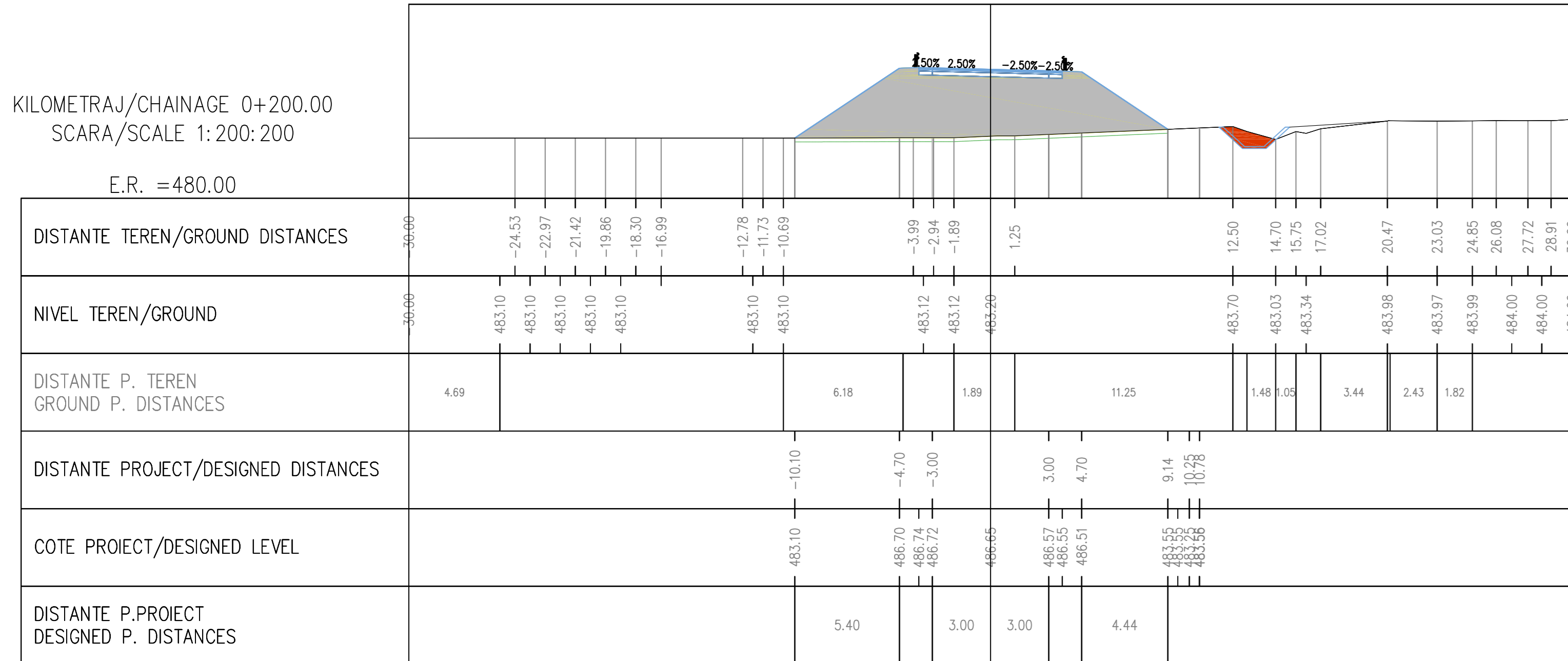

Total Volume at Station 0+200.00	
Cut Area	0.43
Fill Area	46.19
Cut Vol	19.83
Fill Vol	2055.30
Cum Cut Vol	135.73
Cum Fill Vol	7036.74
Net Vol	-6901.01

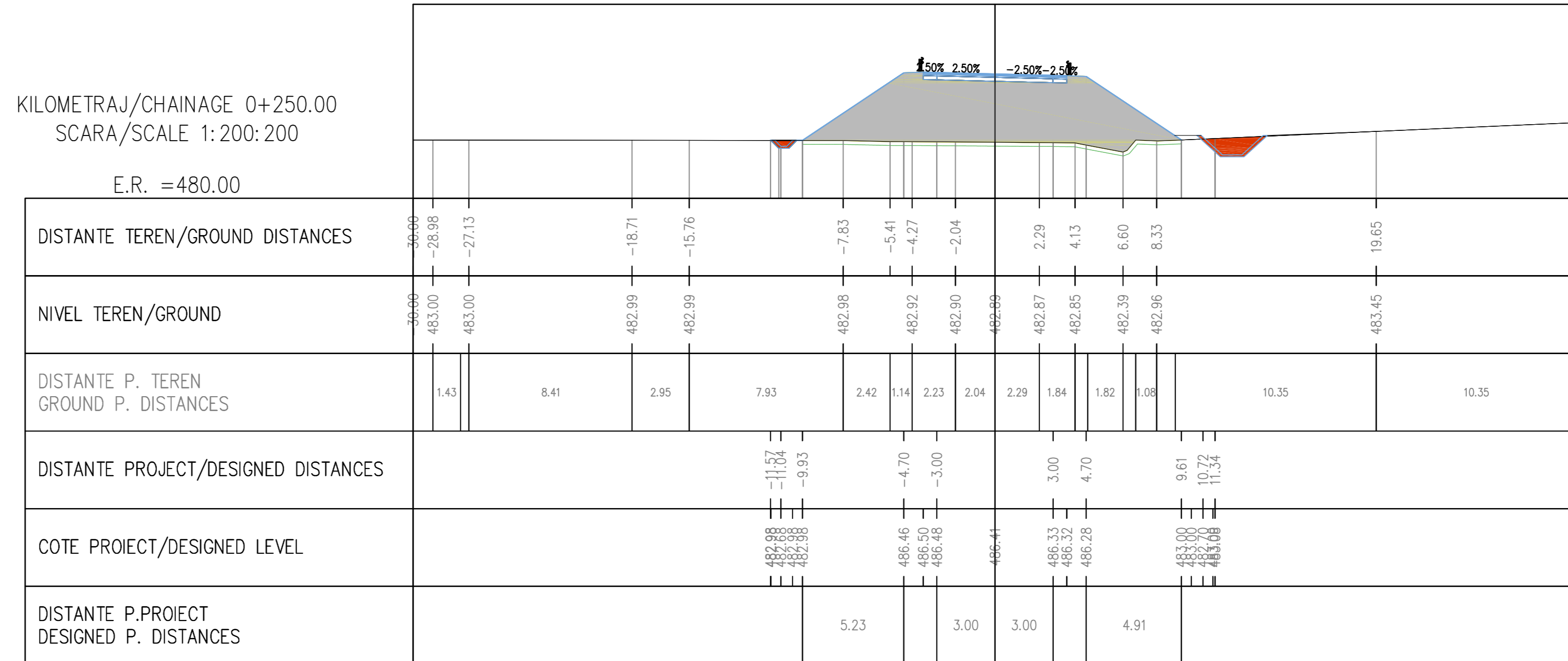

Total Volume at Station 0+250.00	
Cut Area	0.81
Fill Area	48.70
Cut Vol	30.98
Fill Vol	2372.30
Cum Cut Vol	166.71
Cum Fill Vol	9409.04
Net Vol	-9242.33

Legenda/ Legend

Total Volume at Station- Volumul total in locatie
 Cut Area- Aria debleului
 Fill Area- Aria rambleului
 Cut Vol- Volumul debleului
 Fill Vol- Volumul rambleului
 Cum Cut Vol- Suma volumelor debleului
 Cum Fill Vol- Suma volumelor rambleului
 Net Vol- Volumul net

D					
C					
B					
A					
Index	Date	Modificari	Proiectant	Approbat	Consultant
Index	Date	Modificari	Designer	Approved	Consultant
			C.N.C.F. "C.F.R." - S.A.		
CLIENT / CLIENT					
CONSULTANT / CONSULTANT					
Approved	Project manager				
Approved	Coordinator Sectiune 1				
Approved	Sectiune 1 Coordinator				
Verificat	Tunnel Expert				
Checkat	Tunnel Expert				
Intocmit	Projectant				
Elaborat	Designer				
SUBCONSULTANT / SUBCONSULTANT					
Approved	Responsabil Subconsultant				
Approved	Subconsultant Responsible				
Intocmit	Designer				
Elaborat	Designer				
Reabilitarea liniei de cale ferata Brasov - Simeria, parte componenta a coridorului IV Pan European, pentru circulatia trenurilor cu viteza maxima de 160 km/h. Sectiune 1 Brasov - Sighisoara					
Rehabilitation of the railway line Brasov - Simeria, component Part of the IV Pan-European Corridor, for the trains circulation with maximum speed of 160 km/h. Section 1 Brasov - Sighisoara					
Denumire desen / Drawing Title : TUNELUL ORMENIS/ ORMENIS TUNNEL ZONA ASPIRE ORMENIS/ ENTRANCE ORMENIS SIDE Drum de acces la zona de siguranta - Profilul transversale - km 0+000 - km 0+250 Access road to the safety area - Cross Sections - km 0+000 - km 0+250					
Codificarea / Codification System					
				Scara / Scale	Nr. / No
				1:200	01 / 39
E A S 1 0 1 C 1 0 T S G A 0 1 0 0 0 0 9 0					