

ARMARE PILOT - PILE REINFORCEMENT
Ø1.20m L=15.00m
Sc 1:50

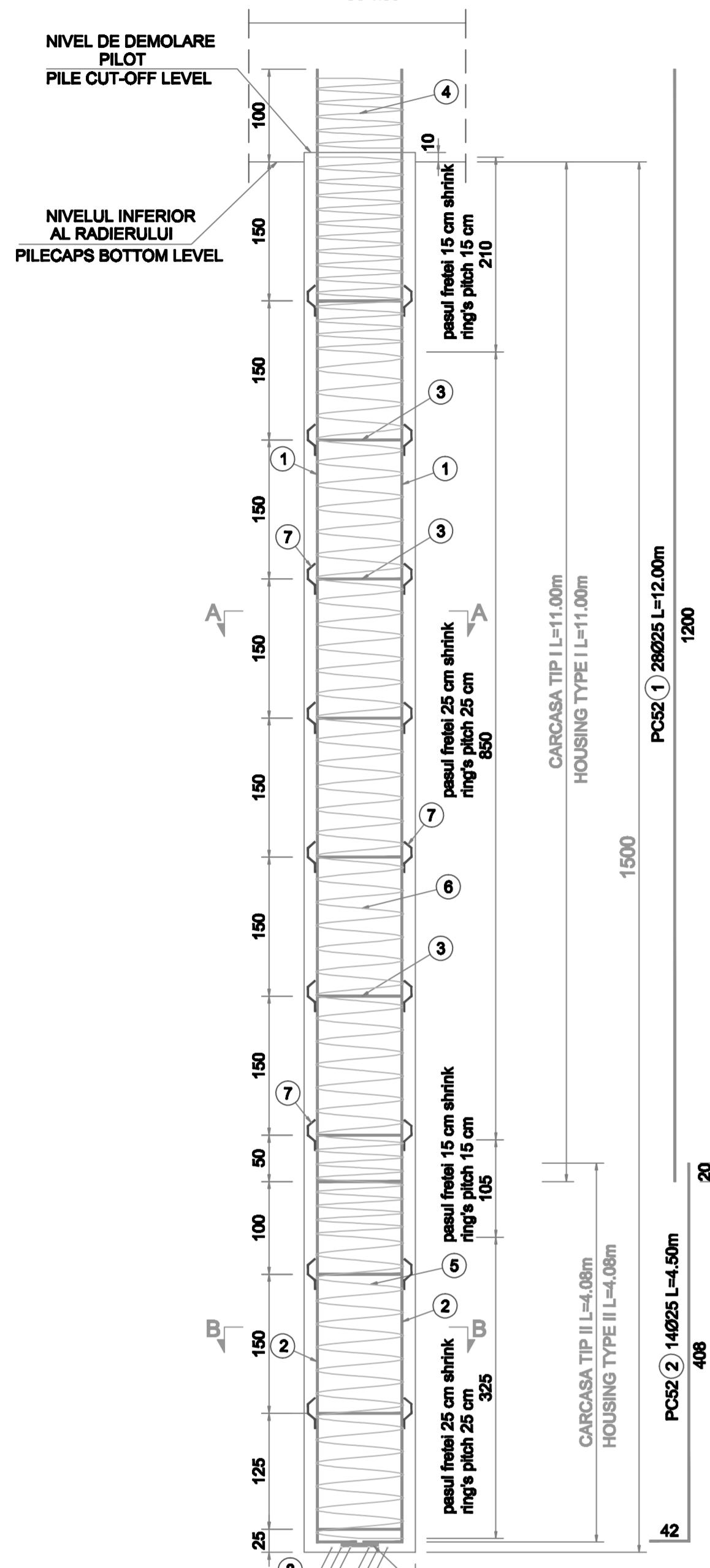

OB37 (6) Freta 1Ø10 L=165.70m
Shrink ring
(Vezi nota 1 - See note 1)

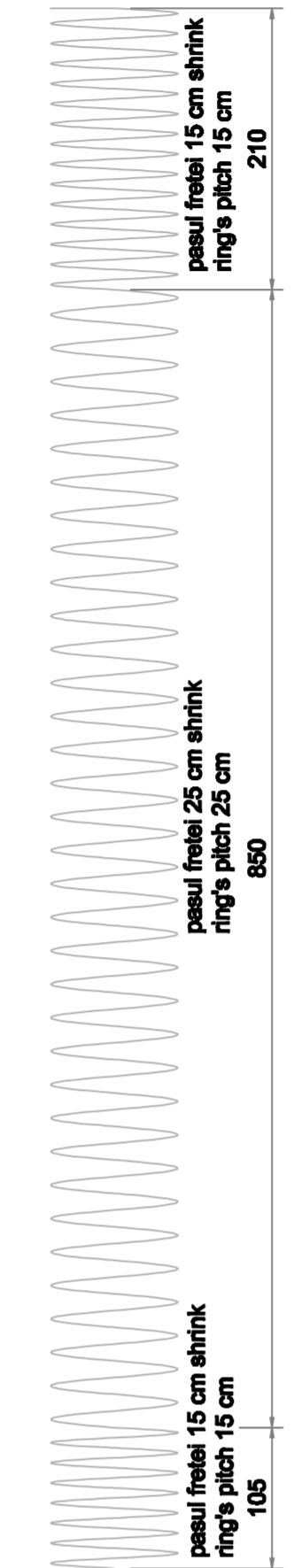

OB37 (4) Freta 1Ø10 L=15.80m
Shrink ring

Frete va fi montata odata cu armatura din radier
Shall be placed during pile cap reinforcement erection



Frete va fi montata odata cu armatura din radier
Shall be placed during pile cap reinforcement erection



Frete va fi montata odata cu armatura din radier
Shall be placed during pile cap reinforcement erection



Frete va fi montata odata cu armatura din radier
Shall be placed during pile cap reinforcement erection



Frete va fi montata odata cu armatura din radier
Shall be placed during pile cap reinforcement erection



Frete va fi montata odata cu armatura din radier
Shall be placed during pile cap reinforcement erection



Frete va fi montata odata cu armatura din radier
Shall be placed during pile cap reinforcement erection



Frete va fi montata odata cu armatura din radier
Shall be placed during pile cap reinforcement erection



Frete va fi montata odata cu armatura din radier
Shall be placed during pile cap reinforcement erection



Frete va fi montata odata cu armatura din radier
Shall be placed during pile cap reinforcement erection



Frete va fi montata odata cu armatura din radier
Shall be placed during pile cap reinforcement erection



Frete va fi montata odata cu armatura din radier
Shall be placed during pile cap reinforcement erection



Frete va fi montata odata cu armatura din radier
Shall be placed during pile cap reinforcement erection



Frete va fi montata odata cu armatura din radier
Shall be placed during pile cap reinforcement erection



Frete va fi montata odata cu armatura din radier
Shall be placed during pile cap reinforcement erection



Frete va fi montata odata cu armatura din radier
Shall be placed during pile cap reinforcement erection



Frete va fi montata odata cu armatura din radier
Shall be placed during pile cap reinforcement erection



Frete va fi montata odata cu armatura din radier
Shall be placed during pile cap reinforcement erection



Frete va fi montata odata cu armatura din radier
Shall be placed during pile cap reinforcement erection



DETALIU INNADIRE TRONSON FRETA
COIL SECTIONS JOINING DETAIL

Sc 1:50

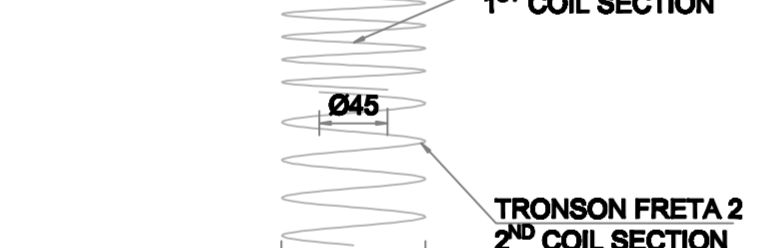

TRONSON FRETA 1
1st COIL SECTION

TRONSON FRETA 2
2nd COIL SECTION



TRONSON FRETA 1
1st COIL SECTION



TRONSON FRETA 2
2nd COIL SECTION



TRONSON FRETA 1
1st COIL SECTION



TRONSON FRETA 2
2nd COIL SECTION



TRONSON FRETA 1
1st COIL SECTION

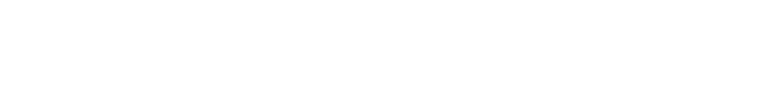

TRONSON FRETA 2
2nd COIL SECTION



TRONSON FRETA 1
1st COIL SECTION



SECTIUNE A-A
SECTION A-A
Sc 1:20

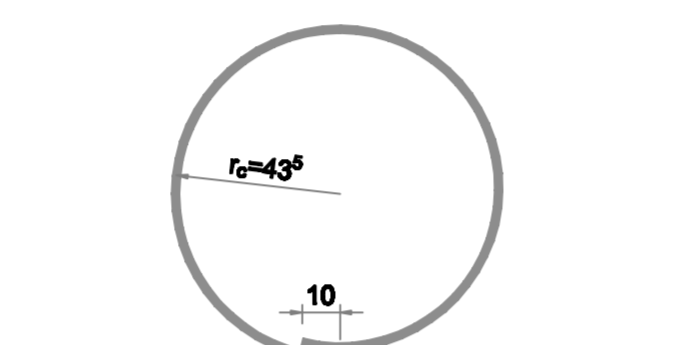
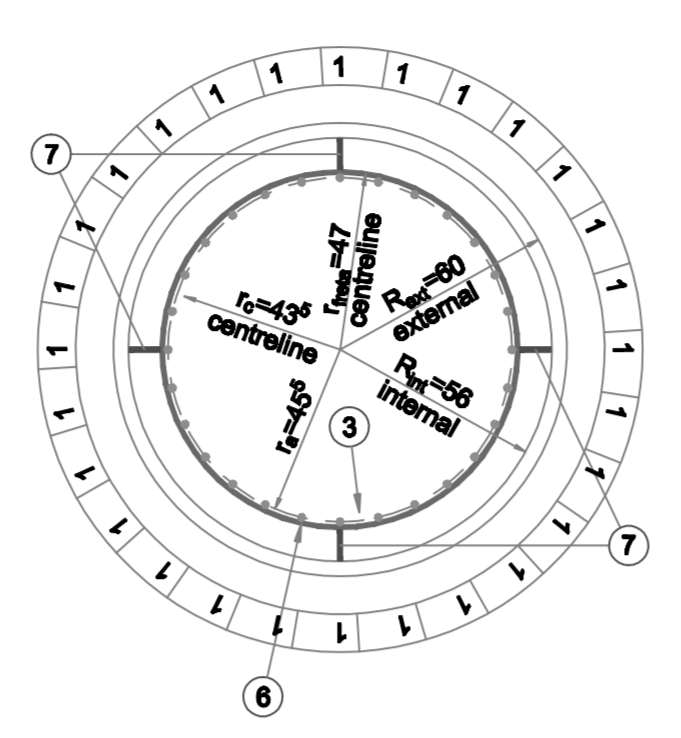

PC52 (3) Cerc de rigidizare Ø20 L=2.85m
Reinforcing ring

OB37 (7) Patina de ghidare Ø12 L=0.40m
Guide track
(Vezi nota 2 - See note 2)

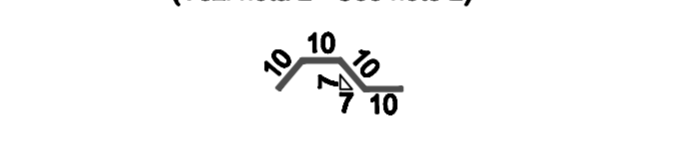

SECTIUNE B-B
SECTION B-B
Sc 1:20

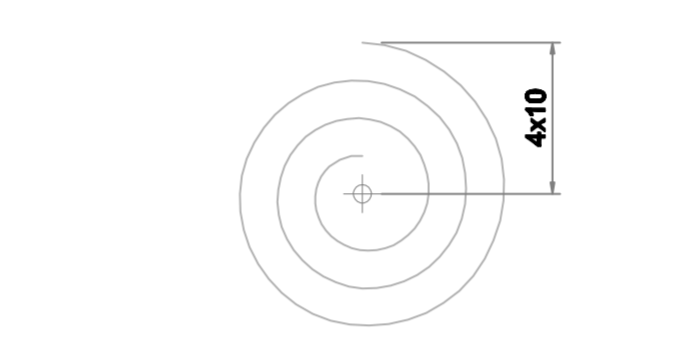
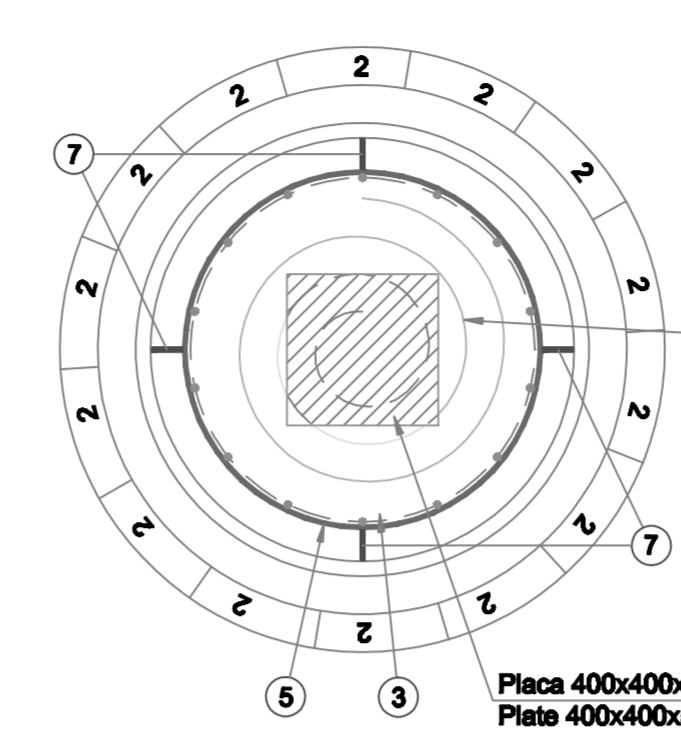

OB37 (8) Spirala 1Ø10 L=4.70m
Helicoidal reinforcement

Placa 400x400x5mm G=0.628kg
Plate 400x400x5, Weight=0.628



EXTRAS DE ARMATURA
REINFORCEMENT AMOUNT

MARCA	DIAMETRUL BAREI	NR. DE ELEMENTE	LUNGIMEA BAREI	OTEL			
				LUNGIMI / DIAMETRE	STEEL		
				PC52	OB37		
CARCASA TIP I - CAGE TYPE I							
1	25	28	1	28	12.00	336.0	
3	20	1	8	8	2.85	22.8	
4	10	1	1	1	15.80	15.8	
6	10	1	1	1	165.70	165.7	
7	12	1	28	28	0.40	11.2	
LUNGIMI TOTALE / METRU (m)				336.0	22.8	11.2	181.5
TOTAL LENGTH / METRE (m)				336.0	22.8	11.2	181.5
GREUTATE / METRU (kg/m)				3.850	2.466	0.888	0.617
WEIGHT / METRE (kg/m)				3.850	2.466	0.888	0.617
GREUTATE TOTALA / φ (kg)				1294	57	10	112
TOTAL WEIGHT / φ (kg)				1294	57	10	112
TOTAL (kg)				1351	122		
CARCASA TIP II - CAGE TYPE II							
2	25	14	1	14	4.50	63.0	
3	20	3	1	3	2.85	8.6	
5	10	1	1	1	40.35	40.4	
7	12	8	1	8	0.40	3.2	
8	10	1	1	1	4.70	4.7	
LUNGIMI TOTALE / METRU (m)				63.0	8.6	3.2	45.1
TOTAL LENGTH / METRE (m)				63.0	8.6	3.2	45.1
GREUTATE / METRU (kg/m)				3.850	2.466	0.888	0.617
WEIGHT / METRE (kg/m)				3.850	2.466	0.888	0.617
GREUTATE TOTALA / φ (kg)				243	22	3	28
TOTAL WEIGHT / φ (kg)				243	22	3	28
TOTAL (kg)				265	31		

NUMAR TOTAL DE PILOTI: (80 +2) bucati
TOTAL NUMBER OF PILES: (80+2) pieces
SE VOR EXECUTA 2 PILOTI DE PROBA
TEST PILES SHALL BE CARRIED OUT
WO 1.20m Ø
PC52 : 82 x 1616.00kg=132512.00kg
OB37 : 82 x 153.00kg=12546.00kg

DETALIU DE INADIRE
BARS WELDING DETAIL

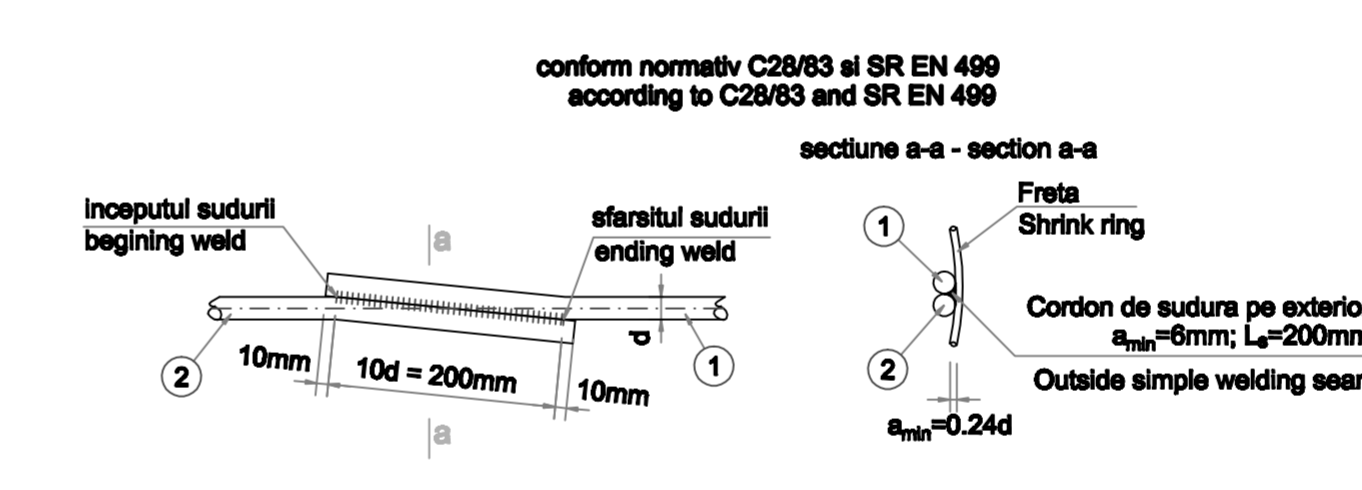

ELEMENTE CARACTERISTICE		Ø=1.20m
CHARACTERISTIC ELEMENTS		
r _{ext}	-raza tubaj exterior - pipe's external radius	60.00
r _{int}	-raza tubaj interior - pipe's internal radius	56.00
r _a	-raza dispunere armatura - reinforcement's arrangement radius	45.50
r _c	-raza cerc de rigidizare - reinforcing ring radius	43.50
r _f	-raza freta - shrink ring's radius	47.00

- NOTE
- FRETA SI CERURILE DE RIGIDIZARE SE VOR SUDA PRIN PUNCTE DE SUDURA PE ARMATURA DE REZISTENTA.
 - PATINELE DE GHIDARE SE SUDEAZA PE ARMATURA DE REZISTENTA PE AMBELE PARTI. PATINA DE GHIDARE (7) POATE FI INLOCUITA PRINTR-UN ALT DISPOZITIV PATENTAT.
 - INNADIREA CARCASELOR SE VA FACE PRIN SUDURA CONFORM DETALIULUI.
 - FRETA CARCASEI DE ARMATURA POATE FI EXECUTATA DIN TRONSOANE CU LUNGIMEA DE 1.00m CAND PASUL FRETEI ESTE DE 15cm RESPECTIV 2.00m CAND PASUL FRETEI ESTE DE 20-25cm. INNADIREA TRONSOANELOR SE VA FACE PRIN SUPRAPUNEREA BARELOR PE O LUNGIME 45 DIAMETRE CONFORM DETALIULUI DE INNADIRE FRETA.
 - BETON C20/25.
 - ACOPERIRE MINIMA 7.5cm.
 - PLACA METALICA 400x400x5mm SE VA SUDA DE ARMATURA IN SPIRALE MARCA (8) SITUATA LA PARTEA INFERIOARA A CARCASEI PENTRU A IMPIEDICA DEPLASAREA ACESTEIA.

- NOTES
- THE IRON HOOP AND THE STIFFENING RINGS SHALL BE FIXED BY WELDING SPOTS ON THE STRENGTH (MAIN) REINFORCEMENTS.
 - THE GUIDING SLIPPERS SHALL BE WELDED ON THE STRENGTH REINFORCEMENT ON BOTH SIDES. GUIDE TRAK (7) MAY BE SUBSTITUTED BY A PROPRIETARY GUIDE/COVER SPACER UNIT.
 - THE CASES BINDING SHALL BE EXECUTED ACCORDING TO THE WELDING DETAIL.
 - THE COIL CAN BE PERFORMED OF 1.00m WHEN THE COIL PITCH IS 15cm, RESPECTIVELY 2.00m LENGTH WHEN THE COIL PITCH IS 20-25cm. THE JOINING OF THE THE SECTIONS WILL BE DONE BY OVERLAPPING THE COIL BARS ON 45 DIAMETERS LENGTH IN ACCORDANCE WITH THE COIL JOINING DETAIL.
 - CONCRETE C20/25.
 - MINIMUM CONCRETE COVER 7.5cm.
 - THE METALLIC PLATE WILL BE WELDED AT THE BOTTOM REBAR CAGE MARK (8) TO RESTRICT PILE REBAR CAGE MOVEMENT WHILE PLACING PILE CONCRETE.

Indice	Data	Modificari	Proiectant	Aprobat	Consultant	Aprobat CFR
Index	Date	Modification/Revision	Designer	Approved	Consultant	Approved CFR
D						
C						
B						
A						

GUVERNUL ROMANIEI
ROMANIAN GOVERNMENT

PROIECT FINANȚAT DE UNIUNEA EUROPEANA
EUROPEAN UNION FINANCED PROJECT

CFR

C.N.C.F. "C.F.R." - S.A.

CLIENT / CLIENT

ITALFERR GRUPPO FERROVIE DELLO STATO
Scott Wilson
OBERMEYER PLANEN + BERATEN GmbH
TECNIC Consulting Engineers

CONSULTANT / CONSULTANT		Data	Semnatura
		Date	Signature
Aprobat	Self project	R. Liuzza	03.2012
Aprobat	Coordonator	C. Gambell	03.2012
Verificat	Expert	V. Kalidromitis	03.2012

SUBCONTRACTANT / SUBCONTRACTOR		Data	Semnatura
		Date	Signature
Aprobat	Responsabil	A. Dinulescu Stancu	03.2012
Intocmit	Proiectant	Ionela Ungureanu	03.2012

Reabilitarea liniei de cale ferata Braşov - Simeria, parte componentă a coridorului IV Pan European, pentru circulația trenurilor cu viteză maximă de 160 km/h,
Tronsoanelor : Braşov - Sighişoara
Rehabilitation of the railway line Braşov - Simeria, component Part of the IV Pan-European Corridor, for the trains circulation with maximum speed of 160 km/h,
Section : Braşov - Sighişoara

Project/Project
2004/RO/16/PA/003
Faza / Phase:
P.Th. / T.D.

Denumire desen / Drawing Title :
STATIA / STATION BOD
PAŞAJ SUPERIOR / OVER PASS - KM 182+913.85
PLAN ARMARE COLOANE L=15.00m / REINFORCEMENT COLUMNS PLAN L=15.00m

Codificare / Codification System	Scara / Scale	LOT / LOT	Nr. / No
	1:50		01/01

E A 5 1 0 1 E 0 5 B C P A 0 0 1 1 0 2 3 0