

**PANOU GARD DE PROTECTIE
PROTECTION FENCE PANNEL**
Sc. 1:20

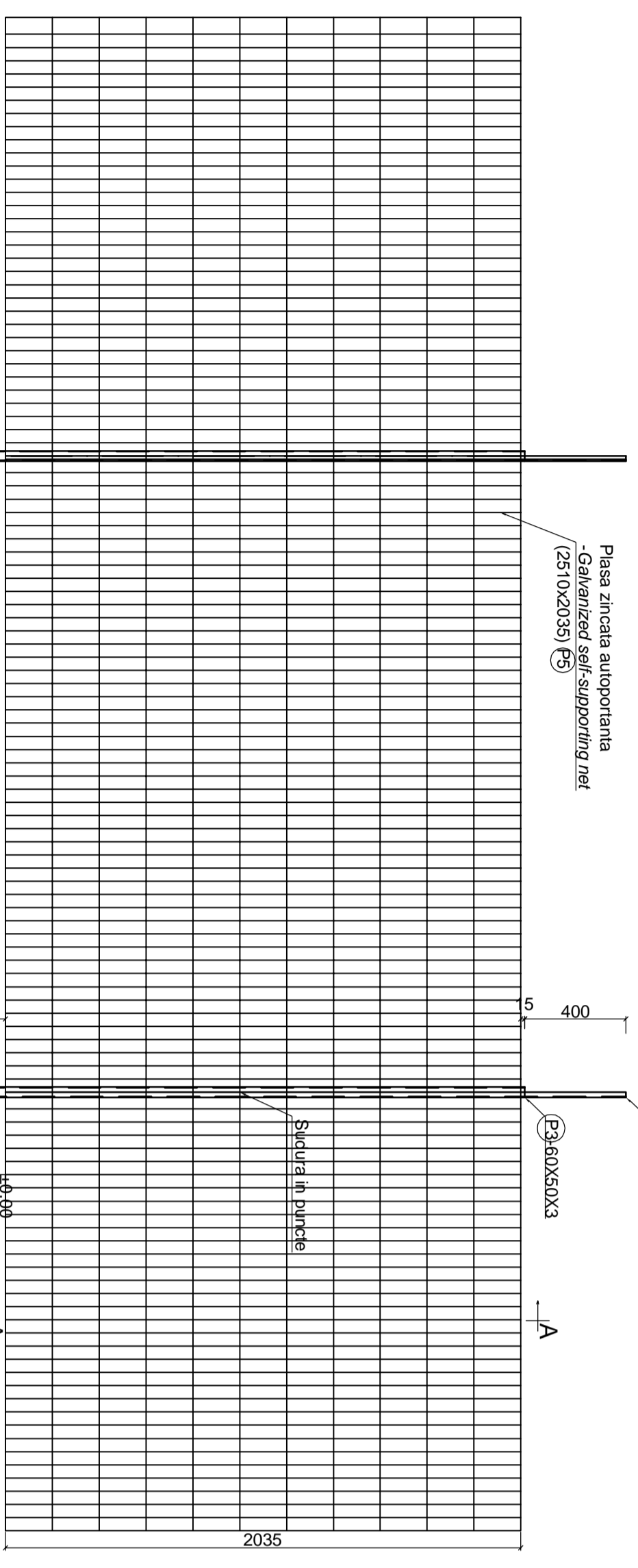

**STALP METALIC ZINCAT A-A
ZINC PLATED STEEL POLE**
Sc. 1:20

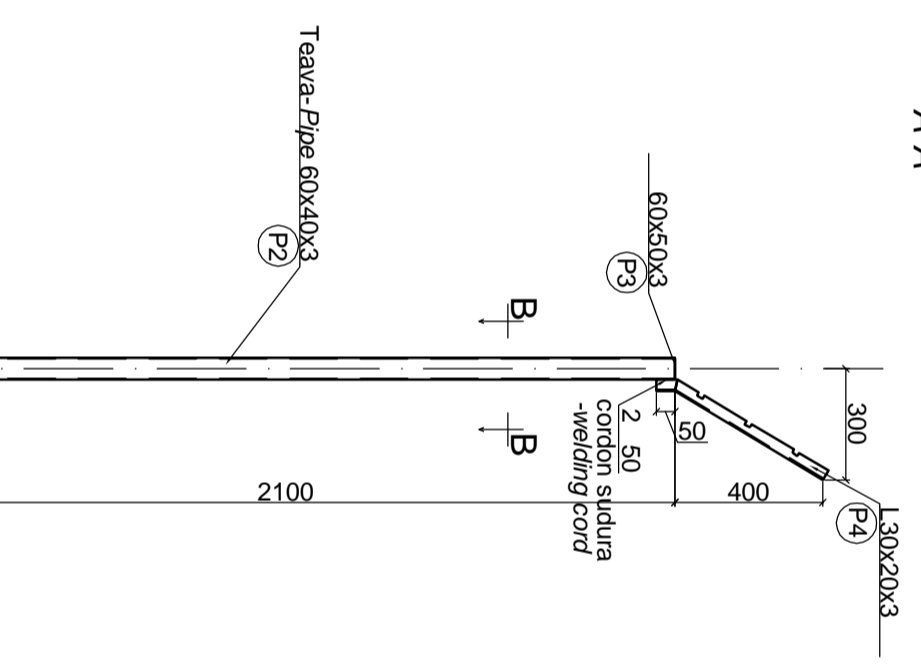

Nota:

Pentru montarea panourilor de plasa zincata autoportanta pe stalpi zincati se vor executa urmatoarele operati:
-prinderea prin sudura;
-protejarea sudurilor.
Stalpii de baza balast bine compactat min 10cm, pentru stabilirea nivelului controlat se va introduce o dala de baza 20x20x5cm pe care se reazama montanul.
Pentru stalpii de gard zincati montati in taluz se va avea in vedere ca fundatiile acestora sa fie inglobate complet in pamant.
Gardul de protectie va impiedica animale mari sa traverseze linia c.i., in zona arii protejate. Gardul va avea in partea superioara o arpa inclinata care sa impiedice escaladarea acestuia.

Note:

For the mounting of the Galvanized self-supporting net on the steel zinc plated poles the following will be done :
-fastening by welding;
-protection of the welding

The base ballast layer must be well compacted min 10cm. For establishing the right level a base concrete slab 20x20x5cm will be placed so that the steel pole can have a support. For the steel zinc plated poles mounted in slopes it must be taking into consideration that the foundations have to be completely covered in the ground .
The protection fence will prevent big animals from crossing the railway tracks near the secured zone. The superior part of the fence will have a angled wing to stumble its escalation.

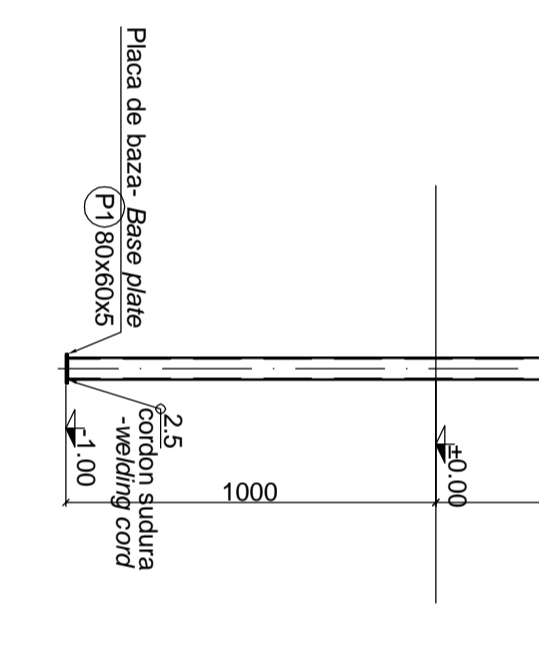
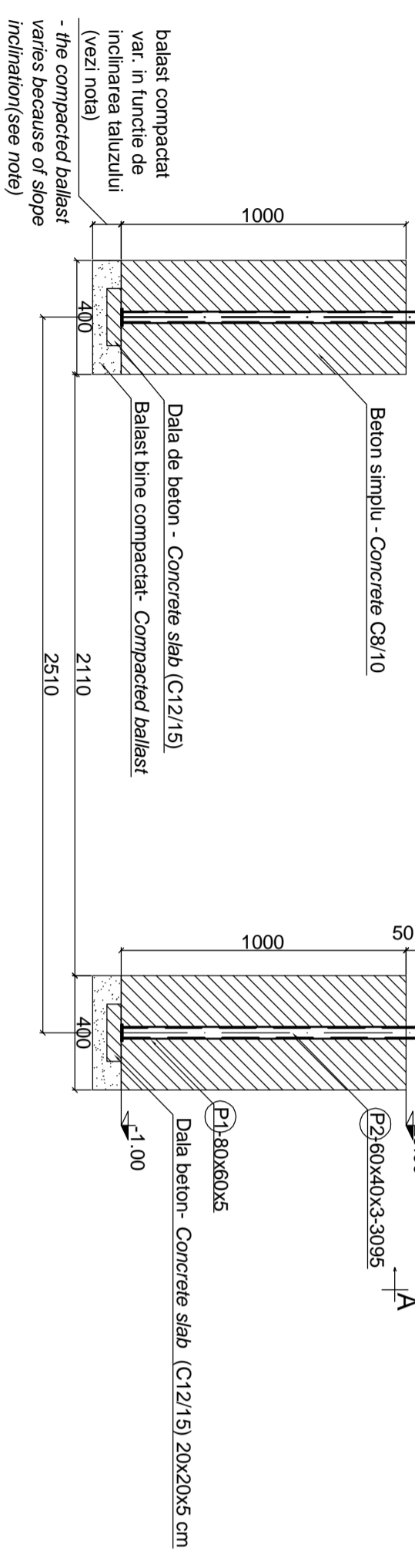

P4- 2L30X20X3-530
Sc.1:10

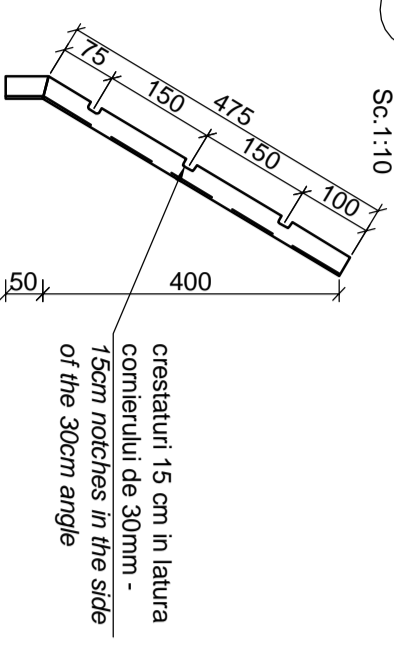

**Sectione B-B
- B-B Section**
sc. 1:5

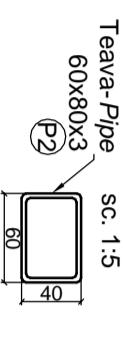

**Vedere in plan fundatie -
Plan view fondation**
Sc. 1:20

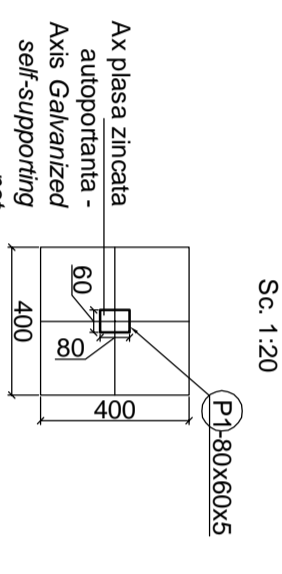

Pozitie	Denumire	Seciune	Lungime	Suprafata	Gratificati
1	2L30X20X3-530	00,2	30,65	1,132	14,44
2	60X80X3	00,10	3,65	0,365	1,132
3	60X80X3	00,10	3,65	0,365	1,132
4	60X80X3	00,10	3,65	0,365	1,132
5	60X80X3	00,10	3,65	0,365	1,132

Materiale - Materials:
OTEL - STEEL O137-2n/S235JR
Beton simplu- Concrete C8/10
Beton pentru dala - Concrete for slab C12/15

Categoria de importanta- "C" normala, conf HG-766/1997 -
Importance category- "C" normal, according to HG-766/1997
Clasa de importanta- IV- conf P100-2006 -
Importance class - IV - according to P100-2006
TC=139C; 9E=0,24g

Index	Data	Modificari/Revision	Proiectant Designer	Approbat Consultant	Approbat CFR
D					
C					
B					
A					

GUVERNUL ROMANIEI **PROIECT FINANȚAT DE UNIUNEA EUROPEANĂ**
ROMANIAN GOVERNMENT **EUROPEAN UNION FINANCED PROJECT**



CLIENT / CLIENT
ITALFERA **Scot Wilson** **OBERMEYER** **TECNIC**
GRUPU FERROVIE DELLO STATO **RAEN + BERATEN GmbH** **Consulting Engineers**
Joint Venture leader

Approbat	Responsabil	Data	Signature
Approbat	Project manager	12.2011	
Approbat	Coordinator Section 1	12.2011	
Verificat	Section 1 Coordinator	12.2011	
Verificat	Verifier	12.2011	

SUBCONTRACTANT / SUBCONTRACTOR

Approbat	Responsabil	Data	Signature
Approbat	Subcontractant Responsible	12.2011	
Inlocuit	Designer	12.2011	

Reabilitarea liniei de cale ferata Brasov - Simeria, parte componentă a coridorului IV Pan European, pentru circulatia trenurilor cu viteza maximă de 160 km/h,
Tomsomul : Brasov - Sighisoara
Rehabilitation of the railway line Brasov - Simeria, component Part of the IV Pan-European Corridor, for the trains circulation with maximum speed of 160 km/h,
Section : Brasov - Sighisoara

Denumire desen / Drawing Title : **GARD DE PROTECTIE (MEDIU)**
PROTECTION FENCE (ENVIRONMENT)

Codificare / Codification System	Scara / Scale	LOT / LOT	Nr. / No
E A S I	1:20		01/01