

KM.315+000.00
SEC. 243

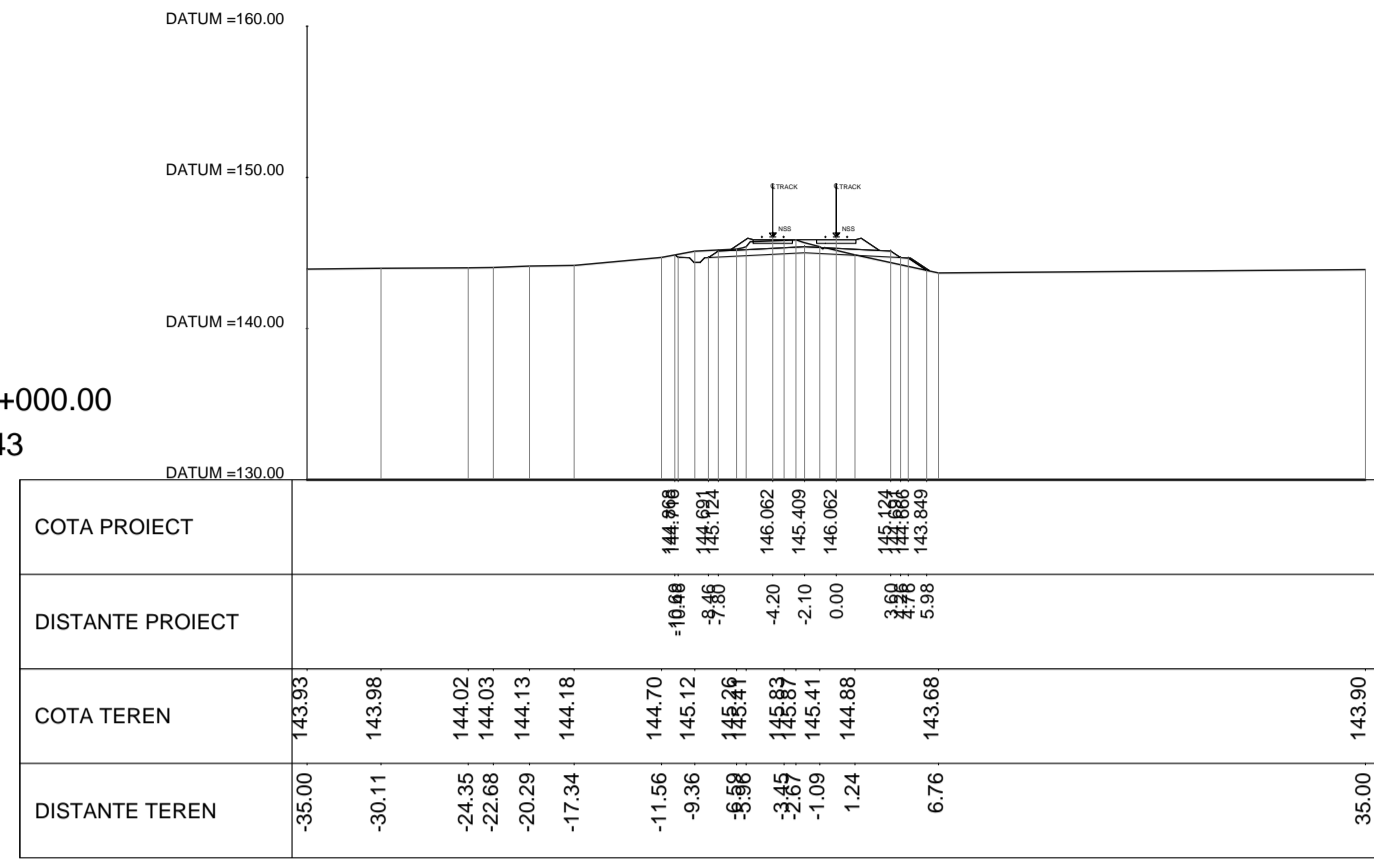

KM.315+200.00
SEC. 244

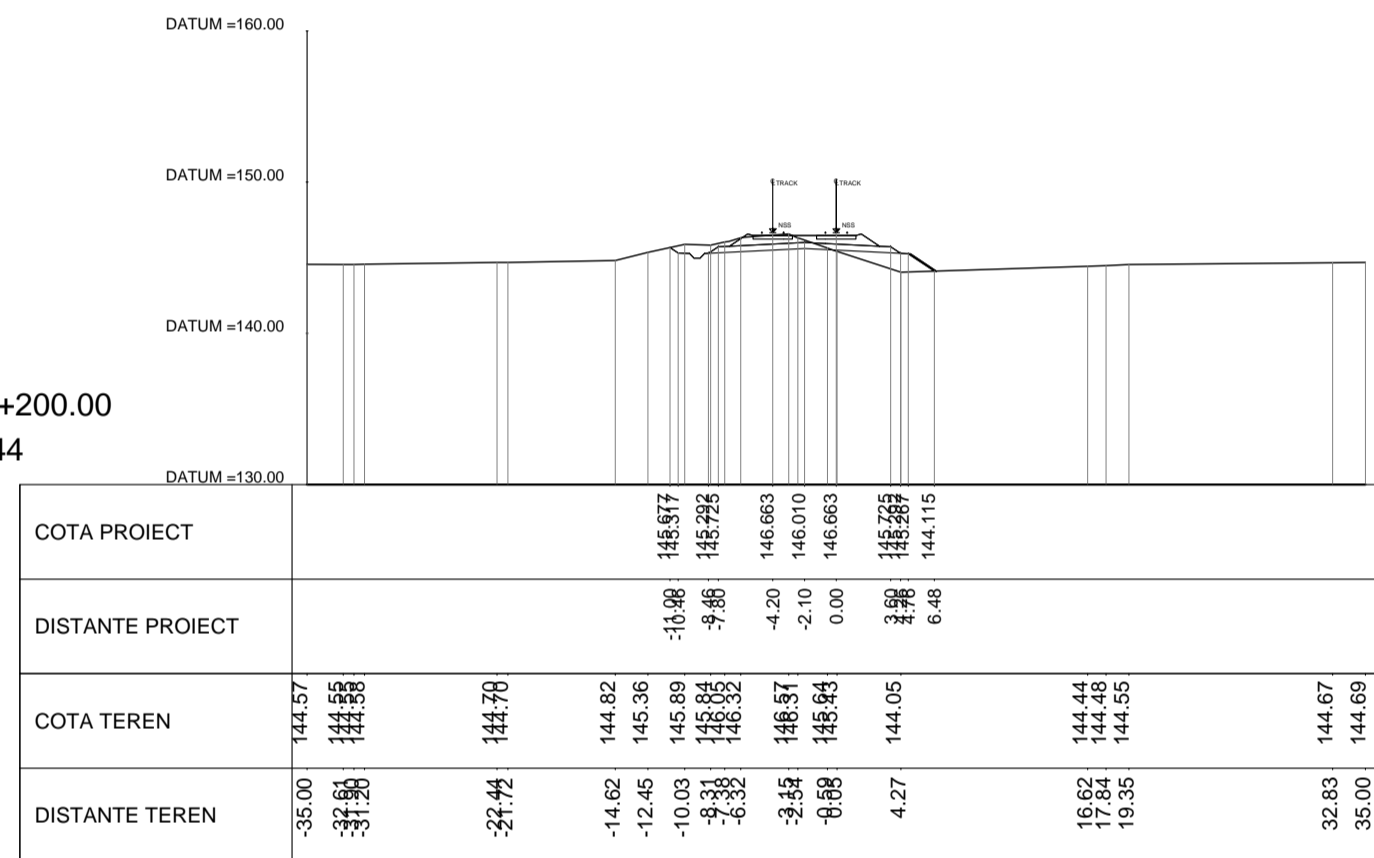

KM.315+400.00
SEC. 245

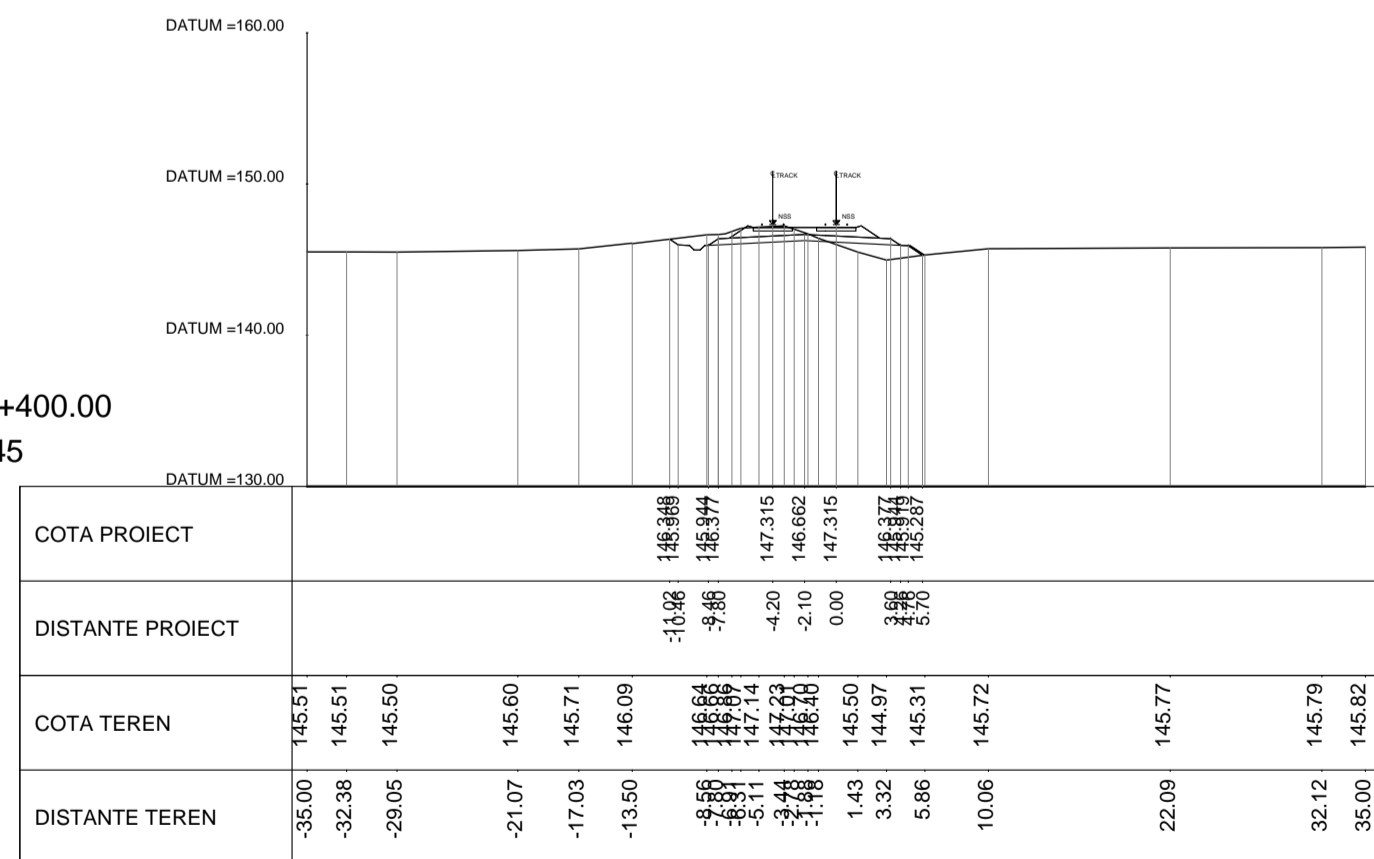

KM.315+600.00
SEC. 246

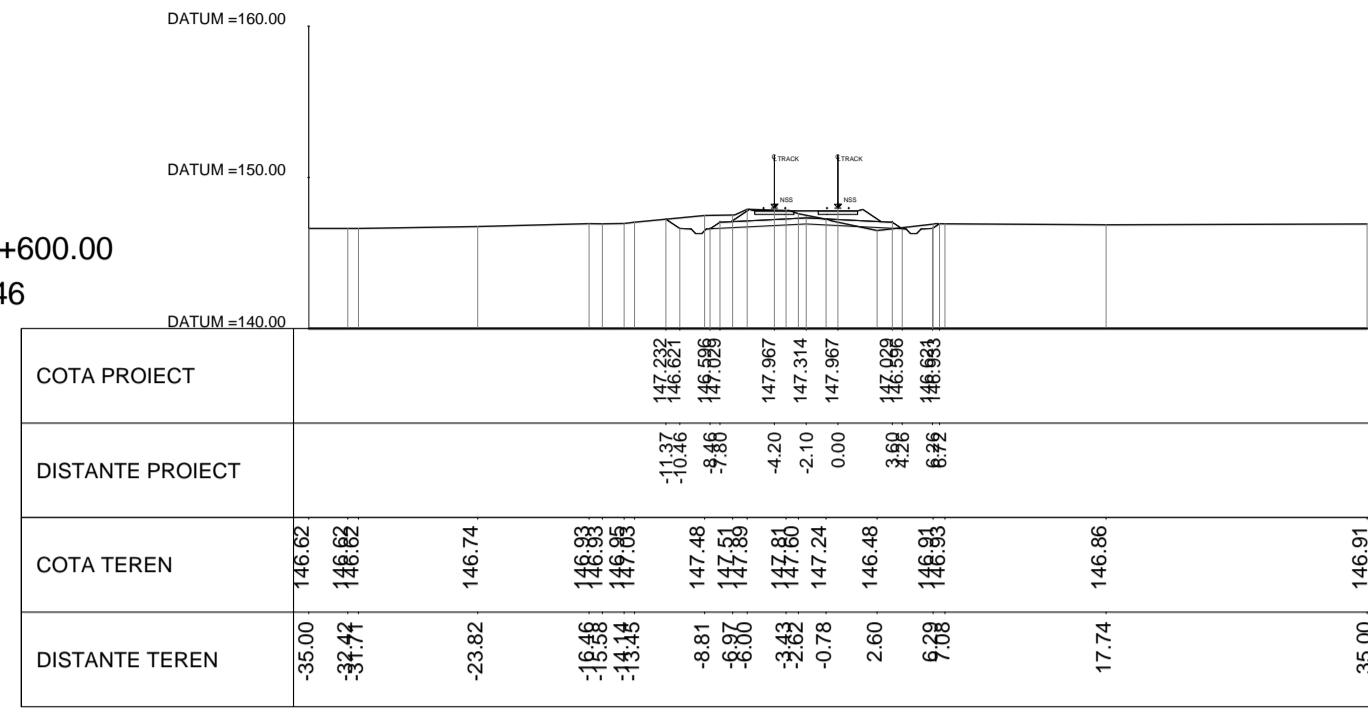

KM.315+800.00
SEC. 247

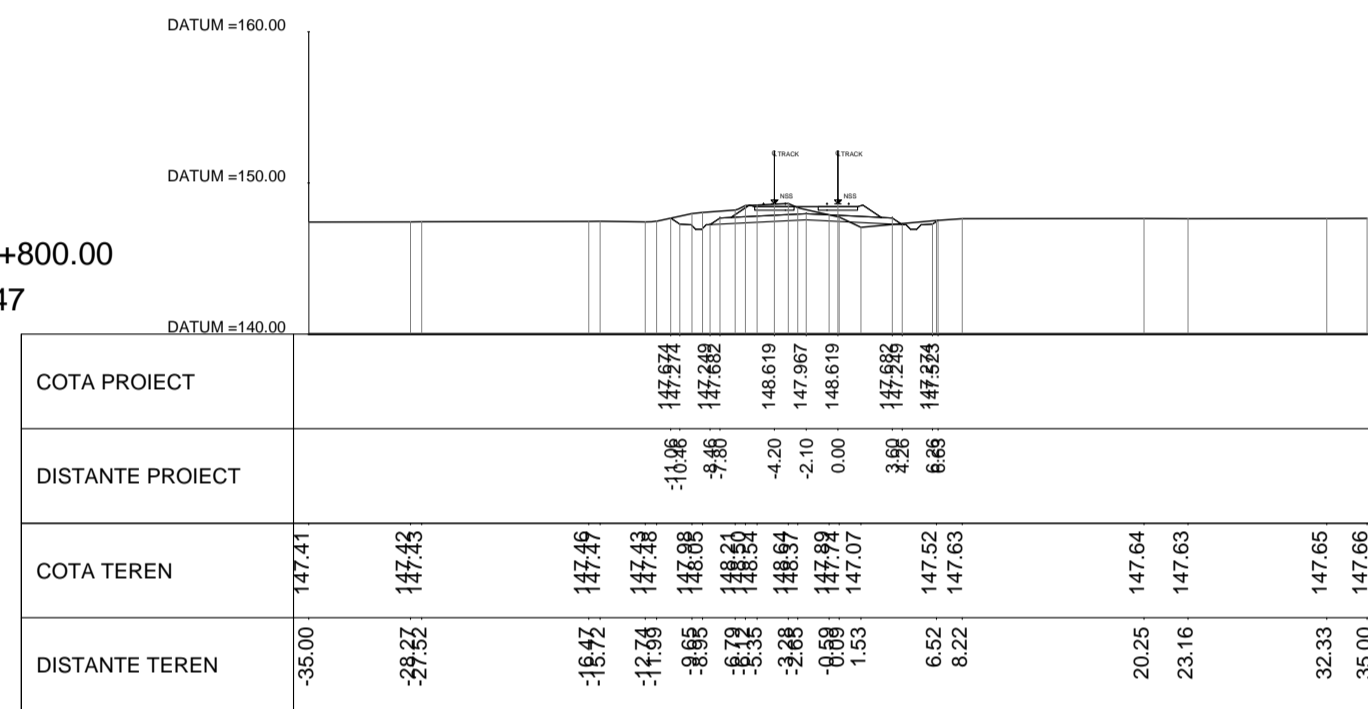

KM.316+000.00
SEC. 248

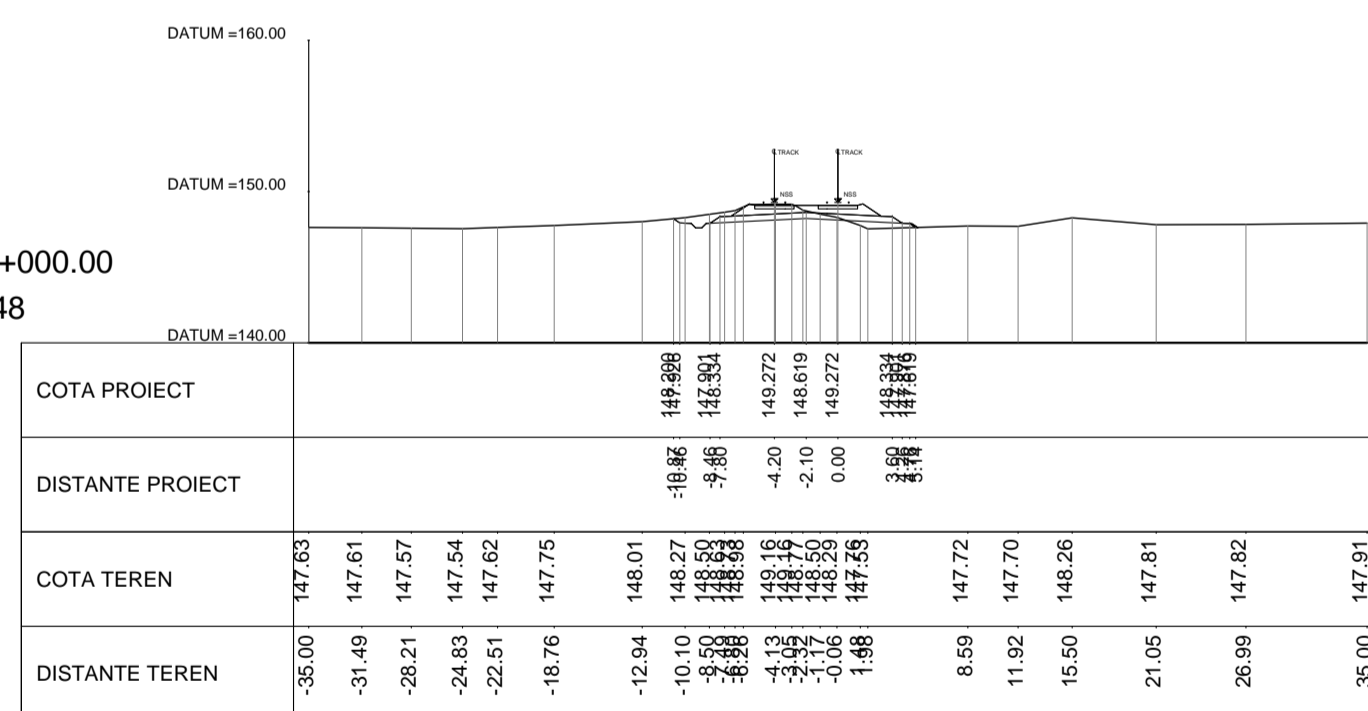

KM.316+200.00
SEC. 249

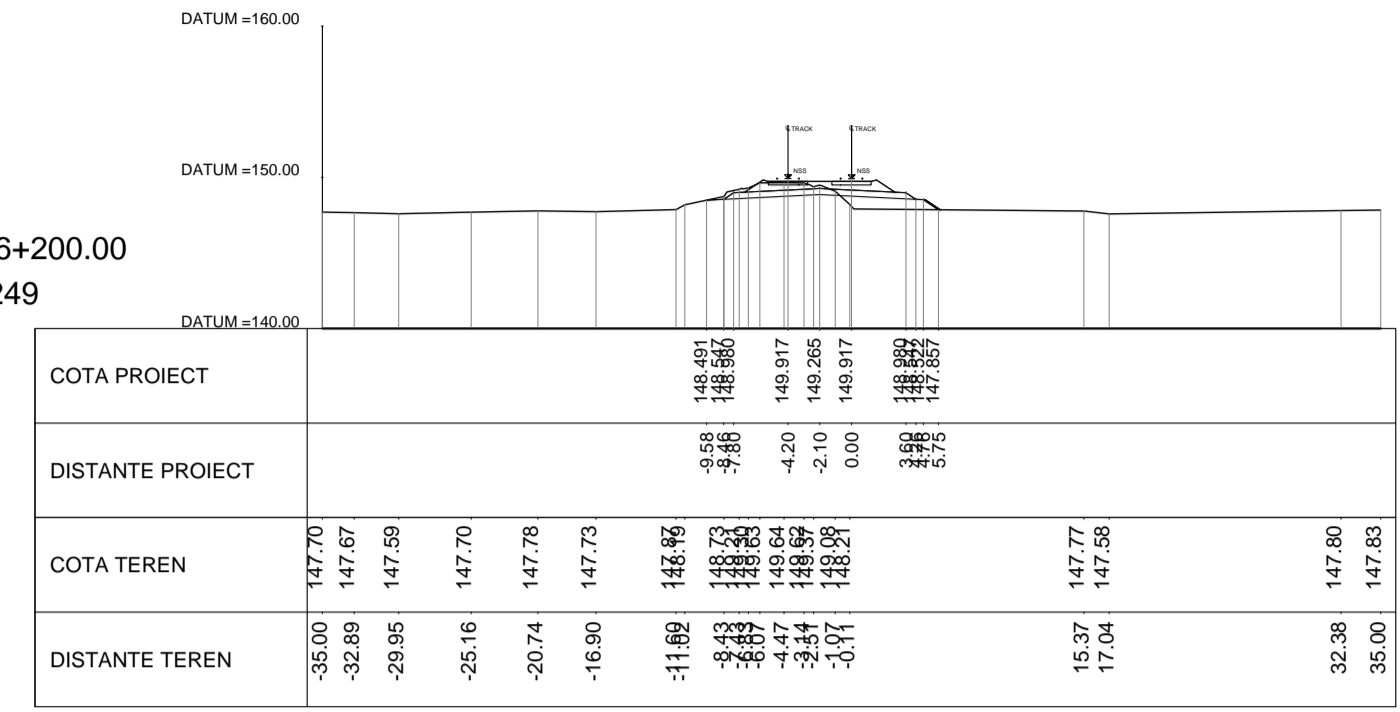

KM.316+400.00
SEC. 250

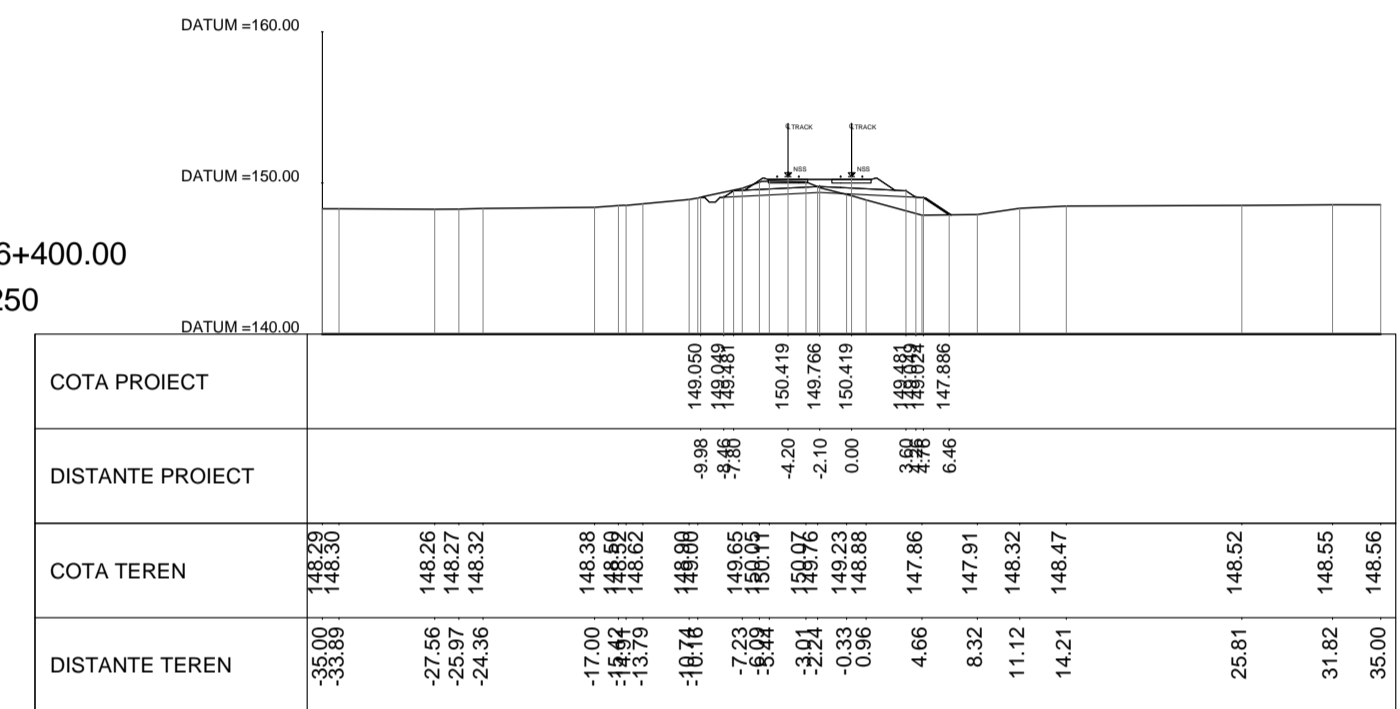

KM.316+600.00
SEC. 251

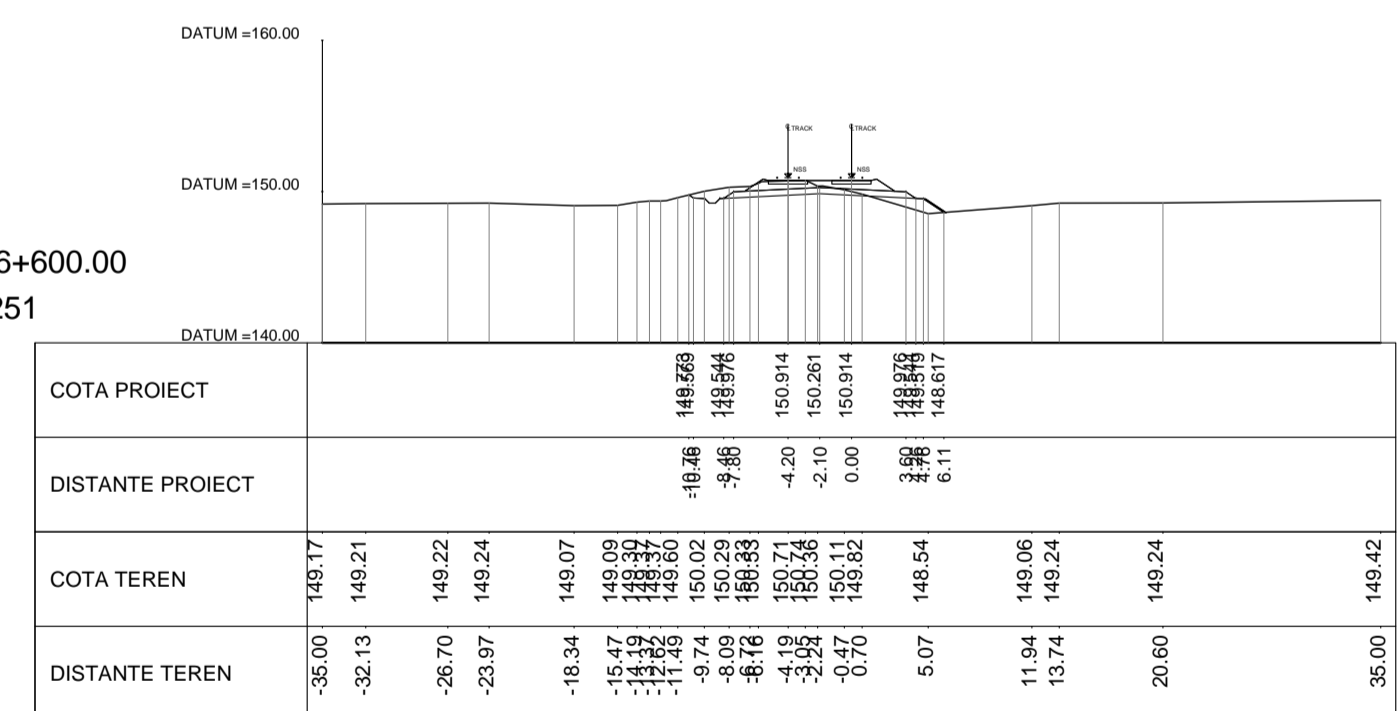

REV.	DATA/DATE	DESCRIERE MODIFICARE / MODIFICATION DESCRIPTION
A	Mai 2020	Prima ediție SFF / FFS First submission
B	Sept 2020	Conform solicitărilor Beneficiarului din act nr.11/2/504/2020
C		
D		

FAZA PHASE	NUME NAME	SEMNAȚURA SIGNATURE
APROBAT APPROVED	S. Menichini	
VERIFICAT CHECKED	S. Menichini	
INTOCMIT ELABORATED	F. Sorge	

STUDIU DE FEZABILITATE PENTRU REABILITARE A LINIEI FERROVIARE CRAIOVA - CARANSEBES / FEASIBILITY STUDY FOR THE REHABILITATION OF THE RAILWAY LINE CRAIOVA - CARANSEBES

DENUMIRE / TITLE:
Profil Transversal km 315+000 - km 316+600 - 28 din 100
Cross Sections km 315+000 - km 316+600 - 28 of 100

CODIFICARE / CODIFICATION SYSTEM:
 E218 0 SF 00 W8 AL 0 06 028 B