

KM.395+600.00
SEC. 550

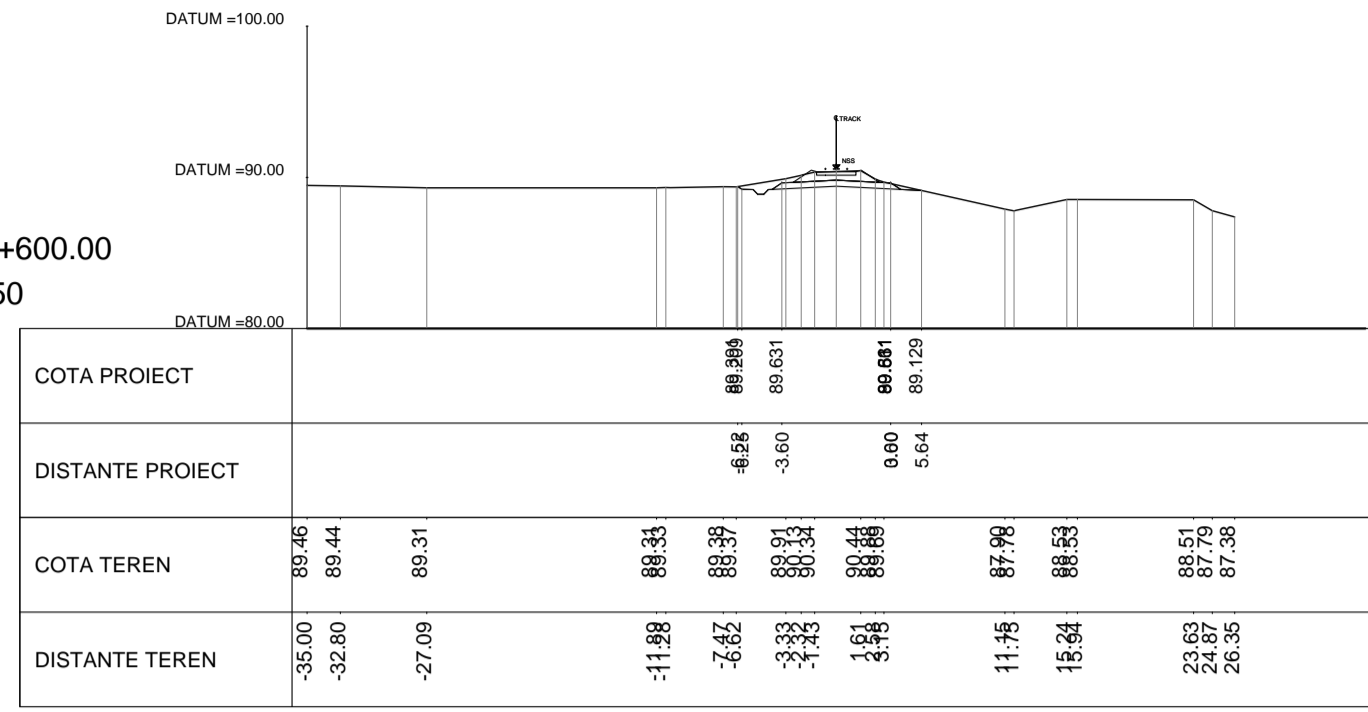

KM.395+800.00
SEC. 551

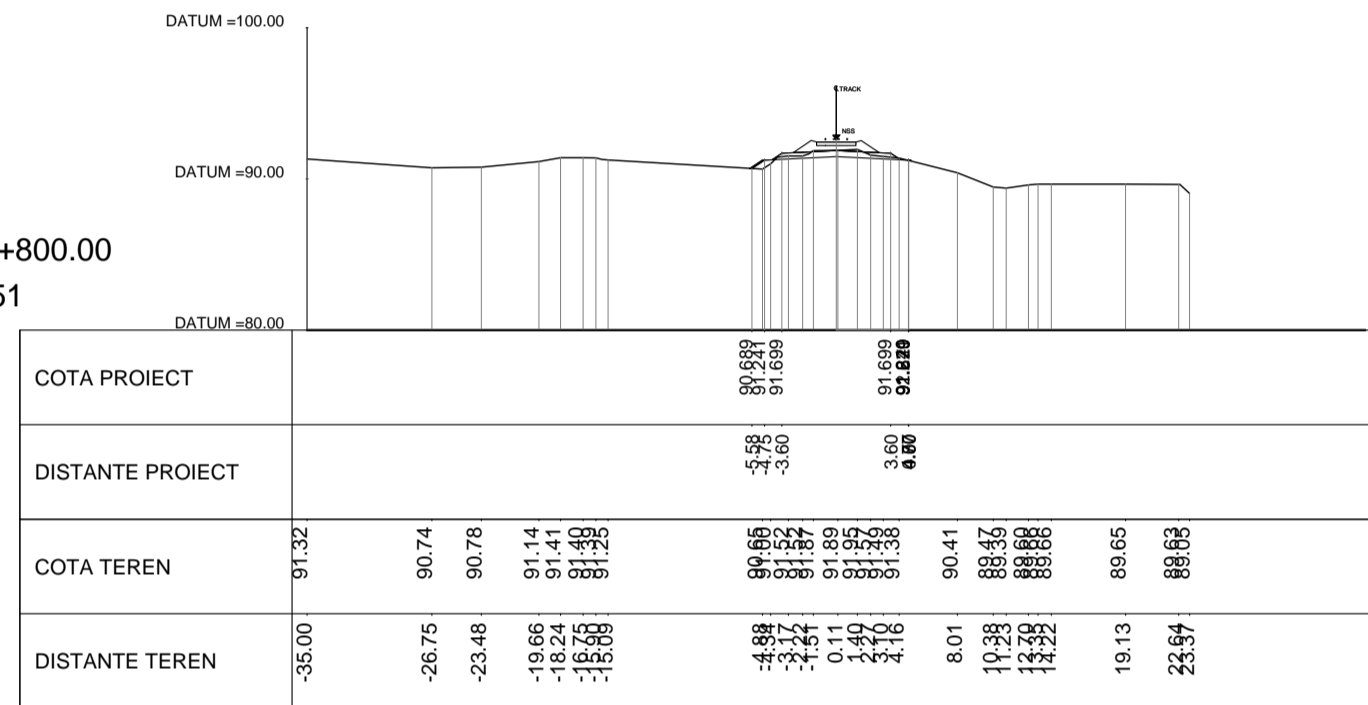

KM.396+000.00
SEC. 552

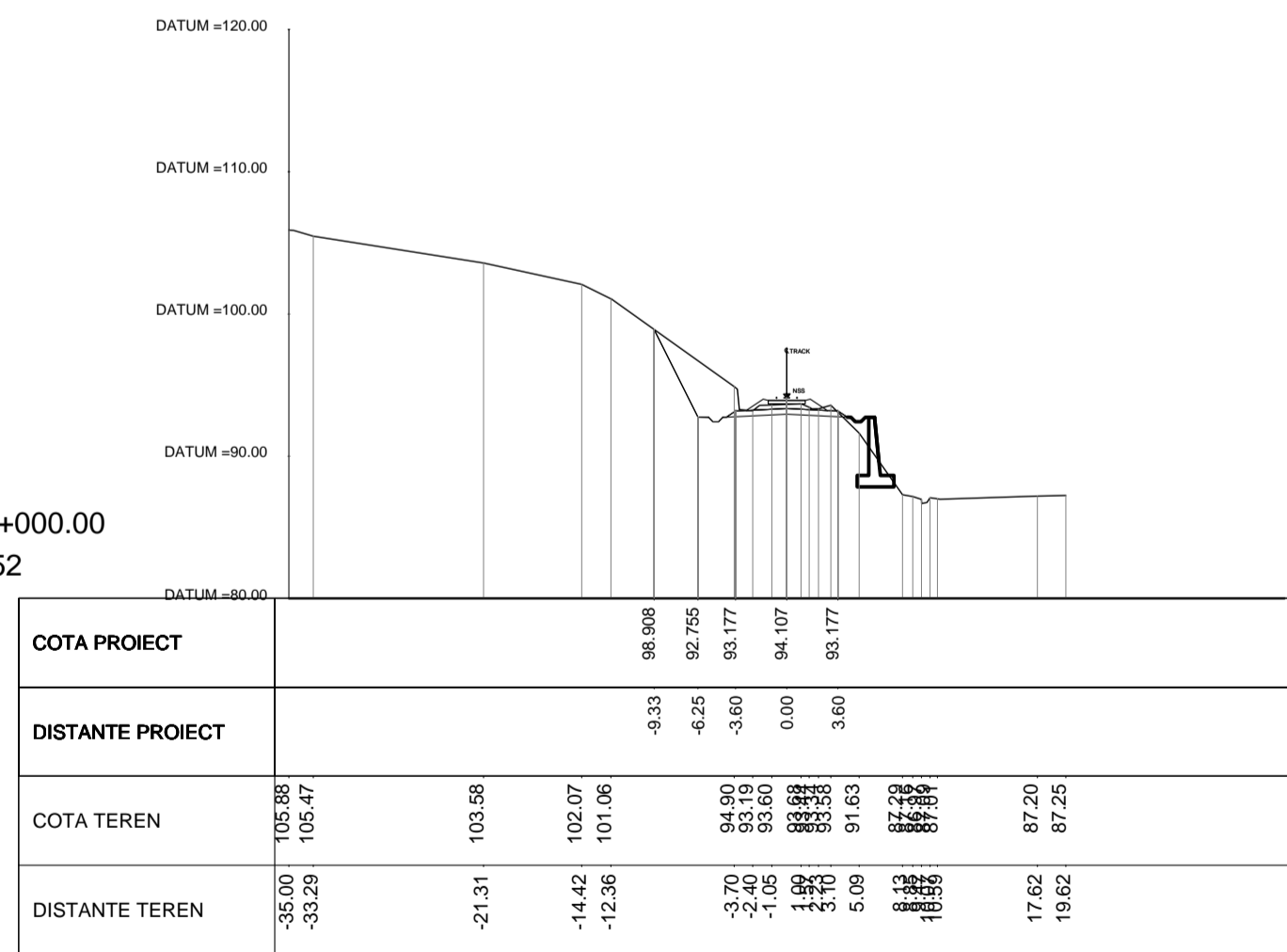

KM.396+200.00
SEC. 553

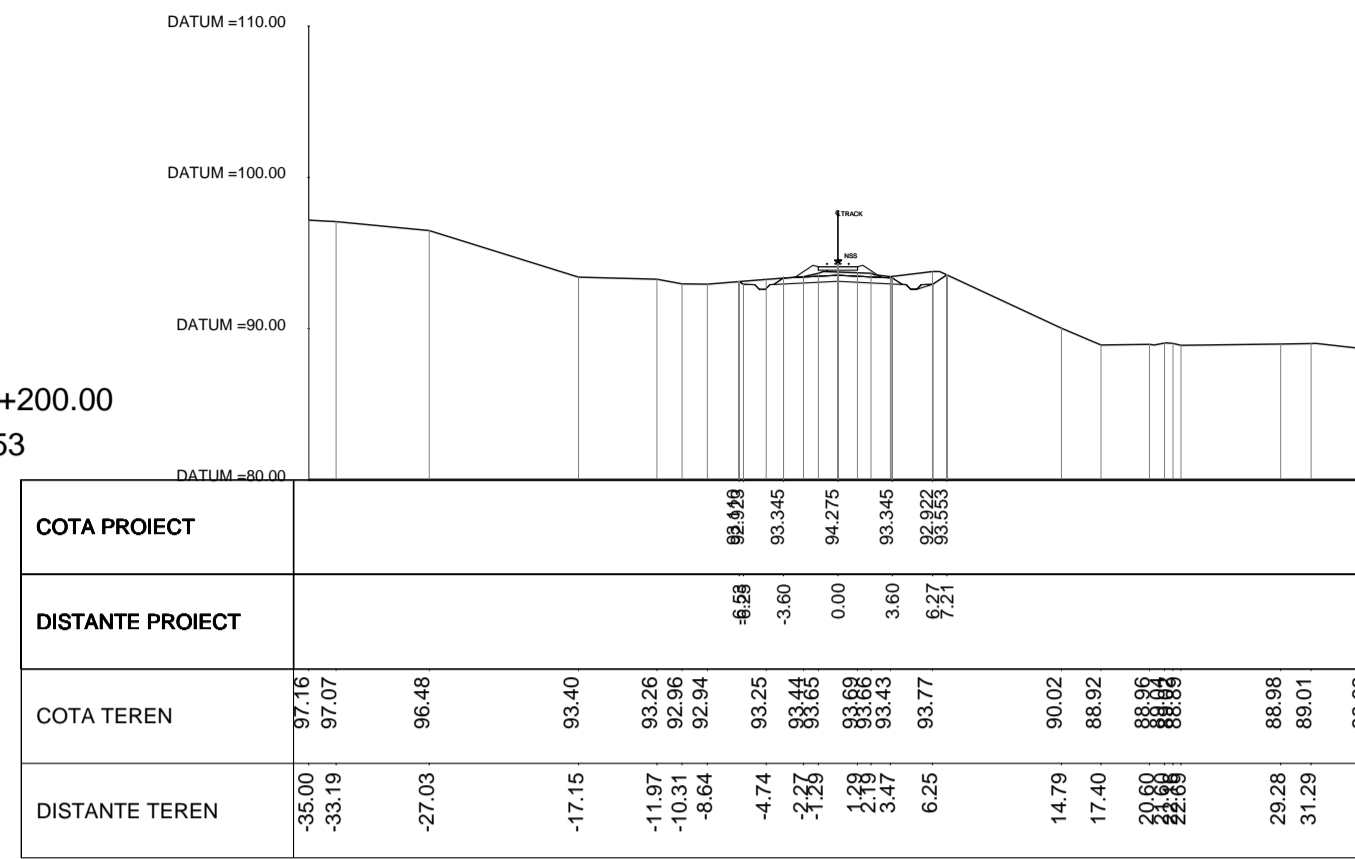

KM.396+400.00
SEC. 554

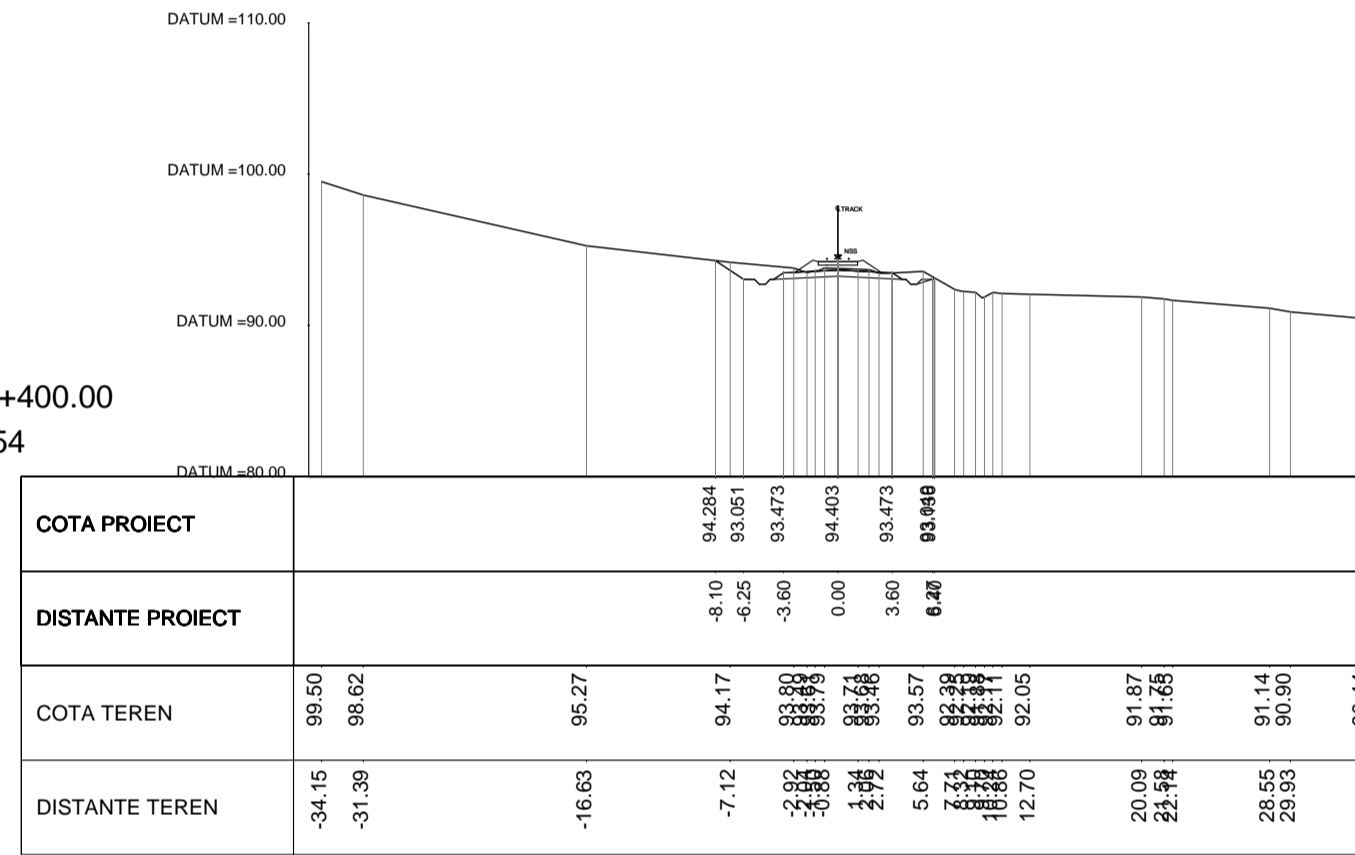

KM.396+600.00
SEC. 555

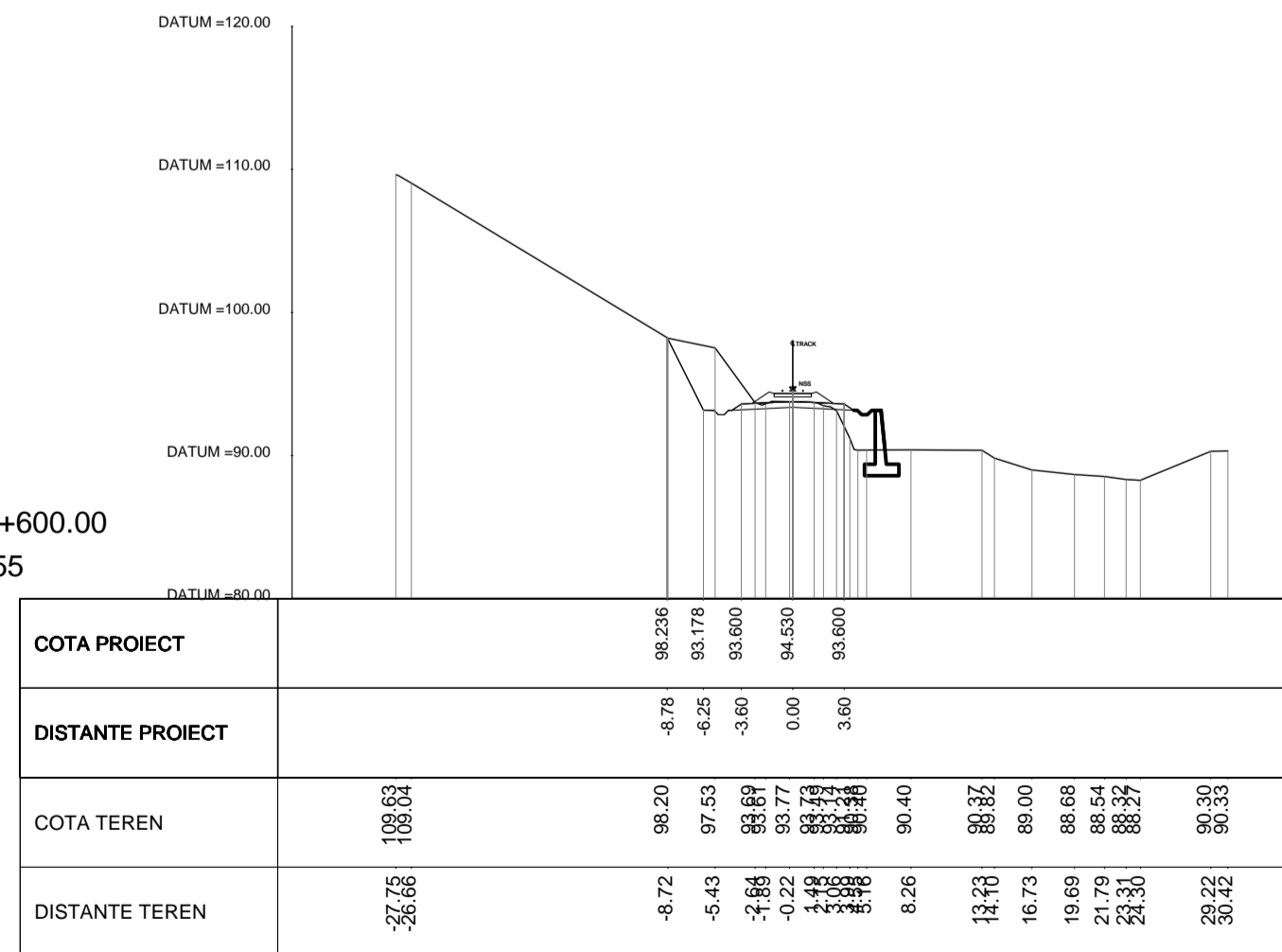

KM.396+800.00
SEC. 556

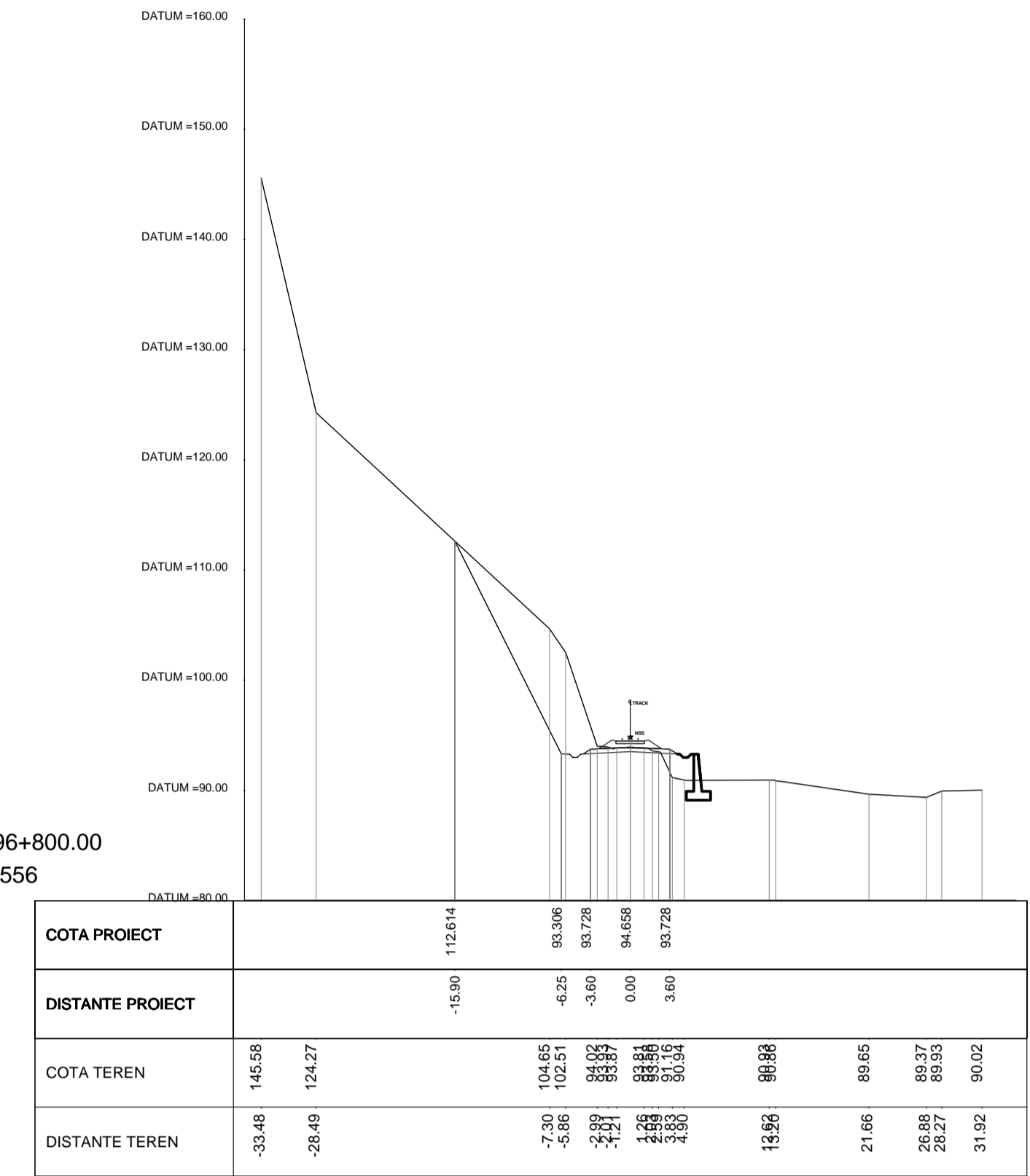

KM.397+000.00
SEC. 557

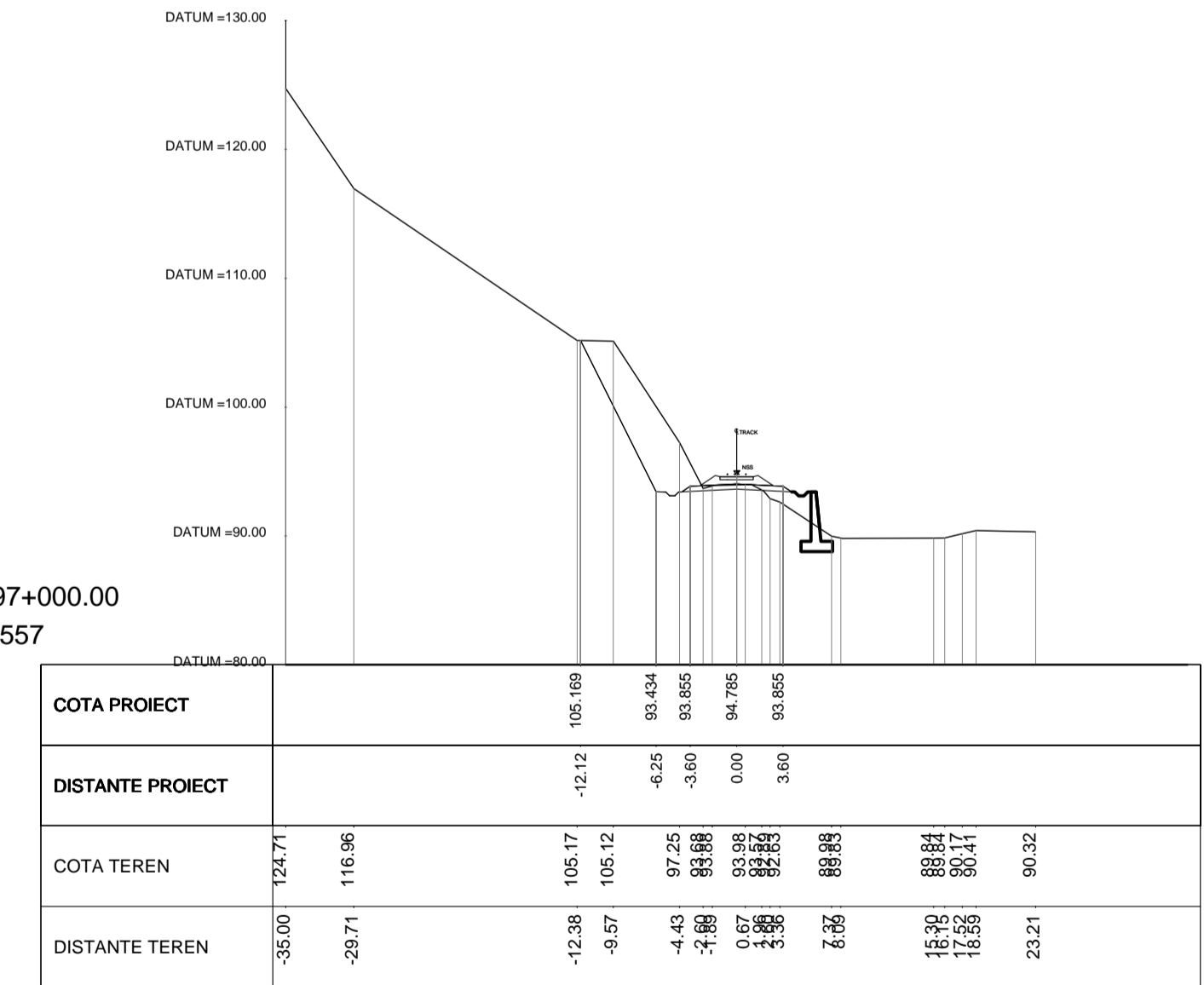

REV.	DATA/DATE	DESCRIERE MODIFICARE / MODIFICATION DESCRIPTION
A	Mai 2020	Prima editie SFF / FFS First submission
B	Sept 2020	Conform solicitărilor Beneficiarului din act nr.11/2/504/2020
C		
D		

FAZA PHASE	NUME NAME	SEMNTURA SIGNATURE
APROBAT APPROVED	S. Menichini	
VERIFICAT CHECKED	S. Menichini	
INTOCMIT ELABORATED	F. Sorge	

FOAIE SHEET 66 din 100 / 66 of 100

DATA DATE Mai 2020

SCARA SCALE 1:500

CLIENT CLIENT

C.N.C.F. "C.F.R." - S.A.

CONSULTANT CONSULTANT

STUDIU DE FEZABILITATE PENTRU REABILITARE A LINIEI FERROVIARE CRAIOVA - CARANSEBES / FEASIBILITY STUDY FOR THE REHABILITATION OF THE RAILWAY LINE CRAIOVA - CARANSEBES

DENUMIRE / TITLE: Profil Transversal km 395+600 - km 397+000 - 66 din 100 / Cross Sections km 395+600 - km 397+000 - 66 of 100

CODIFICARE / CODIFICATION SYSTEM:

NUMAR PROIECT	NUMAR SECTIUNE	FAZA DE PROIECTARE	STATE / INTERVAL	TIP DOCUMENT	SPECIALITATE	NUMAR OBIECT	NUMEROTARE PROGRESIVA	REVIZIE
E218	0	SF	00	W8	AL	0	066	B