

SECTION A-A scale 1:50

SECTION B-B scale 1:50

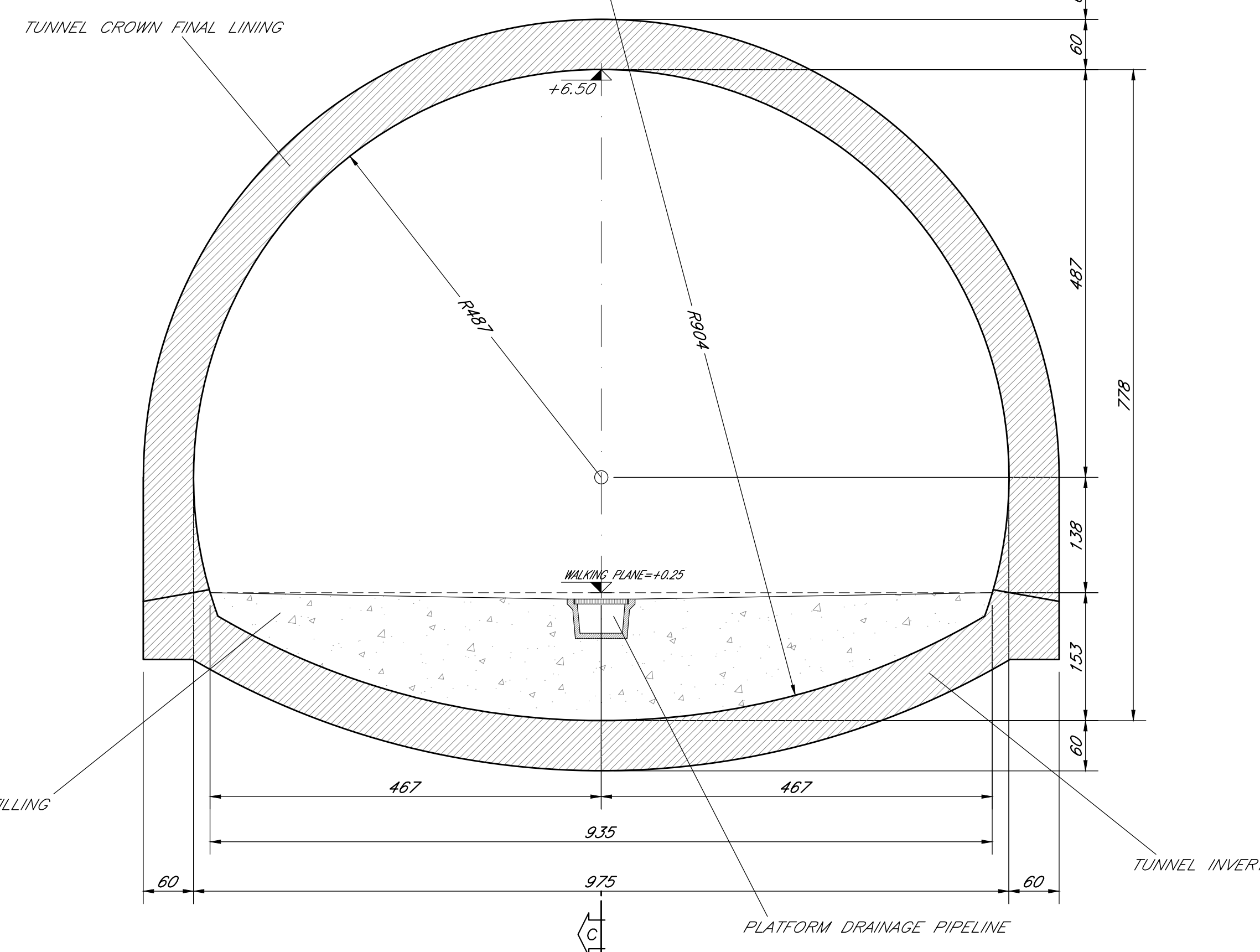

SECTION C-C scale 1:50

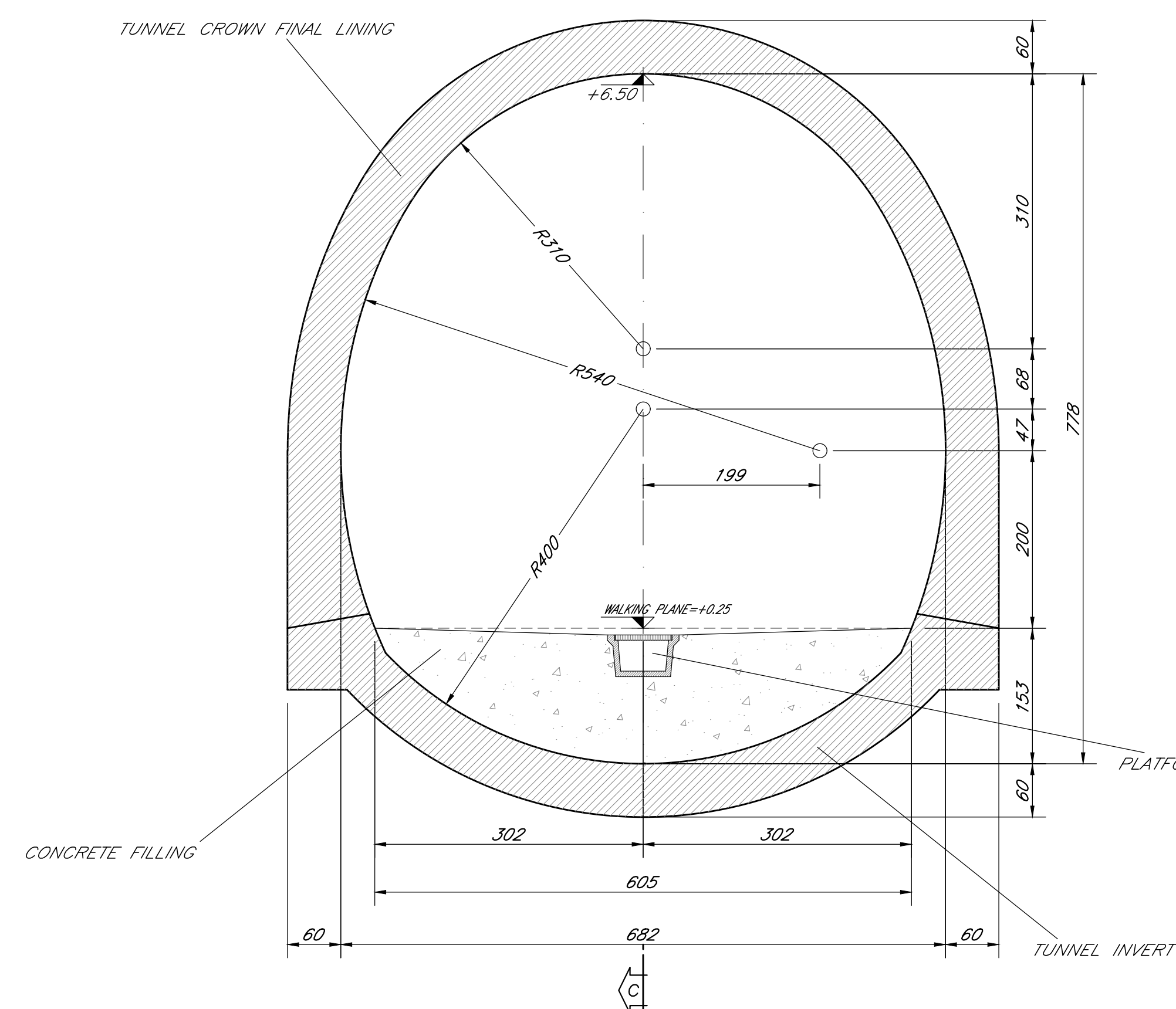
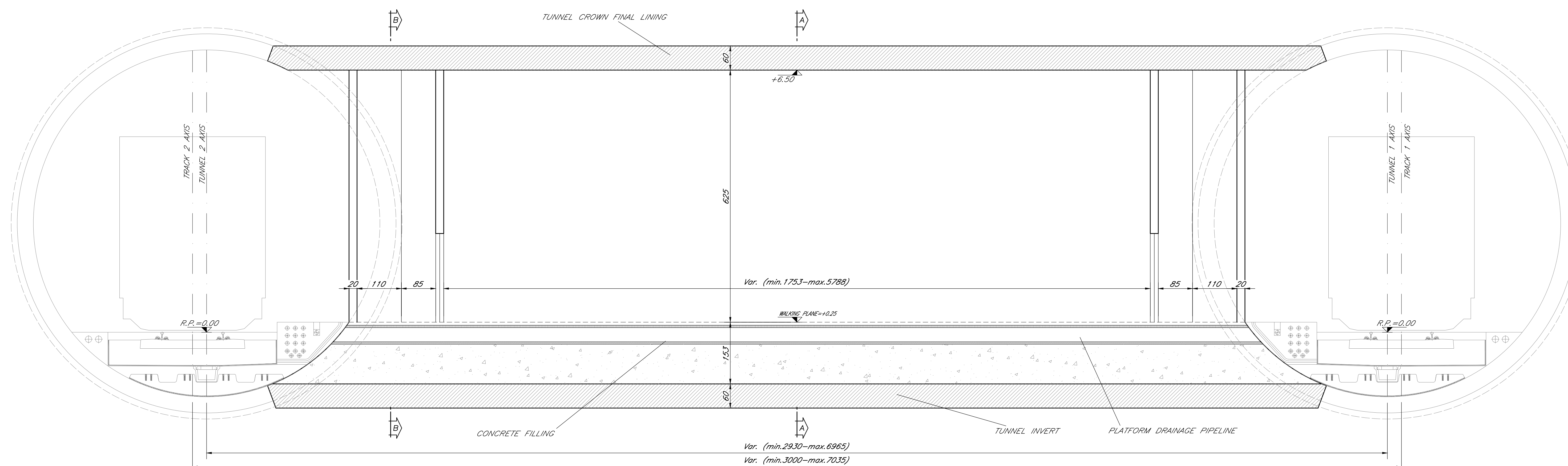

MATERIAL TABLE

TUNNEL INVERT CONCRETE:	TUNNEL CROWN CONCRETE:
- Type C2	- Type C1
- f _{ck} >= 30 MPa	- f _{ck} >= 30 MPa
- Water/Cement ratio < 0.50	- Water/Cement ratio < 0.50
- Minimum structural Class S3+S4	- Minimum structural class S4+S5
- Exposure class related to environmental conditions: XE2	- Exposure class related to environmental conditions: XE2
- Cement type CEM III+V	- Cement type CEM III+V
- Class of chloride content Cl 0,20	- Class of chloride content Cl 0,20
- # max aggregate = 32 mm	- # max aggregate = 32 mm
REINFORCING STEEL:	LEAN CONCRETE:
- B450C controlled by establishment	- Type I
- Weldable	- f _{ck} >= 12 MPa
	- Cement type CEM I+V

Logos for European Union, CFR, and other entities.

CLIENT / CLIENT
C.N.C.F. "C.F.R." - S.A.

CONSULTANT / CONSULTANT

Faza	Positie	Nume	Data	Semnatura
Approbat	Manager de Proiect	Sergio MENCHINI	06.2020	[Signature]
Verificat	Expert Chief	Lorenzo SABINI	06.2020	[Signature]
Checkat	Key Expert			
Intinat	Projectat			
Elaborat	Designer	Rosario RUSSO	06.2020	[Signature]

SUBCONSULTANT / SUBCONSULTANT

Approbat	Responsabil Subconsultant
Intinat	Subconsultant Responsible
Elaborat	Designer

Studiu de Fezabilitate pentru Reabilitarea liniei feroviare Craiova - Drobeta Turnu Severin - Caramanesti, parte a Coridorului Orient-Est Mediterranean

Feasibility Study For The Rehabilitation Of The Railway Line Craiova - Caramanesti

Denumire / Title: Sectiune By-pass - Tunel Balota
By-pass Section - Balota Tunnel

Codificare / Codification System: E2118 I SIF 26 WB TU 0 00 001 A

Historical revisiti / Revision History

Rev.	Data/Date	Descriere Modificare / Modification description
1		
2		
3		

Responsabilitatea privind această publicatie revine integral autorului. Uniunea Europeana nu este responsabila pentru modul in care sunt utilizate informatiile publicate. The contents of this publication are the sole responsibility of (name of the implementing partner) and do not necessarily reflect the opinion of the European Union.