

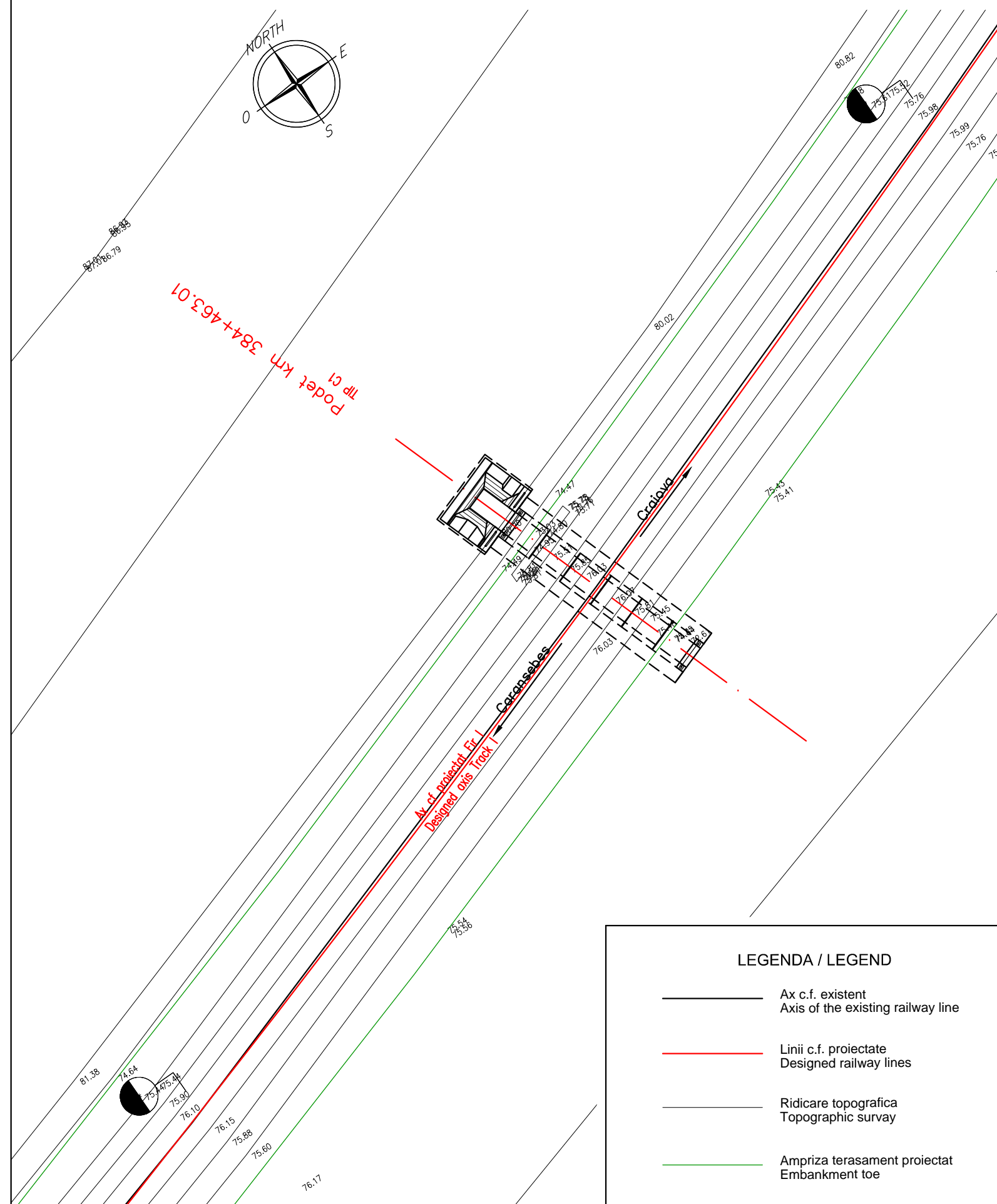

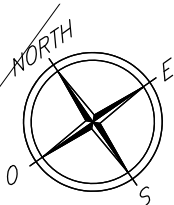

# PLAN DE SITUATIE / SITE PLAN

Sc. 1:200



LEGENDA / LEGEND	
	Ax c.f. existent Axis of the existing railway line
	Linii c.f. proiectate Designed railway lines
	Ridicarea topografica Topographic survey
	Ampriza terasament proiectat Embankment toe



CLIENT / CLIENT

C.N.C.F. "C.F.R." - S.A.



CONSULTANT / CONSULTANT

Faza Phase	Positia Position	Nume Name	Data Date	Semnatura Signature
Aprobat Approved	Manager de Proiect Project Manager	Sergio MENICHINI	10.2020	
Verificat Checked	Expert Cheie Key Expert	Lorenzo SABINI	10.2020	
Întocmit Elaborated	Proiectant Designer	Giovanni VOIRO	10.2020	

SUBCONSULTANT / SUBCONSULTANT

Aprobat Approved	Responsabil Subconsultant Subconsultant Responsible			
Întocmit Elaborated	Proiectant Designer			

Studiu de Fezabilitate pentru Reabilitarea liniei feroviare  
Craiova - Drobeta Turnu Severin - Caransebes,  
parte a Coridorului Orient/Est Mediteranean -  
Feasibility Study For The Rehabilitation Of The Railway Line Craiova - Caransebes

Proiect/Project  
74 / 2018  
Faza/Phase  
S.F.

Denumire / Title :

Plan de situatie podet km pr. 384+463 (km ex. 384+818)

Site plan culvert km pr. 384+463 (km ex. 384+818)

Codificare / Codification System

E 2 1 8 I S F 3 5 L 9 P O 1 1 4 0 0 1 B

Istoricul reviziilor / Revision History

Rev.	Data/Date	Descriere Modificare / Modification description
1		
2		
3		
4		

Responsabilitatea privind această publicație revine integral autorului. Uniunea Europeană nu este responsabilă pentru modul în care sunt utilizate informațiile publicate.

The contents of this publication are the sole responsibility of (name of the implementing partner) and do not necessarily reflect the opinion of the European Union.