

# STATIA C.F. COTOFENI - CLADIRE DE CALATORI SI CLADIRE C.E.D.

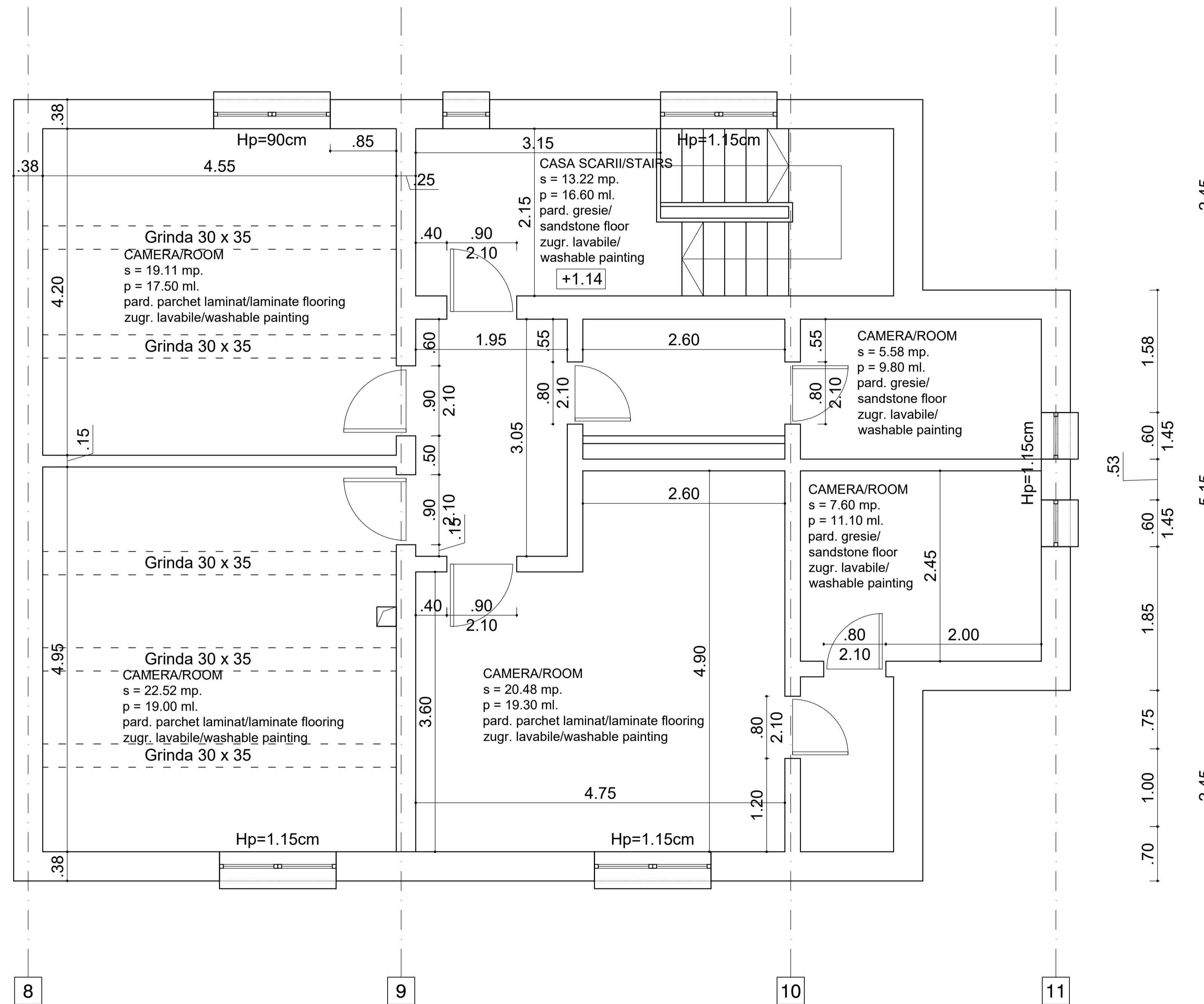



**NOTE**

- The wearing layer of indoor floors and outdoor pavements will be made of easy to maintain, wear-resistant non-slip materials (sandstone, wall-to-wall carpet, parquet, anti-static linoleum floor);
- The facades of buildings will be thermally insulated using wear-resistant materials, decorative plastering and washable painting;
- The walls for indoor circulations will be coated with panels made of wear-resistant materials easy to maintain;
- All spaces are provided with suspended ceilings made of gypsum-board, mineral fiber or aluminum.



**NOTA**

- stratul de uzura al pardoseliilor interioare si al pavajelor exterioare va fi realizat din materiale rezistente la uzura, antiderapante si usor de intretinut (gresie, mocheta, parchet, linoleum antistatic);
- fatadele cladirilor vor fi termoizolate cu materiale rezistente la uzura, cu tencuieli decorative si vopsitorii lavabile;
- peretii circulatiilor interioare vor fi placati cu lambriu din materiale rezistente la uzura si usor de intretinut;
- toate spatiile sunt prevazute cu tavane suspendate din gips- carton, fibre minerale sau aluminiu.







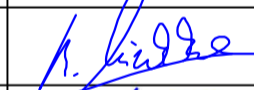

**CLIENT / CLIENT**      **C.N.C.F. "C.F.R." - S.A.**

**CONSULTANT / CONSULTANT**

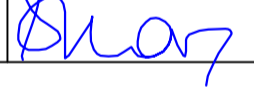
| Faza Phase          | Postia Position                    | Nume Name      | Data Date | Semnatura Signature   |
|---------------------|------------------------------------|----------------|-----------|---|
| Aprobat Approved    | Manager de Proiect Project Manager | Roberto LIUZZA | 05.2020   |  |
| Verificat Checked   | Expert Cheie Key Expert            | Dan PATRASCU   | 05.2020   |  |
| Intocmit Elaborated | Proiectant Designer                | Horia HAS      | 05.2020   |  |

**SUBCONSULTANT / SUBCONSULTANT**

|                     |   |  |  |  |
|---------------------|---|--|--|--|
| Aprobat Approved    | Responsabil Subconsultant Subconsultant Responsible |  |  |  |
| Intocmit Elaborated | Proiectant Designer                                 |  |  |  |

*Studiu de Fezabilitate pentru Reabilitarea liniei feroviare Craiova - Drobeta Turnu Severin - Caransebes, parte a Coridorului Orient/Est Mediteranean - Feasibility Study For The Rehabilitation Of The Railway Line Craiova - Caransebes*

Project/Project  
74 / 2018  
Faza/Phase  
S.F.

**Denumire / Title :**

**STATIA COTOFENI - CLADIRE CALATORI SI C.E.D.  
Propunere Plan Etaj**

**Codificare / Codification System**

E 2 1 8   S   S F   0 7   A B   C C   1   0 1   0 0 2   0

**Istoricul reviziilor / Revision History**

| Rev. | Data/Date | Descriere Modificare / Modification description |
|------|-----------|---|
| 1    |           |   |
| 2    |           |   |
| 3    |           |   |
| 4    |           |   |

Responsabilitatea privind această publicație revine integral autorului. Uniunea Europeană nu este responsabilă pentru modul în care sunt utilizate informațiile publicate.  
The contents of this publication are the sole responsibility of (name of the implementing partner) and do not necessarily reflect the opinion of the European Union.