

STATIA C.F. CRUSOVAT - CLADIRE DE CALATORI

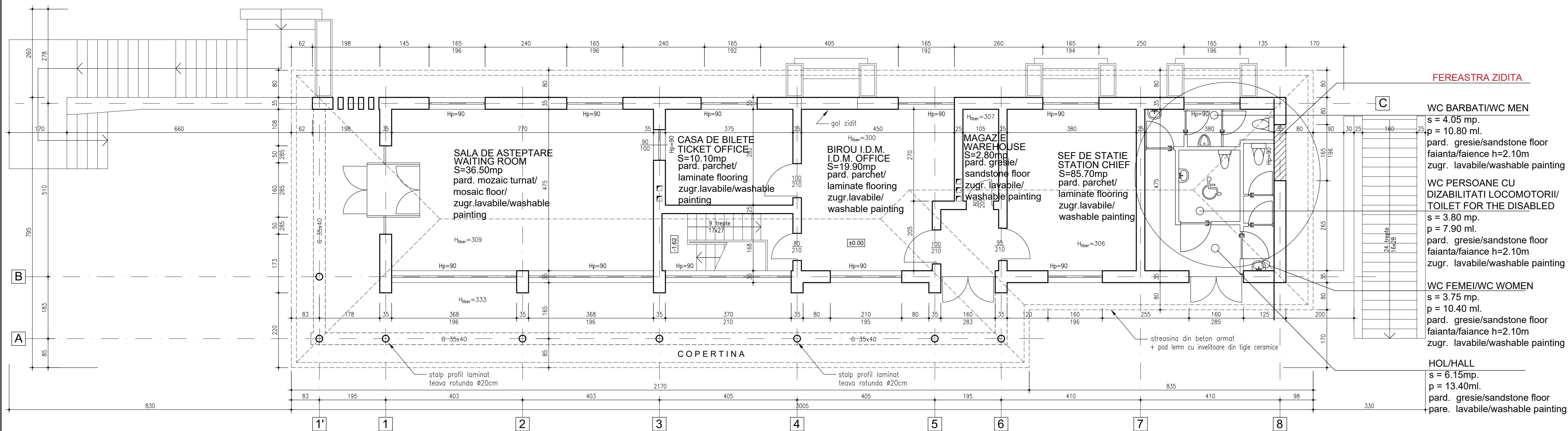

FEREAȘTRA ZIDITA

WC BARBATI/WC MEN
 s = 4.05 mp.
 p = 10.80 ml.
 pard. gresie/sandstone floor
 faianta/faience h=2.10m
 zugr. lavabile/washable painting

WC PERSOANE CU
 DIZABILITATI LOCOMOTORII/
 TOILET FOR THE DISABLED
 s = 3.80 mp.
 p = 7.90 ml.
 pard. gresie/sandstone floor
 faianta/faience h=2.10m
 zugr. lavabile/washable painting

WC FEMEI/WC WOMEN
 s = 3.75 mp.
 p = 10.40 ml.
 pard. gresie/sandstone floor
 faianta/faience h=2.10m
 zugr. lavabile/washable painting

HOL/HALL
 s = 6.15mp.
 p = 13.40ml.
 pard. gresie/sandstone floor
 pard. lavabile/washable painting

- NOTE**
- The wearing layer of indoor floors and outdoor pavements will be made of easy to maintain, wear-resistant non-slip materials (sandstone, wall-to-wall carpet, parquet, anti-static linoleum floor);
 - The facades of buildings will be thermally insulated using wear-resistant materials, decorative plastering and washable painting;
 - The walls for indoor circulations will be coated with panels made of wear-resistant materials easy to maintain;
 - All spaces are provided with suspended ceilings made of gypsum-board, mineral fiber or aluminum.

- NOTA**
- stratul de uzura al pardosellilor interioare si al pavajelor exterioare va fi realizat din materiale rezistente la uzura, antiderapante si usor de intretinut (gresie, mocheta, parchet, linoleum antistatic);
 - fatadele cladirilor vor fi termoizolate cu materiale rezistente la uzura, cu tencuieli decorative si vopsitorii lavabile;
 - peretii circulatiilor interioare vor fi placati cu lambruri din materiale rezistente la uzura si usor de intretinut;
 - toate spatiile sunt prevazute cu tavane suspendate din gips- carton, fibre minerale sau aluminiu.

CLIENT / CLIENT C.N.C.F. "C.F.R." - S.A.																					
CONSULTANT / CONSULTANT <table border="1"> <tr> <th>Faza / Phase</th> <th>Pozitia / Position</th> <th>Nume / Name</th> <th>Data / Date</th> <th>Semnatura / Signature</th> </tr> <tr> <td>Approbat / Approved</td> <td>Manager de Proiect / Project Manager</td> <td>Roberto LIUZZA</td> <td>05.2020</td> <td></td> </tr> <tr> <td>Verificat / Checked</td> <td>Expert Client / Key Expert</td> <td>Dan PATRASCU</td> <td>05.2020</td> <td></td> </tr> <tr> <td>Elaborat / Elaborated</td> <td>Proiectant / Designer</td> <td>Horia HAS</td> <td>05.2020</td> <td></td> </tr> </table>		Faza / Phase	Pozitia / Position	Nume / Name	Data / Date	Semnatura / Signature	Approbat / Approved	Manager de Proiect / Project Manager	Roberto LIUZZA	05.2020		Verificat / Checked	Expert Client / Key Expert	Dan PATRASCU	05.2020		Elaborat / Elaborated	Proiectant / Designer	Horia HAS	05.2020	
Faza / Phase	Pozitia / Position	Nume / Name	Data / Date	Semnatura / Signature																	
Approbat / Approved	Manager de Proiect / Project Manager	Roberto LIUZZA	05.2020																		
Verificat / Checked	Expert Client / Key Expert	Dan PATRASCU	05.2020																		
Elaborat / Elaborated	Proiectant / Designer	Horia HAS	05.2020																		
SUBCONSULTANT / SUBCONSULTANT <table border="1"> <tr> <th>Approbat / Approved</th> <th>Responsabil Subconsultant / Subconsultant Responsible</th> <th>Data / Date</th> <th>Semnatura / Signature</th> </tr> <tr> <td></td> <td></td> <td></td> <td></td> </tr> </table>		Approbat / Approved	Responsabil Subconsultant / Subconsultant Responsible	Data / Date	Semnatura / Signature																
Approbat / Approved	Responsabil Subconsultant / Subconsultant Responsible	Data / Date	Semnatura / Signature																		
Studiu de Fezabilitate pentru Reabilitarea Liniei Feroviare Craiova - Drobeta Turnu Severin - Caransebes, parte a Coridorului Oriental al Mediteranean - Feasibility Study For The Rehabilitation Of The Railway Line Craiova - Caransebes																					
Denumire / Title : STATIA C.F. CRUSOVAT - CLADIRE DE CALATORI Propunere Plan Parter																					
Codificare / Codification System E218 S SF 50 AB CC 1 01 001 0																					
Istoricul revizii / Revision History <table border="1"> <tr> <th>Rev.</th> <th>Data/Date</th> <th>Descriere Modificare / Modification description</th> </tr> <tr> <td>1</td> <td></td> <td></td> </tr> <tr> <td>2</td> <td></td> <td></td> </tr> <tr> <td>3</td> <td></td> <td></td> </tr> <tr> <td>4</td> <td></td> <td></td> </tr> </table>		Rev.	Data/Date	Descriere Modificare / Modification description	1			2			3			4							
Rev.	Data/Date	Descriere Modificare / Modification description																			
1																					
2																					
3																					
4																					
Responsabilitatea privind aceasta publicatie revine integral autorului. Uniunea Europeana nu este responsabila pentru modul in care sunt utilizate informatiile publicate. The contents of this publication are the sole responsibility of (name of the implementing partner) and do not necessarily reflect the opinion of the European Union.																					