

STATIA C.F. BALTA SARATA - CLADIRE DE CALATORI

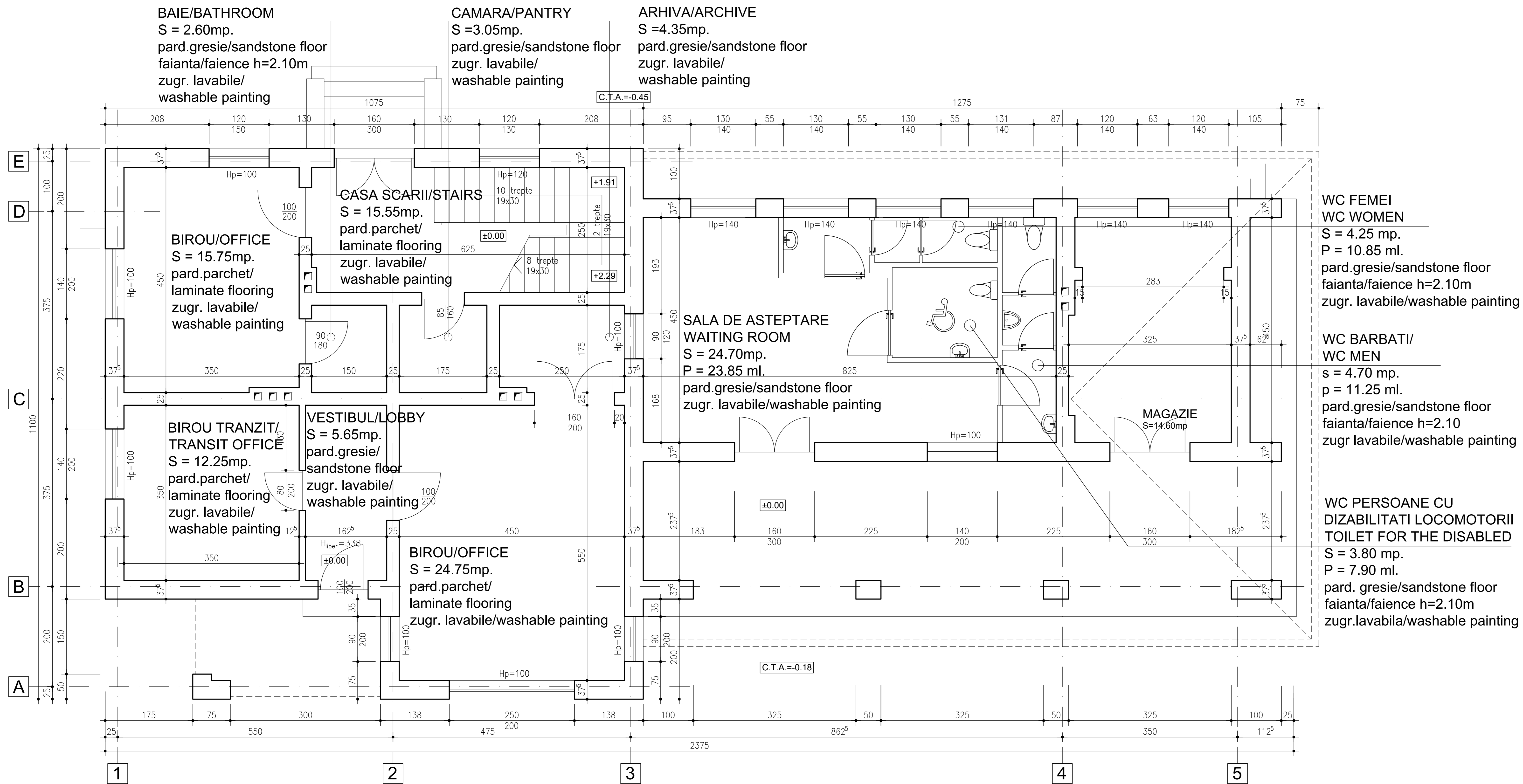

NOTE

- The wearing layer of indoor floors and outdoor pavements will be made of easy to maintain, wear-resistant non-slip materials (sandstone, wall-to-wall carpet, parquet, anti-static linoleum floor);
- The facades of buildings will be thermally insulated using wear-resistant materials, decorative plastering and washable painting;
- The walls for indoor circulations will be coated with panels made of wear-resistant materials easy to maintain;
- All spaces are provided with suspended ceilings made of gypsum-board, mineral fiber or aluminum.

NOTA

- stratul de uzura al pardosellilor interioare si al pavajelor exterioare va fi realizat din materiale rezistente la uzura, antiderapante si usor de intretinut (gresie, mocheta, parchet, linoleum antistatic);
- fatadele cladirilor vor fi termoizolate cu materiale rezistente la uzura, cu tencuieli decorative si vopsitorii lavabile;
- peretii circulatiilor interioare vor fi placati cu lambruri din materiale rezistente la uzura si usor de intretinut;
- toate spatiile sunt prevazute cu tavane suspendate din gips- carton, fibre minerale sau aluminiu.

<b>CLIENT / CLIENT</b>		<b>C.N.C.F. "C.F.R." - S.A.</b>		
<b>CONSULTANT / CONSULTANT</b>				
Faza Phase	Postia Position	Nume Name	Data Date	Semnatura Signature
Approbat Approved	Manager de Proiect Project Manager	Roberto LIUZZA	02.2020	
Verificat Checked	Expert Cheie Key Expert	Dan PATRASCU	02.2020	
Intocmit Elaborated	Proiectant Designer	Horia HAS	02.2020	
<b>SUBCONSULTANT / SUBCONSULTANT</b>				
Approbat Approved	Responsabil Subconsultant Responsible			
Intocmit Elaborated	Proiectant Designer			
<i>Studiu de Fezabilitate pentru Reabilitarea Liniei feroviare Craiova - Drobeta Turnu Severin - Caransebes, parte a Coridorului Orient/Est Mediteranean - Feasibility Study For The Rehabilitation Of The Railway Line Craiova - Caransebes</i>				Proiect/Project 74 / 2018 Faza/Phase S.F.
Denumire / Title :				
<b>STATIA C.F. BALTA SARATA - CLADIRE DE CALATORI</b> Propunere Plan Parter				
Codificare / Codification System				
E 2 1 8    8    S F    6 4    R B    C C    1    0 1    0 0 1    0				
Istoricul revizilor / Revision History				
Rev.	Data/Date	Descriere Modificare / Modification description		
1				
2				
3				
4				
Responsabilitatea privind această publicatie revine integral autorului. Uniunea Europeană nu este responsabilă pentru modul in care sunt utilizate informatiile publicate. The contents of this publication are the sole responsibility of (name of the implementing partner) and do not necessarily reflect the opinion of the European Union.				