

**BENEFICIAR**

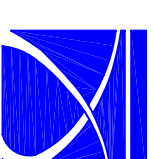

COMPANIA NATIONALA DE AUTOSTRAZI  
SI DRUMURI NATIONALE DIN ROMANIA

**PROIECTANT**

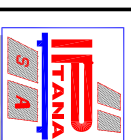

**IPTANA S.A.**

**INVESTITIA**

AUTOSTRADA  
DITRAU -TARGU NEAMT

CONTRACT NR: 92 / 58623 / 4275

**FAZA DE PROIECTARE**  
Studiu de Fezabilitate  
Varianta optima  
de construire

Proiectat Ing. L. Omir  
Desenat Ing. L. Omir

Verificat Ing. M. Man  
Seft Proiect Ing. P. Osman

Scara: 1:500

Data: NOIEMBRIE 2010

PLAN DE SITUATIE  
CENTRU DE INTRETINERE SI  
COORDONARE NOD TG.NEAMT

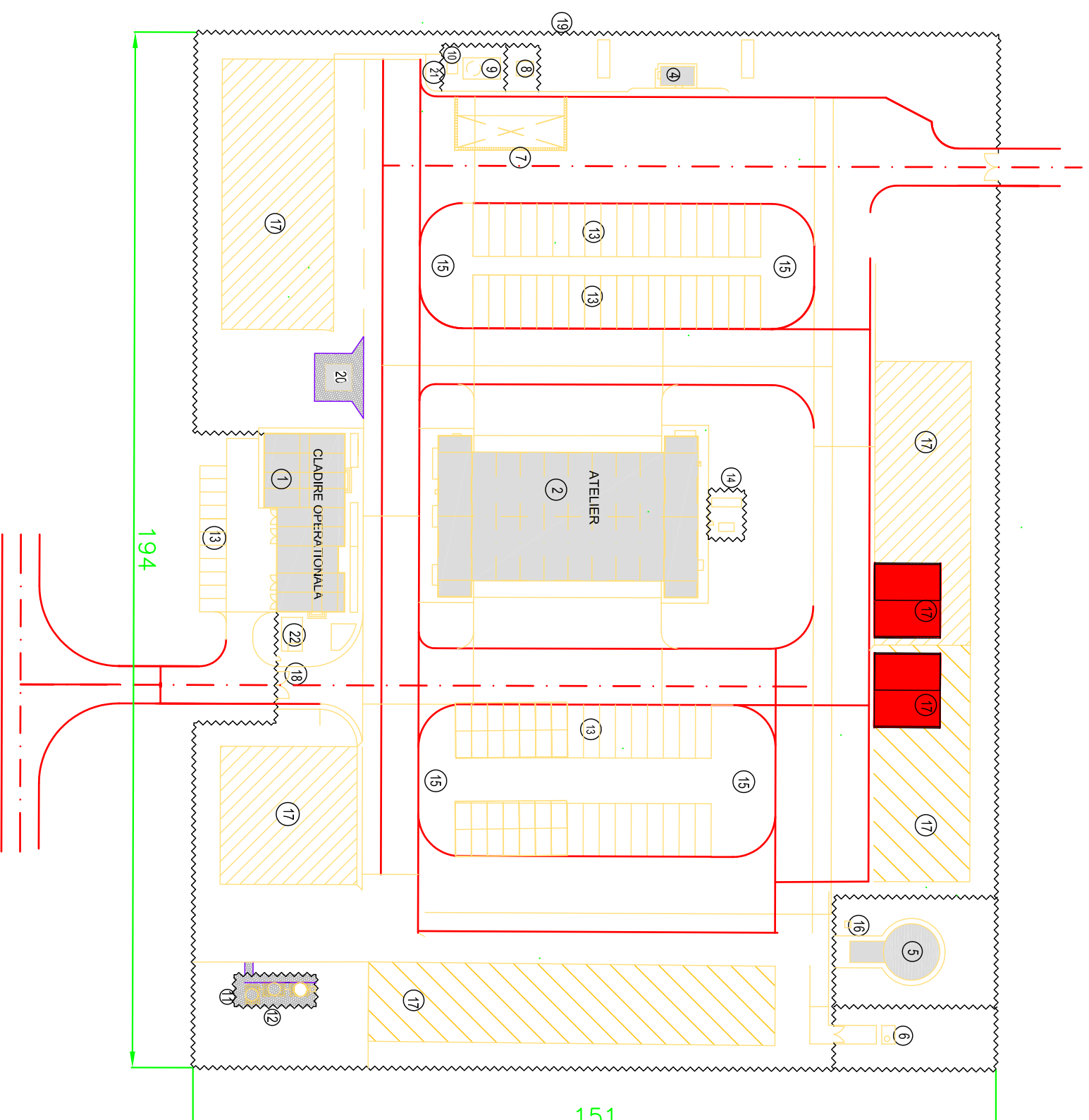

**LEGENDA:**

- CENTRU DE INTRETINERE**
- 1 - CLADIRE OPERATIONALA - P+1
  - 2 - ATELIER INTRETINERE - P
  - 3 - DEPOZIT MATERIALE ANTIDERAPANTE
  - 4 - STATIE ALIMENTARE CARBURANTI
  - 5 - REZERVOR APA 200 mc
  - 6 - PUT FORAT
  - 7 - PLATFORMA SPALARE
  - 8 - PLATFORMA NAMOL
  - 9 - DECANTOR SEPARATOR DE MAMOL SI ULEI
  - 10 - STATIE POMPE RECIRCULARE
  - 11 - STATIE EPURARE MECANO-BIOLOGICA
  - 12 - STATIE POMPE APE UZATE
  - 13 - PLATFORME PARCARE
  - 14 - REZERVOARE DE COMBUSTIBIL PENTRU C.T.
  - 15 - SEPARATOR PRODUSE PETROLIERE
  - 16 - CAMIN ALIMENTARE MASINI POMPIERI
  - 17 - DEPOZITE DESCHISE SI ACOPERITE
  - 18 - PORTI METALICE
  - 19 - IMPREJMURI PLASA SARMA
  - 20 - POST TRAFU IN CABINA 63KVVA
  - 21 - PLATFORMA REZIDURI MENAJERIE
  - 22 - CABINA POARTA

**LEGEND:**

- MAINTENANCE CENTER**
- 1 - SERVICE BUILDING - P+1
  - 2 - WORKSHOP - P
  - 3 - NON-SLIP MATERIALS STORE HOUSE
  - 4 - FUEL FEEDING STATION
  - 5 - WATER TANK
  - 6 - DRILLED WELL
  - 7 - WASHING PLATFORM
  - 8 - MUD PLATFORM
  - 9 - MUD AND OIL SETTLING TANK
  - 10 - RECYCLING PUMPS STATION
  - 11 - MECHANICAL - BIOLOGICAL PURGING STATION
  - 12 - WASTE WATER PUMP STATION
  - 13 - PARKING PLATFORMS
  - 14 - THERMAL STATION FUEL TANKS
  - 15 - OIL SEPARATOR
  - 16 - FIRE VEHICLES SUPPLY STATION
  - 17 - OPEN AND COVERED STORAGE
  - 18 - GATE
  - 19 - WIRE NET FENCING
  - 20 -TRANSFORMING STATION
  - 21 -DOMESTIC GARBAGE
  - 22 - GATE CABIN

Area: 29294mp