

SFARSIT AUTOSTRADA TARGU MURES - DITRAU - KM 92+150
 INCEPUT AUTOSTRADA DITRAU - TARGU NEAMT - KM 0+000

DITRAU ←

TARGU NEAMT →

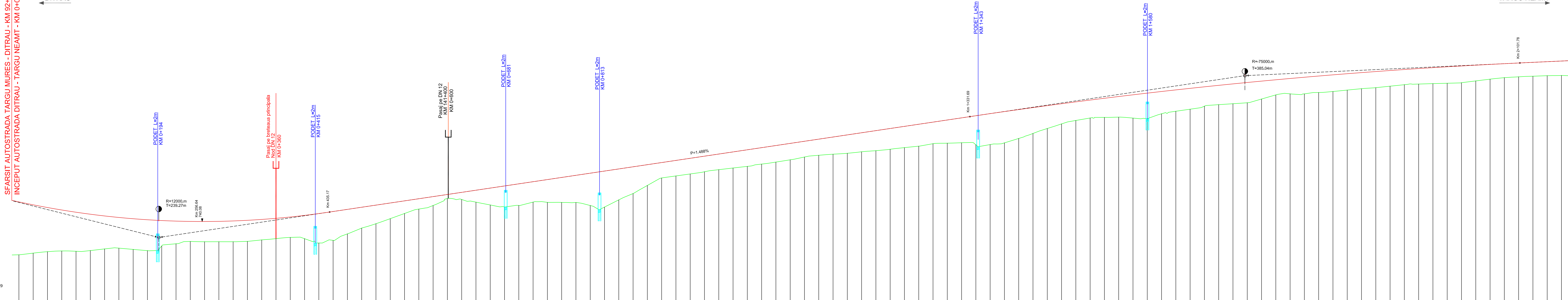

DATUM LEVEL=729
 PL_REF=729

CHAINAGE	
KILOMETRAJ	0.00
GRADE LEVELS	742.82
COTE PROIECT	742.82
GROUND LEVELS	735.42
COTE TEREN	735.42
LEVELS DIFFERENCE	
DIFERENTE IN AX	
VERTIC. GEOMETR.	R=12000.00 L=478.53
DECLIVITATI	
HORIZ. GEOMETR.	P=1.49% L=896.52
AMENAJARE PLAN	R=3000.00 L=3835.44

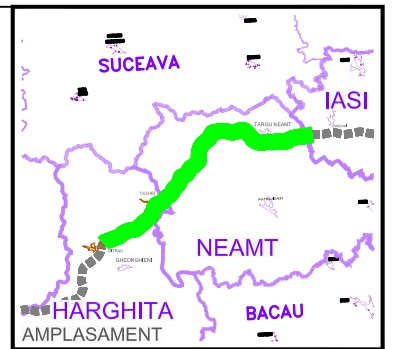

BENEFICIAR

 COMPANIA NATIONALA DE AUTOSTRAZI
 SI DRUMURI NATIONALE DIN ROMANIA

PROIECTANT

IPTANA S.A.

INVESTITIA
 AUTOSTRADA
 DITRAU - TARGU NEAMT
 CONTRACT Nr: 92 / 58623 / 4275

FAZA DE PROIECTARE
 Studiu de Fezabilitate

Proiectat ing. M. Georgescu	Desenat ing. R. Georgescu
Verificat ing. V. Moroluanu	Sef Proiect ing. V. Osman

Lucrari de Drumuri

Scara: 1:2000 / 1:200
 Data: IANUARIE 2011

PROFIL LONGITUDINAL
 KM 0+000 - KM 2+160
 Cod: IPT-SF-D-PL-001 Rev. 0