

DITRAU

TARGU NEAMT

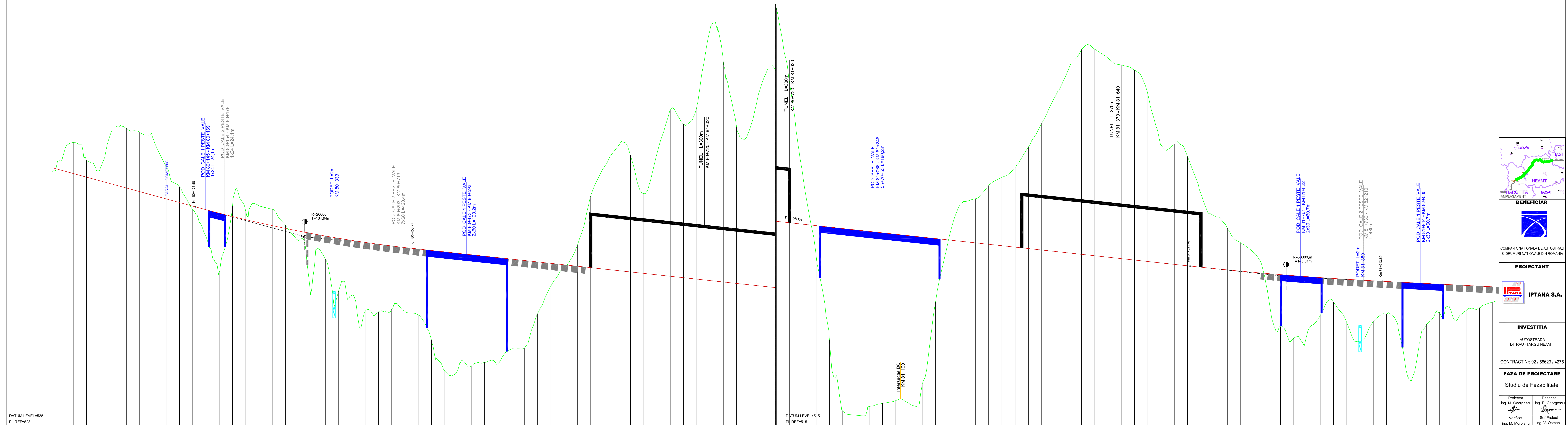

CHAINAGE	565.50	564.14	79+920.00	566.27	563.99	79+940.00	566.55	563.65	79+960.00	564.21	565.50	79+980.00	570.24	561.95	80+000.00	570.38	561.41	80+020.00	569.82	560.86	80+040.00	568.91	560.32	80+060.00	564.66	560.77	80+080.00	561.80	560.22	80+100.00	566.10	560.84	80+120.00	564.08	560.14	80+140.00	548.75	557.62	80+160.00	556.87	557.12	80+180.00	565.00	565.64	80+200.00	566.73	565.18	80+220.00	566.21	565.74	80+240.00	555.75	565.32	80+260.00	553.53	564.92	80+280.00	554.75	564.51	80+300.00	560.74	564.18	80+320.00	545.92	563.84	80+340.00	545.29	563.52	80+360.00	542.80	563.22	80+380.00	542.75	562.94	80+400.00	543.12	562.68	80+420.00	542.82	562.44	80+440.00	542.28	562.22	80+460.00	538.47	562.01	80+480.00	533.88	561.79	80+500.00	534.05	561.57	80+520.00	534.60	561.36	80+540.00	535.13	561.14	80+560.00	534.90	560.93	80+580.00	537.13	560.71	80+600.00	537.29	560.49	80+620.00	542.47	560.29	80+640.00	546.63	560.06	80+660.00	546.50	560.85	80+680.00	562.78	560.63	80+700.00	560.21	560.41	80+720.00	564.50	560.20	80+740.00	567.54	560.98	80+760.00	566.30	560.77	80+780.00	560.58	560.55	80+800.00	566.62	560.33	80+820.00	572.15	560.12	80+840.00	571.04	560.90	80+860.00	572.64	560.69	80+880.00	565.29	560.47	80+900.00	560.32	560.25	80+920.00	570.80	560.04	80+940.00	570.34	560.82	80+960.00	577.68	560.61	80+980.00	578.50	560.39	81+000.00	567.17	560.17	81+020.00	562.20	560.95	81+040.00	541.15	560.74	81+060.00	528.54	560.53	81+080.00	517.80	560.31	81+100.00	517.18	560.09	81+120.00	518.49	560.88	81+140.00	516.98	560.66	81+160.00	518.39	560.45	81+180.00	518.95	560.23	81+200.00	521.88	560.01	81+220.00	524.24	560.80	81+240.00	543.81	560.58	81+260.00	540.12	560.37	81+280.00	548.79	560.15	81+300.00	551.76	560.93	81+320.00	553.03	560.72	81+340.00	554.48	560.50	81+360.00	557.69	560.29	81+380.00	561.13	560.07	81+400.00	565.12	560.85	81+420.00	566.19	560.64	81+440.00	572.25	560.42	81+460.00	572.32	560.21	81+480.00	570.97	560.99	81+500.00	566.93	560.77	81+520.00	568.18	560.56	81+540.00	565.56	560.34	81+560.00	557.87	560.13	81+580.00	558.00	560.91	81+600.00	556.14	560.69	81+620.00	565.55	560.46	81+640.00	547.24	560.27	81+660.00	545.36	560.08	81+680.00	543.16	560.89	81+700.00	541.66	560.71	81+720.00	536.13	560.53	81+740.00	530.51	560.37	81+760.00	526.77	560.30	81+780.00	528.34	560.06	81+800.00	532.21	560.92	81+820.00	534.24	560.79	81+840.00	531.12	560.66	81+860.00	528.35	560.54	81+880.00	531.32	560.43	81+900.00	532.39	560.33	81+920.00	528.11	560.23	81+940.00	523.14	560.13	81+960.00	530.84	560.03	81+980.00	532.68	560.83	82+000.00	532.95	560.73	82+020.00	533.37	560.63	82+040.00	534.22	560.53	82+060.00
LEVELS DIFFERENCE																																																																																																																																																																																																																																																																																																																																				
DIFERENTE IN AX																																																																																																																																																																																																																																																																																																																																				
VERTIC. GEOMETR.																																																																																																																																																																																																																																																																																																																																				
DECLIVITATI																																																																																																																																																																																																																																																																																																																																				
HORIZ. GEOMETR.																																																																																																																																																																																																																																																																																																																																				
AMENAJARE PLAN	R=1600.00 L=238.44	CL=140.00																						D=458.20	CL=140.00		P=-1.08% L=1169.90	CL=140.00														D=581.93																																																																																																																																																																																																																																																																																										

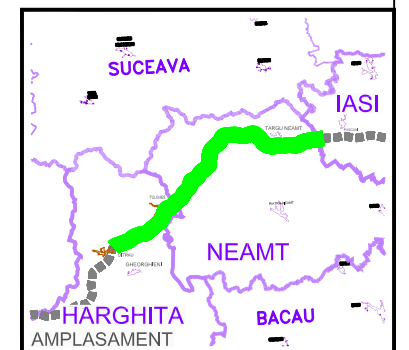

**BENEFICIAR**  
 COMPANIA NATIONALA DE AUTOSTRAZI SI DRUMURI NATIONALE DIN ROMANIA

**PROIECTANT**  
 IPTANA S.A.

**INVESTITIA**  
 AUTOSTRADA  
 DITRAU - TARGU NEAMT

CONTRACT Nr: 92 / 58623 / 4275  
**FAZA DE PROIECTARE**  
 Studiu de Fezabilitate  
 Proiectat Ing. M. Georgescu     Desenat Ing. R. Georgescu  
 Verificat Ing. M. Morlanu     Self Proiect Ing. V. Osman

**LUCRARI DE DRUMURI**  
 Scara: 1:2000 / 1:200  
 Data: IANUARIE 2011  
**PROFIL LONGITUDINAL**  
 KM 79+920 - KM 82+080  
 Cost: IPT-SFD-PL-038     Rev. 0