

DITRAU

TARGU NEAMT



BENEFICIAR



COMPANIA NATIONALA DE AUTOSTRAZI SI DRUMURI NATIONALE DIN ROMANIA

PROIECTANT



INVESTITIA

AUTOSTRADA DITRAU - TARGU NEAMT

CONTRACT Nr: 92 / 58623 / 4275

FAZA DE PROIECTARE

Studiu de Fezabilitate

Proiectat Ing. M. Georgescu	Desenat Ing. R. Georgescu
Verificat Ing. M. Moroluanu	Sef Proiect Ing. V. Osman

Lucrari de Drumuri

Scara: 1:2000 / 1:200

Data: IANUARIE 2011

PROFIL LONGITUDINAL  
KM 95+040 - KM 97+200

Cod: IPT-SF-D-PL-045 Rev. 0

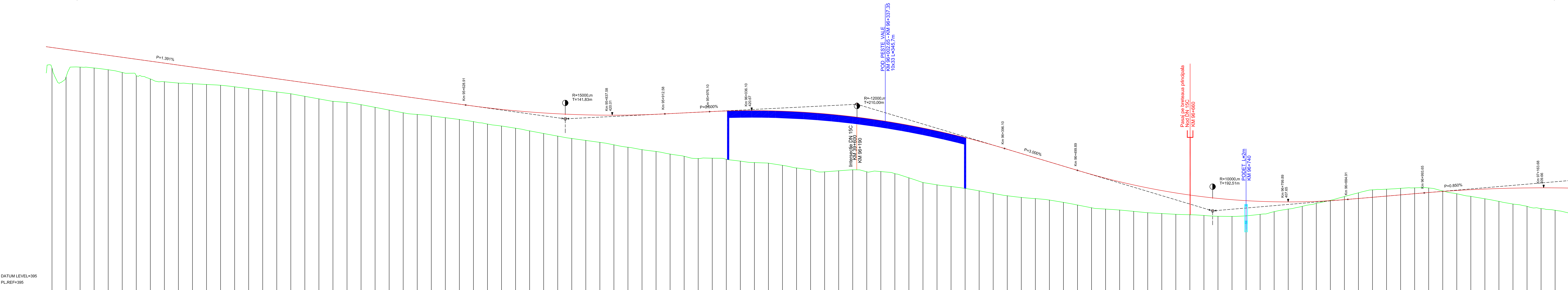

CHAINAGE	GRADE LEVELS COTE PROIECT	GROUND LEVELS COTE TEREN	LEVELS DIFFERENCE DIFERENTE IN AX
95+040.00	426.66	426.71	
95+050.00	426.38	426.46	
95+060.00	426.10	426.86	
95+100.00	426.82	426.73	
95+120.00	426.54	426.48	
95+140.00	426.26	426.10	
95+150.00	425.99	425.62	
95+160.00	425.71	425.34	
95+200.00	427.43	424.78	
95+220.00	427.15	424.50	
95+240.00	426.87	424.22	
95+260.00	426.59	423.94	
95+280.00	426.32	423.67	
95+300.00	426.04	423.39	
95+320.00	425.76	423.11	
95+340.00	425.48	422.83	
95+360.00	425.20	422.55	
95+380.00	424.93	422.28	
95+400.00	424.65	422.00	
95+420.00	424.37	421.72	
95+440.00	424.09	421.44	
95+460.00	423.81	421.16	
95+480.00	423.53	420.88	
95+500.00	423.25	420.60	
95+520.00	422.98	420.32	
95+540.00	422.70	420.04	
95+560.00	422.42	419.76	
95+580.00	422.14	419.48	
95+600.00	421.87	419.20	
95+620.00	421.59	418.92	
95+628.91	421.46	418.79	
95+640.00	421.31	418.64	
95+660.00	421.06	418.39	
95+680.00	420.84	418.17	
95+700.00	420.64	417.97	
95+720.00	420.47	417.80	
95+740.00	420.33	417.66	
95+760.00	420.21	417.54	
95+770.74	420.16	417.49	
95+780.00	420.12	417.45	
95+800.00	420.06	417.40	
95+820.00	420.02	417.36	
95+840.00	420.01	417.35	
95+860.00	420.03	417.37	
95+880.00	420.07	417.41	
95+900.00	420.14	417.48	
95+912.58	420.20	417.54	
95+920.00	420.24	417.58	
95+940.00	420.34	417.68	
95+960.00	420.44	417.78	
95+980.00	420.54	417.88	
95+100.00	420.60	417.94	
95+120.00	420.37	417.71	
95+140.00	420.22	417.56	
95+160.00	420.03	417.37	
95+180.00	419.80	417.14	
95+186.10	419.73	417.07	
95+200.00	419.55	416.89	
95+220.00	419.26	416.60	
95+240.00	418.93	416.27	
95+260.00	418.56	415.90	
95+280.00	418.19	415.53	
95+300.00	417.76	415.10	
95+320.00	417.31	414.65	
95+340.00	416.82	414.16	
95+360.00	416.30	413.64	
95+380.00	415.74	413.08	
95+396.10	415.27	412.61	
95+420.00	414.55	411.89	
95+440.00	413.95	411.29	
95+460.00	413.35	410.69	
95+480.00	412.75	410.09	
95+498.89	412.15	410.49	
95+520.00	411.57	409.91	
95+540.00	411.03	409.37	
95+560.00	410.53	408.87	
95+580.00	410.07	408.41	
95+600.00	409.65	408.00	
95+620.00	409.27	407.62	
95+640.00	408.93	407.28	
95+660.00	408.63	406.98	
95+680.00	408.37	406.72	
95+700.00	408.14	406.50	
95+720.00	407.97	406.33	
95+740.00	407.83	406.20	
95+760.00	407.73	406.11	
95+780.00	407.67	406.06	
95+800.00	407.65	406.05	
95+820.00	407.67	406.07	
95+840.00	407.73	406.13	
95+860.00	407.83	406.21	
95+880.00	407.97	406.33	
95+900.00	408.14	406.50	
95+920.00	408.31	406.67	
95+940.00	408.48	406.84	
95+960.00	408.65	407.01	
95+980.00	408.82	407.18	
96+000.00	408.99	407.35	
96+020.00	409.15	407.51	
96+040.00	409.28	407.64	
96+060.00	409.49	407.85	
96+080.00	409.66	408.02	
96+100.00	409.86	408.22	
96+120.00	409.99	408.35	
96+140.00	410.01	408.37	
96+160.00	410.01	408.37	
96+180.00	410.01	408.37	
96+200.00	410.01	408.37	

DATUM LEVEL=395  
PL\_REF=395

