

ELEVATIE

Sc.1:200

89.20

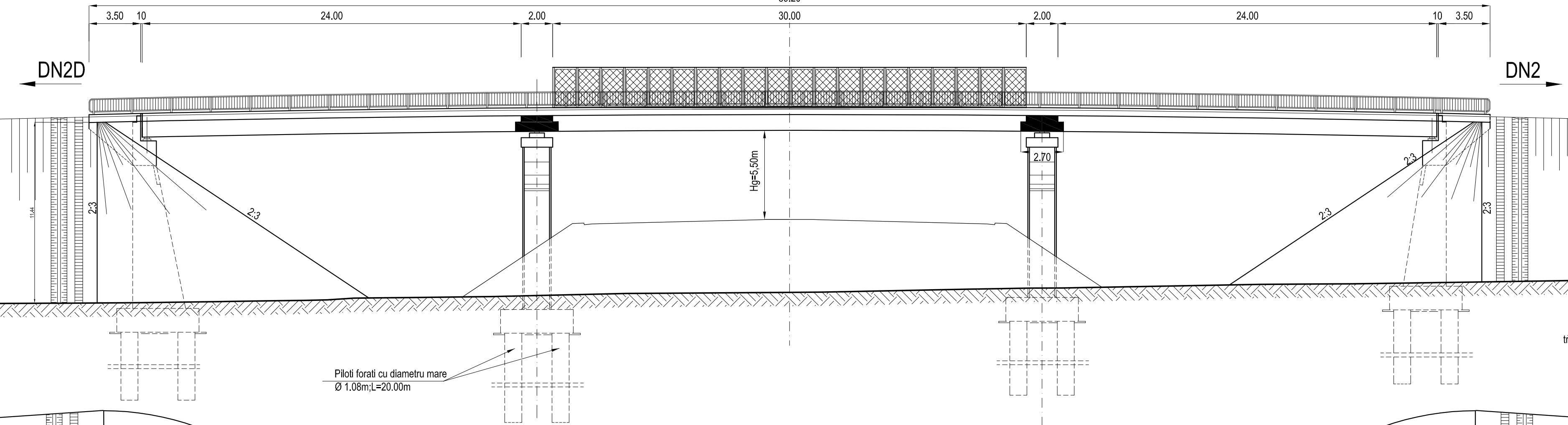

VEDERE PLANA

Sc.1:200

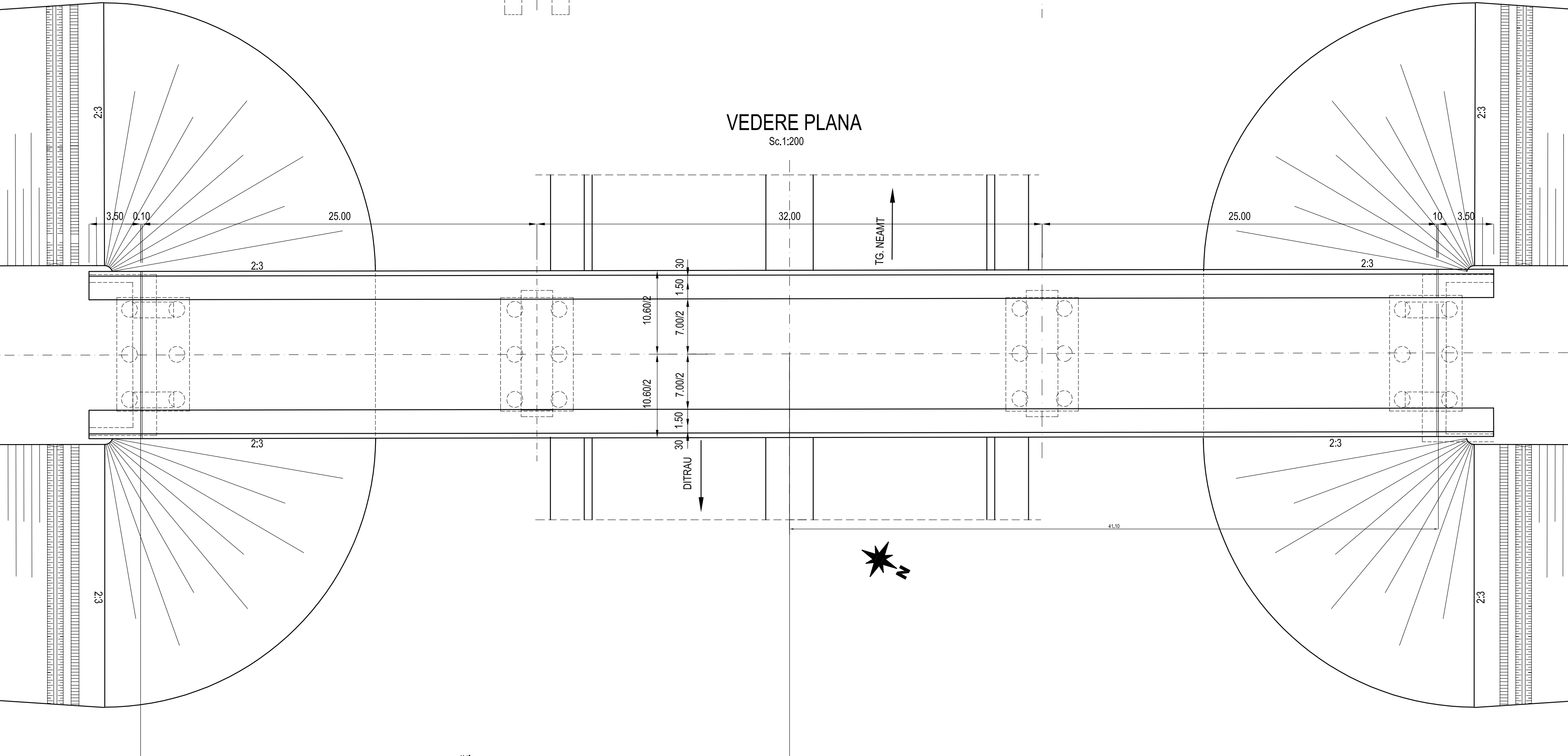

SECTIUNE TRANSVERSALA

Sc.1:100

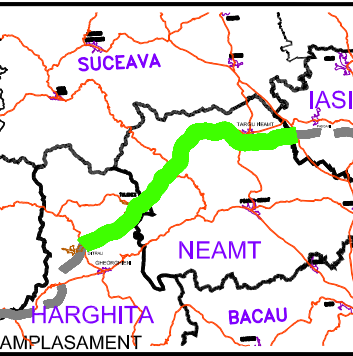
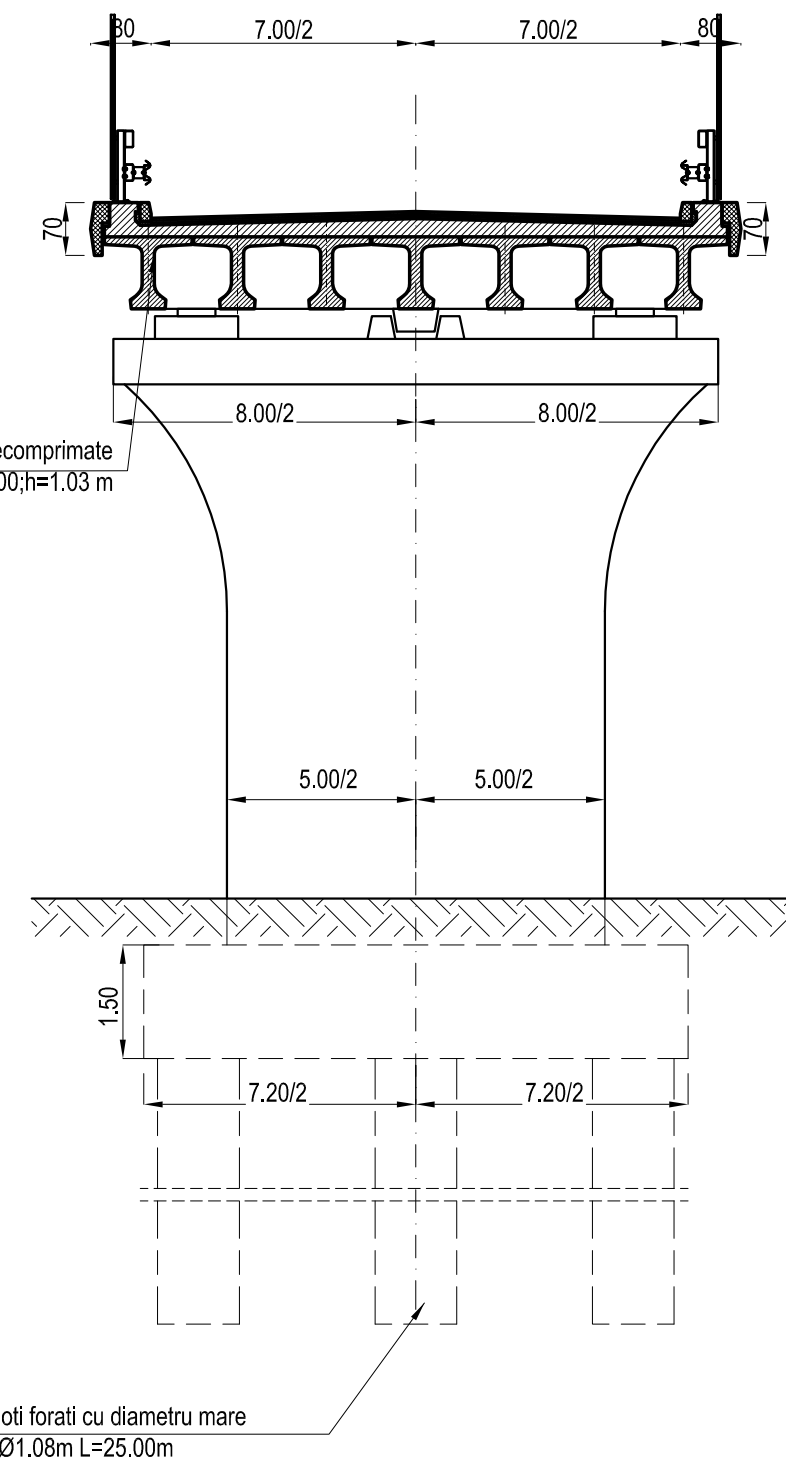

BENEFICIAR



COMPANIA NATIONALA DE AUTOSTRAZI SI DRUMURI NATIONALE DIN ROMANIA

PROIECTANT



IPTANA S.A.

INVESTITIA

AUTOSTRADA DITRAU -TARGU NEAMT

CONTRACT Nr: 92 / 58623 / 4275

FAZA DE PROIECTARE
Studiu de Fezabilitate
Varianta optima
de construire

Proiectat ing. A. Tudor	Desenat S. Campeanu
Verificat ing. A. Tudor	Sef Proiect ing. V. Osman

LUCRARI DE PODURI

Scara: 1:200, 1:100

Data: IANUARIE 2011

DISPOZITIE GENERALA
Pasaj pe DE 12 peste Autostrada
Km 107+882

Convoi de calcul conform SR EN 1991-2-2005
Caracteristicile seismice ale zonei: $a_g=0.20g$,
 $T_c=0.70s$ conform cod P100-1/2006
Zona seismică "6" conform SR11100/1-1993
Categoria de importanta privind calitatea "B"