

SECTIUNE TRANSVERSALA

Sc1:50

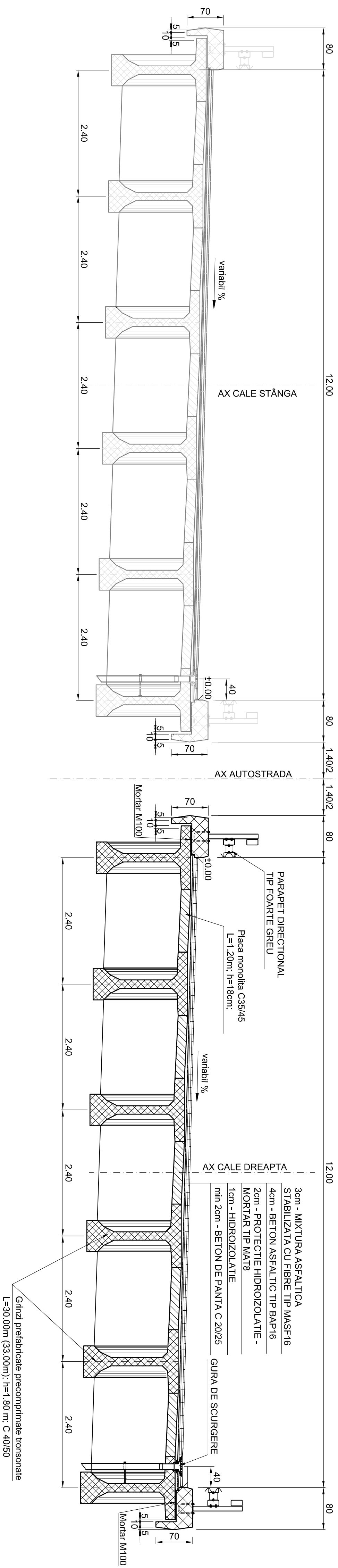

NOTA:
SE APLICA LA STRUCTURILE:
 18; 19; 23; 24; 61;76; 82; 132;
 154; 158;

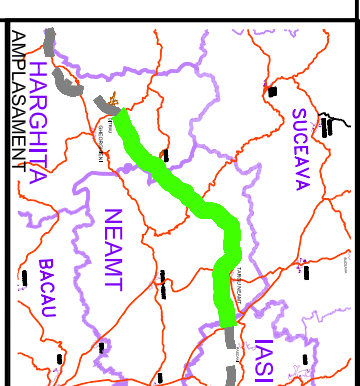

BENEFICIAR

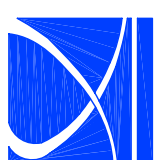

COMPANIA NATIONALA DE AUTOSTRAZI
 SI DRUMURI NATIONALE DIN ROMANIA

PROIECTANT

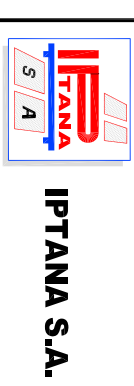

IPTANA S.A.

INVESTITIA

AUTOSTRADA
 DITRAU -TARGU NEAMT

CONTRACT Nr.: 92 / 58623 / 4275

FAZA DE PROIECTARE
 Studiu de Fezabilitate

Proiectat Ing. C. Radu	Desenat th. M. Albu
---------------------------	------------------------

Verificat Ing. C. Gadea	Seif Proiect Ing. V. Osman
----------------------------	-------------------------------

LUCRARI DE PODURI

Scara: 1:50

Data: IANUARIE 2011

SECTIUNE TRANSVERSALA
 POD CU SUPRASTRUCTURA
 DIN GRINZI PREFABRICATE
 PRETENSIONATE
 L=30.00m(33.00m); h=1.80m
 (B)

Cod: IPT-SF-A-S1-D11

Rev. 0