

SECTIUNI TRANSVERSALE

ÎN CÂMP

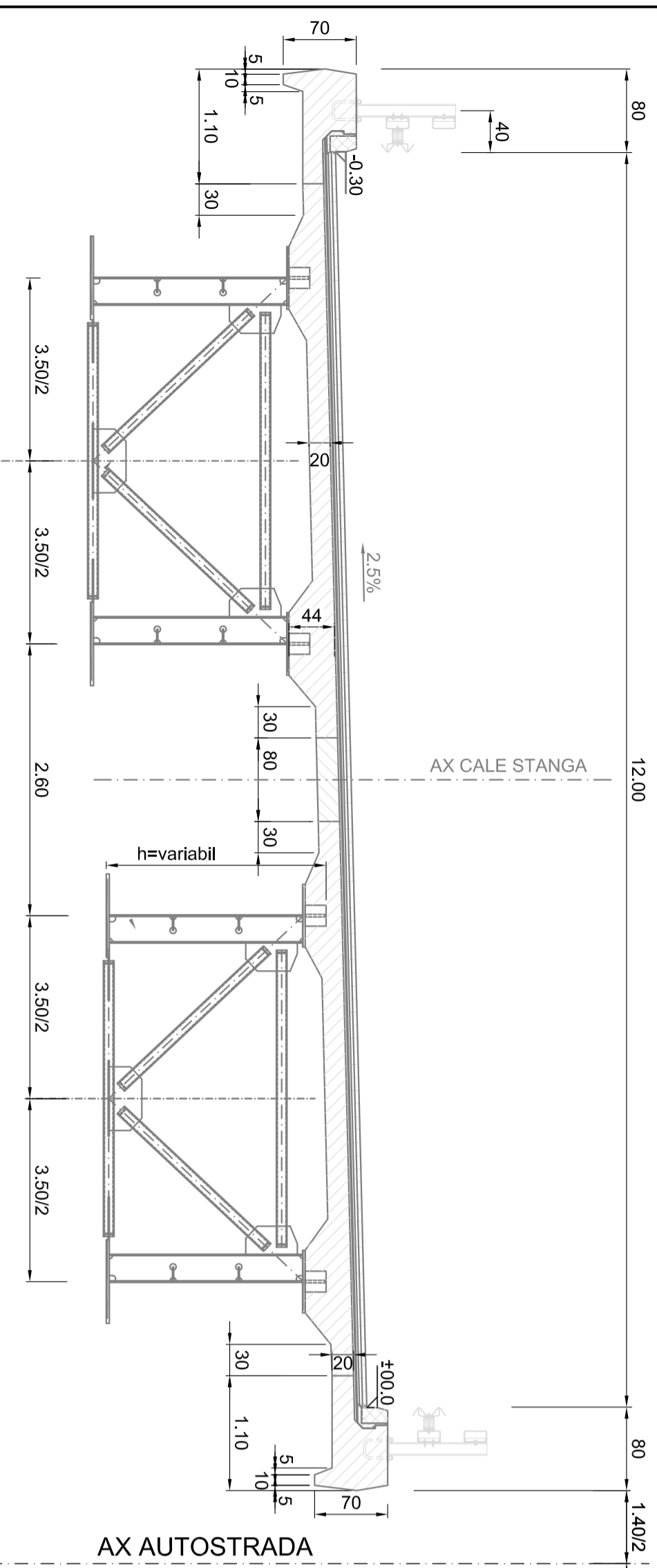

PE REAZEM

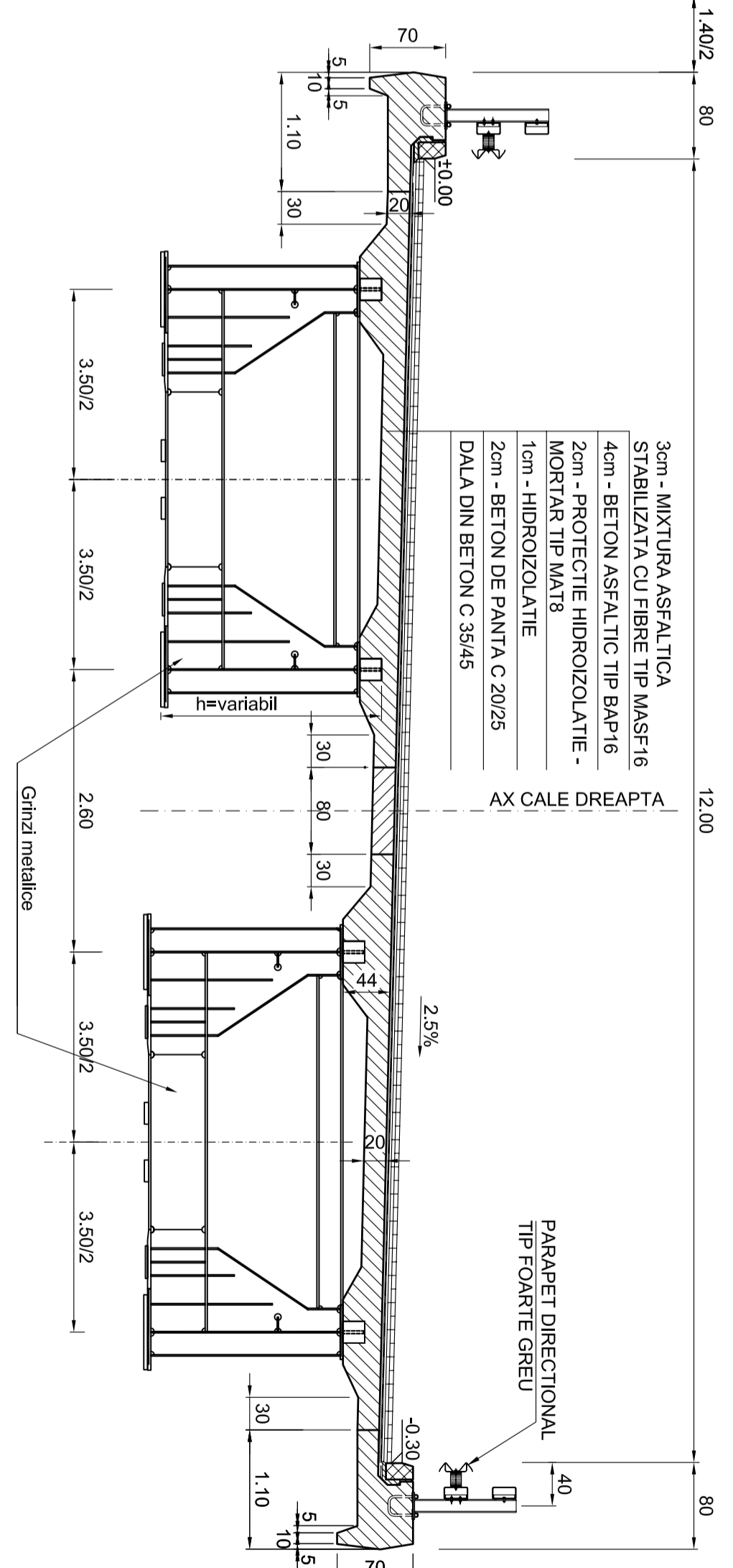
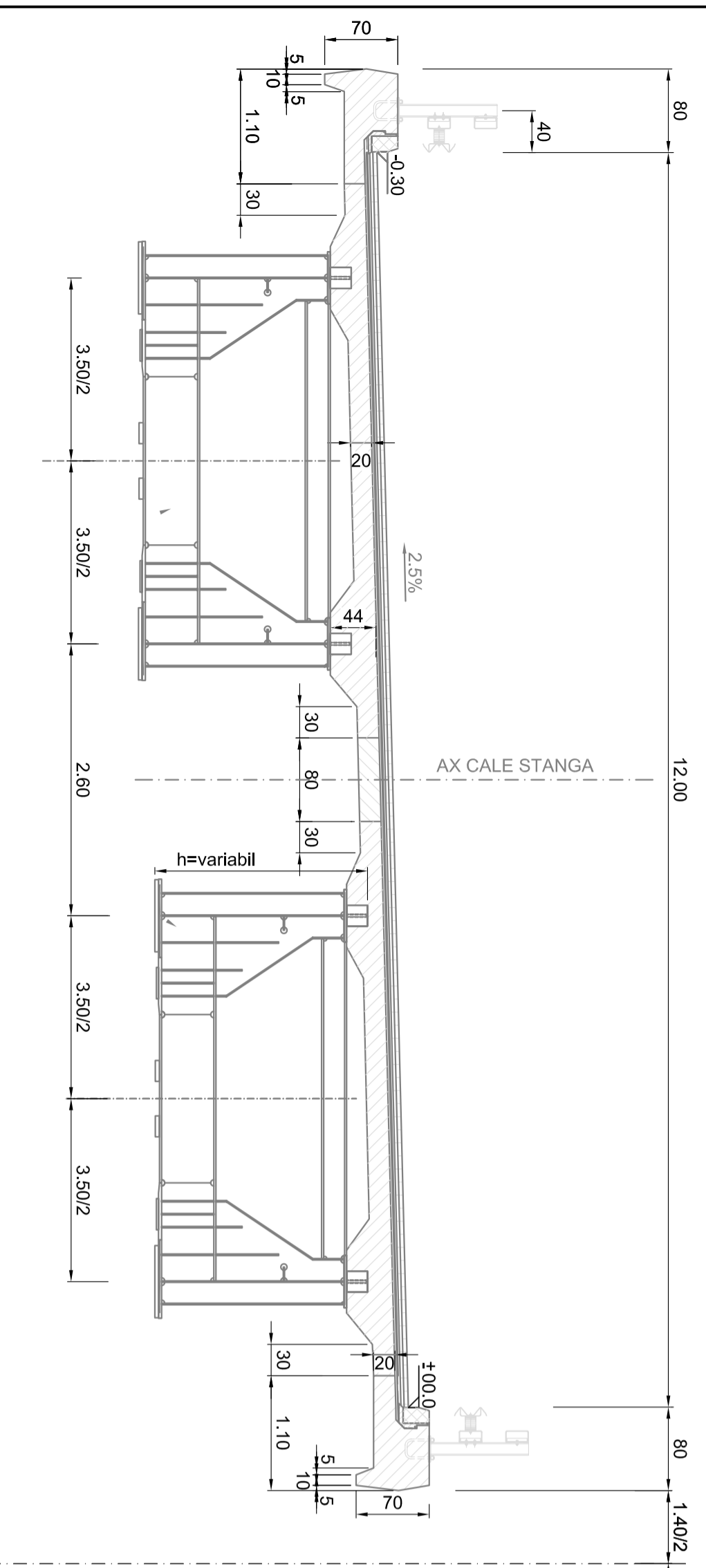
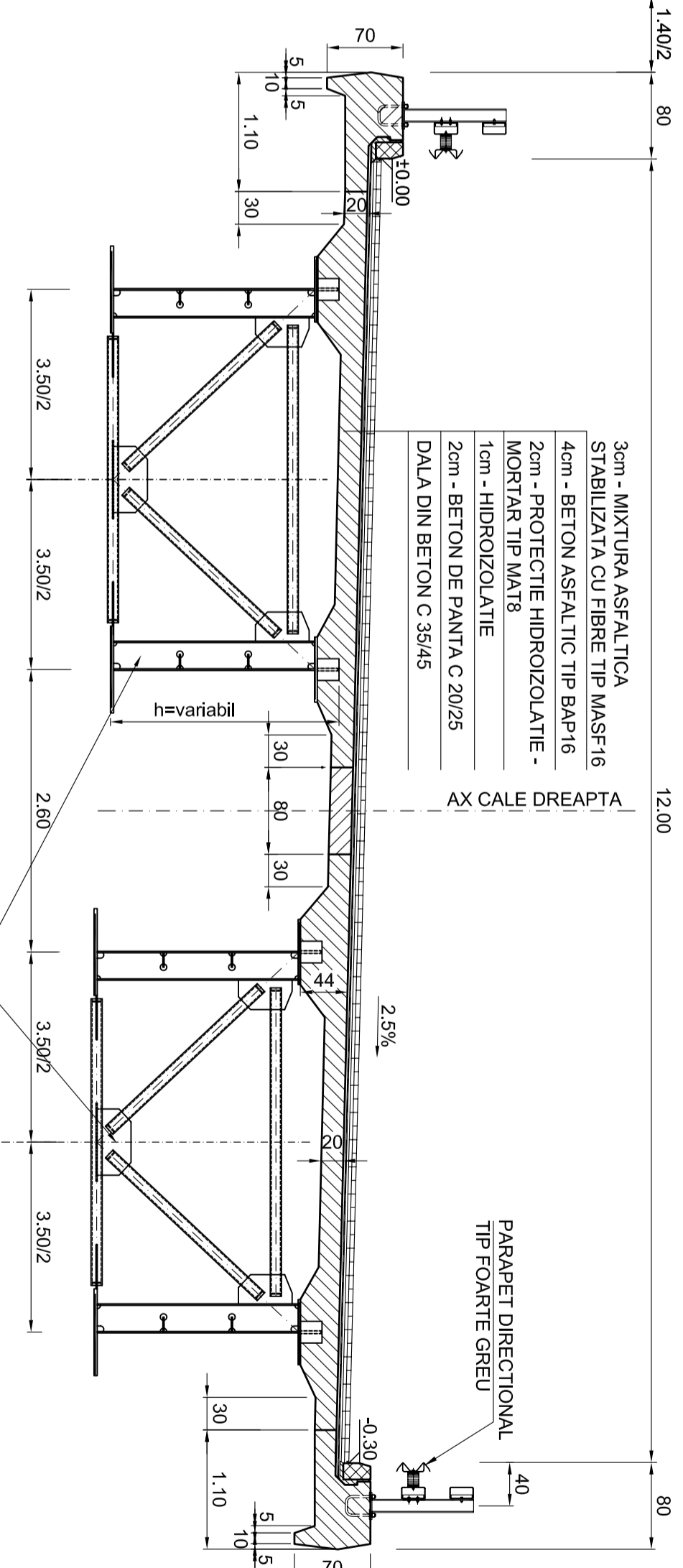

NOTA:
SE APLICA LA STRUCTURILE:
3: 17; 53; 70; 97; 107; 108;
109; 116; 137; 139; 141;
144; 148; 162; 163; 170;
172; 174; 177

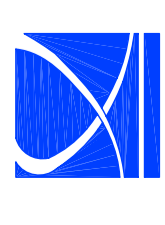
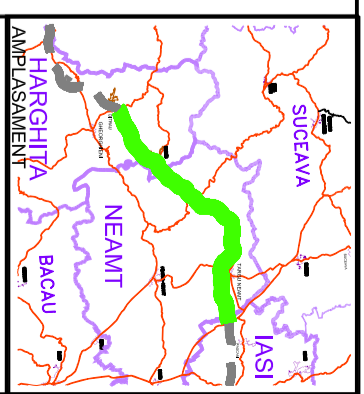

COMPANIA NATIONALA DE AUTOSTRAZI SI DRUMURI NATIONALE DIN ROMANIA

PROIECTANT

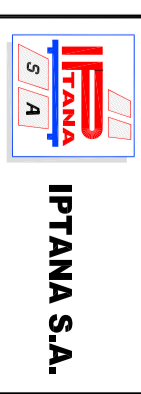

INVESTITIA

AUTOSTRADA
DITRAU - TARGU NEAMT

CONTRACT NR: 92 / 58623 / 4275

FAZA DE PROIECTARE
Studiu de Fezabilitate

Proiectat
Ing. I. Stolian

Desenat
th. M. Albu

Verificat
Ing. C. Galdes

Sef Proiect
Ing. V. Osman

Lucrari de Poduri

Scara: 1:50
Data: IANUARIE 2011

SECTIUNE TRANSVERSALA
POD CU SUPRASTRUCTURA
COMPUSA DIN OTEL BETON
(A)

Cod: IPT-SF-P-ST-019
Rev: 0