

### ELEVATIE CALE 1

Scara 1:500

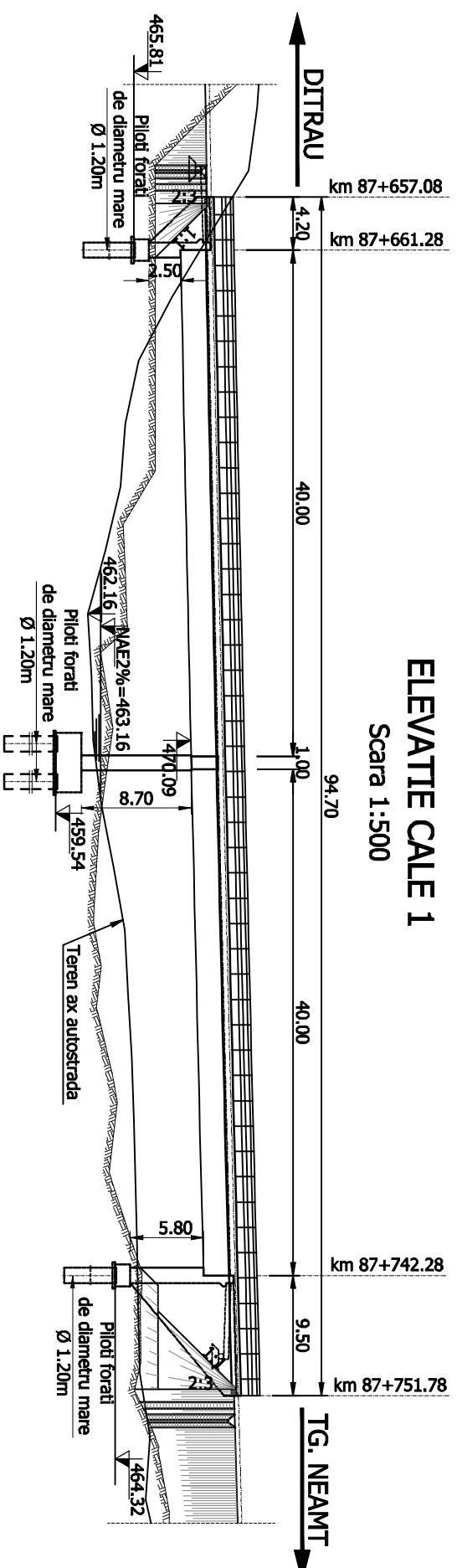

### ELEVATIE CALE 2

Scara 1:500

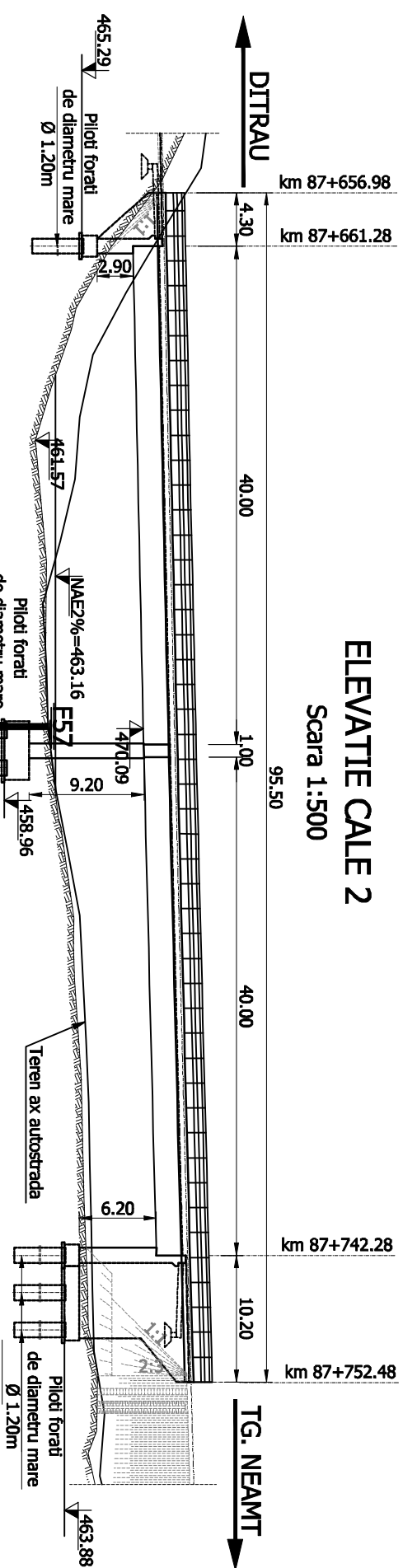

### VEDERE PLANA

Scara 1:500

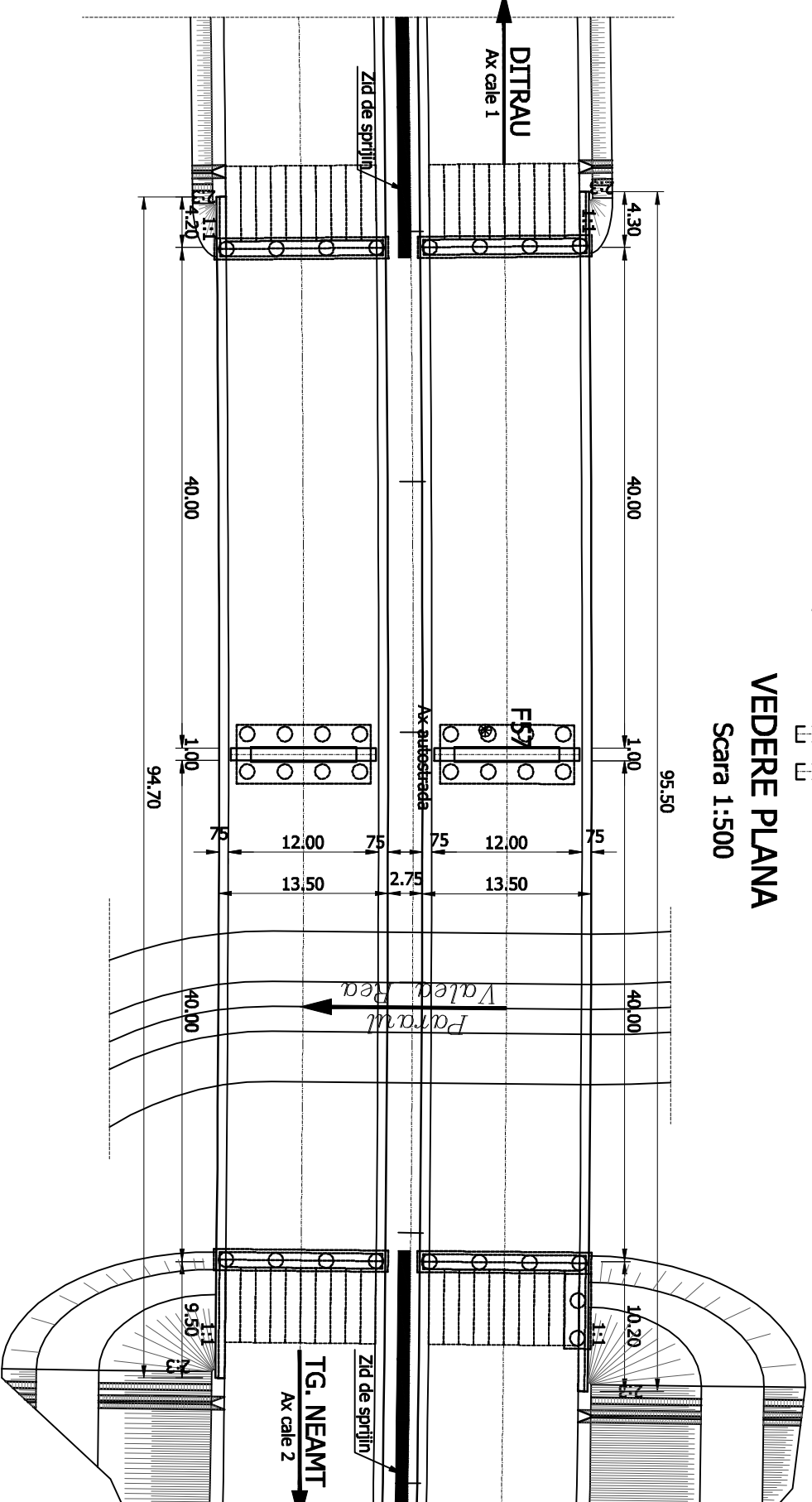

### SECTIUNE TRANSVERSALA

Scara 1:200

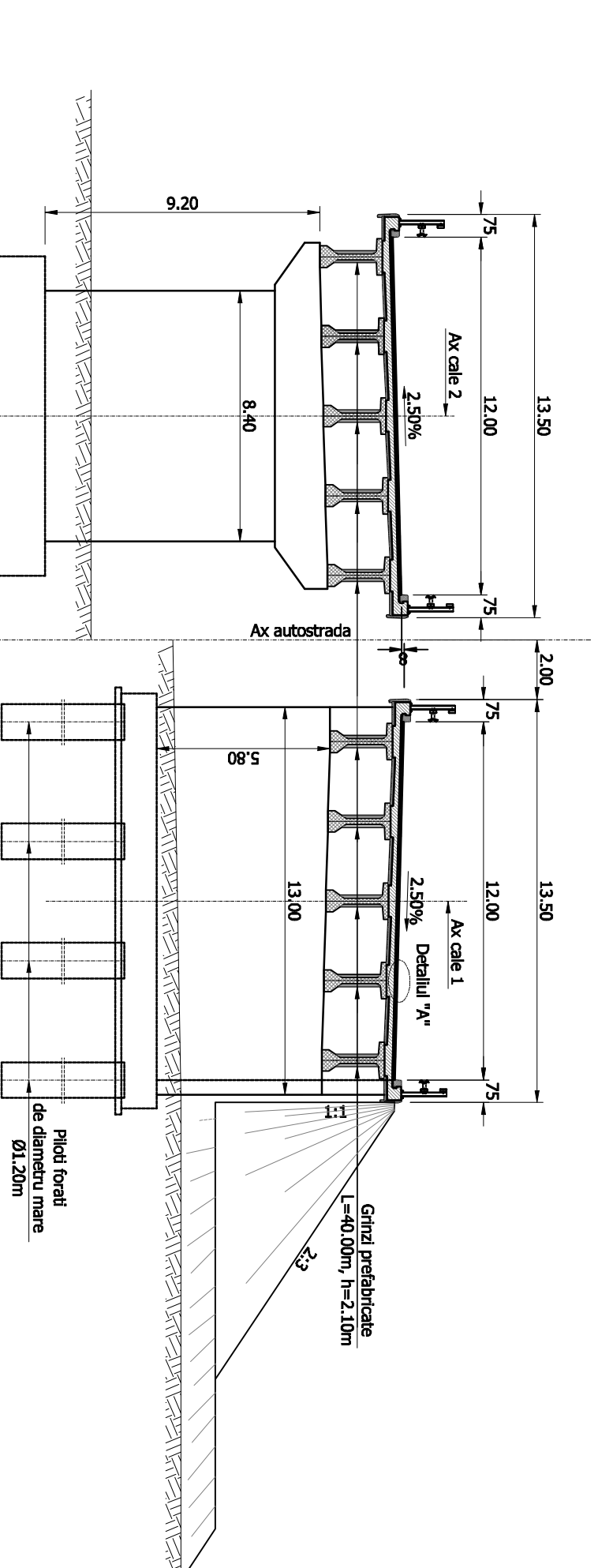

### DETALIUL "A"

Scara 1:200

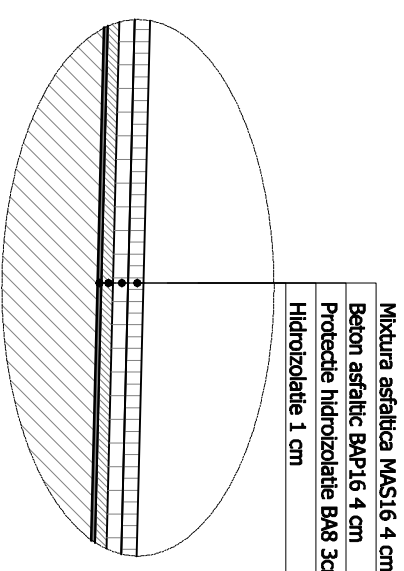

### SCHEMA STATICA - CADRU

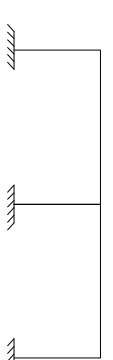

Convoi de calcul: LM1, LM2, conf. SR EN 1991-2/2005  
 Categoria de importanta: "B"  
 Exigente de verificare: A4, B2, D  
 Parametri seismici:  $a_g=0.25g$ ,  $T_c=0.70s$  conf. cod P100/1-2013,  
 SR EN 1998-2/2006

### MATERIALE

Element constructiv	Beton	Clasa de expunere / Tasaie	A/C	Ciment	Armatura
1. Beton cf. CP 012/2007	C8/10				
Beton egalizare	C30/37	XC4-XF2	S4	0.500	300
Pereu	C25/30	XC2	S4	0.60	375
Radier	C25/30	XC2-XF2	S4	0.60	260
Elemente	C30/37	XC4-XF2-XD1	S3	0.55	300
	C35/45	XC4-XF2-XD3	S3	0.50	320
	C25/30	XC2-XF2	S4	0.60	300
	C45/55	XC4-XD1-XF2	S4	0.40	320
	C50/60	XC4-XD1-XF2	S4	0.40	320
	C35/45	XC4-XF4-XD3	S3	0.50	340
	C35/45	XC4-XD1-XF4	S4	0.50	340
	C35/45	XC4-XD3-XF4	S4	0.45	340
2. Otel					
Armatura moale					B500S/C/BST1500SC
Armatura pretensionata					TBP Y1860S7
Otel tablier metalic					S355NL / S355J2+N, echivalent OL52EP

PROIECT COFINANȚAT DE UNIUNEA EUROPEANĂ PRIN PROGRAMUL OPERAȚIONAL INFRASTRUCTURĂ MARE

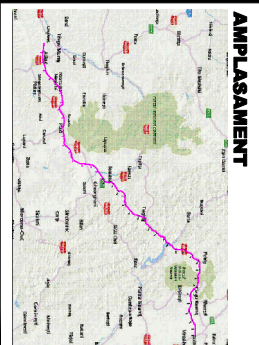

**BENEFICIAR**  
 MINISTERUL TRANSPORTURILOR ȘI INFRASTRUCTURII  
 COMPANIA NAȚIONALĂ DE ADMINISTRARE A INFRASTRUCTURII RUTIERE  
 CNAIR

**PROIECTANT GENERAL**  
**acciona**  
 SUBPROIECTANT

**INVESTITIA**  
 COMPLETAREA STUDIULUI DE FEZABILITATE PENTRU AUTOSTRADA TÂRGU MUREȘ-TÂRGU NEAMȚ

**FAZA DE PROIECTARE**  
 Studiu de Fezabilitate

Coordonator de proiect  
 Ing. CHIOTAN Vlad  
 Verificat  
 Ing. PREDESCU Mihail

Proiect nr.  
 92/36798 / 28.05.2019  
 Scara: 1:500 / 1:200 / 1:20  
 Data: Februarie 2022

Pod pe autostrada peste paraul Valea Rea  
 km 87+702  
 DISPOZITIE GENERALA