

TRASARE RADIER CULEE "C1"-fir stg			
Pct.	X-(EST)	Y-(NORD)	Z
S38-C1S-R01	231120.69	574172.40	87.78
S38-C1S-R02	231124.22	574164.67	87.78
S38-C1S-R03	231113.62	574159.83	87.78
S38-C1S-R04	231110.09	574167.56	87.78

TRASARE PILOTI CULEE "C1"-fir stg				
Pct.	X-(EST)	Y-(NORD)	Zsup	Zinf
S38-C1S-P01	231114.17	574161.29	87.88	61.78
S38-C1S-P02	231112.86	574164.15	87.88	61.78
S38-C1S-P03	231111.55	574167.02	87.88	61.78
S38-C1S-P04	231117.03	574162.60	87.88	61.78
S38-C1S-P05	231115.73	574165.46	87.88	61.78
S38-C1S-P06	231114.42	574168.33	87.88	61.78
S38-C1S-P07	231119.90	574163.90	87.88	61.78
S38-C1S-P08	231118.59	574166.77	87.88	61.78
S38-C1S-P09	231117.28	574169.63	87.88	61.78
S38-C1S-P10	231122.76	574165.21	87.88	61.78
S38-C1S-P11	231121.46	574168.08	87.88	61.78
S38-C1S-P12	231120.15	574170.94	87.88	61.78

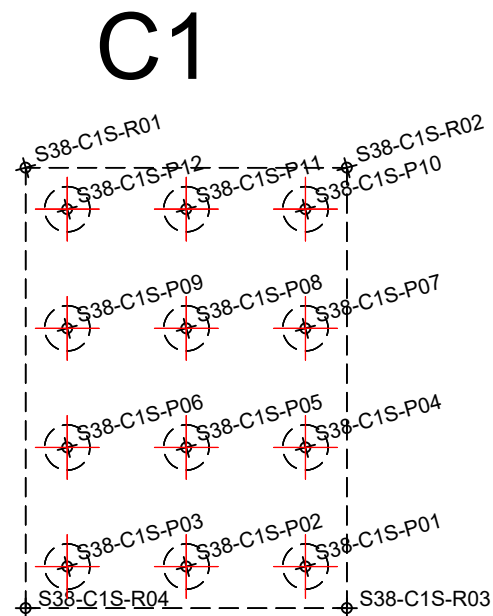

Oradea

TRASARE RADIER CULEE "C1"-fir dr			
Pct.	X-(EST)	Y-(NORD)	Z
S38-C1D-R01	231107.05	574166.17	87.78
S38-C1D-R02	231110.58	574158.44	87.78
S38-C1D-R03	231099.98	574153.60	87.78
S38-C1D-R04	231096.45	574161.33	87.78

TRASARE PILOTI CULEE "C1"-fir dr				
Pct.	X-(EST)	Y-(NORD)	Zsup	Zinf
S38-C1D-P01	231100.52	574155.06	87.88	61.78
S38-C1D-P02	231099.21	574157.93	87.88	61.78
S38-C1D-P03	231097.91	574160.79	87.88	61.78
S38-C1D-P04	231103.37	574156.41	87.88	61.78
S38-C1D-P05	231102.08	574159.23	87.88	61.78
S38-C1D-P06	231100.77	574162.10	87.88	61.78
S38-C1D-P07	231106.25	574157.68	87.88	61.78
S38-C1D-P08	231104.95	574160.54	87.88	61.78
S38-C1D-P09	231103.64	574163.41	87.88	61.78
S38-C1D-P10	231109.12	574158.98	87.88	61.78
S38-C1D-P11	231107.81	574161.85	87.88	61.78
S38-C1D-P12	231106.50	574164.71	87.88	61.78

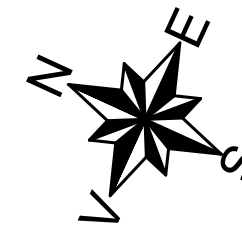
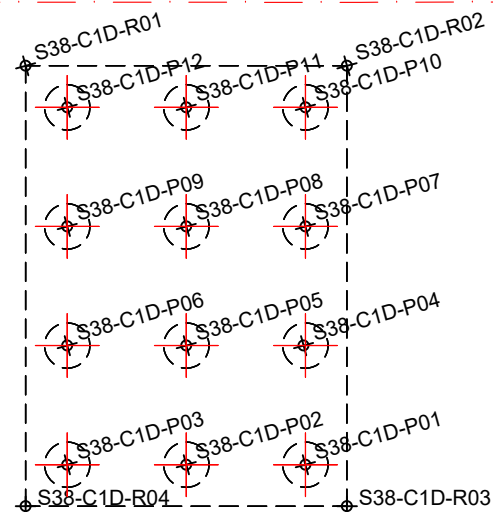

P1

TRASARE RADIER PILA "P1"- fir stanga			
Pct.	Y-(EST)	X-(NORD)	Z
S38-P1S-R01	231138.40	574134.00	86.50
S38-P1S-R02	231139.33	574132.01	86.50
S38-P1S-R03	231128.77	574127.08	86.50
S38-P1S-R04	231127.84	574129.07	86.50

TRASARE PILOTI PILA "P1"- fir stanga				
Pct.	Y-(EST)	X-(NORD)	Zsup	Zinf
S38-P1S-P01	231129.30	574128.54	86.60	60.50
S38-P1S-P02	231132.16	574129.87	86.60	60.50
S38-P1S-P03	231135.01	574131.20	86.60	60.50
S38-P1S-P04	231137.87	574132.54	86.60	60.50

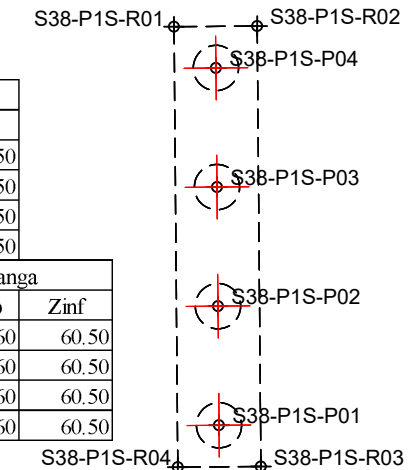

TRASARE RADIER PILA "P1"- fir dreapta			
Pct.	Y-(EST)	X-(NORD)	Z
S38-P1D-R01	231124.81	574127.65	86.50
S38-P1D-R02	231125.74	574125.66	86.50
S38-P1D-R03	231115.18	574120.73	86.50
S38-P1D-R04	231114.25	574122.73	86.50

TRASARE PILOTI PILA "P1"- fir dreapta				
Pct.	Y-(EST)	X-(NORD)	Zsup	Zinf
S38-P1D-P01	231115.71	574122.20	86.60	60.50
S38-P1D-P02	231118.57	574123.53	86.60	60.50
S38-P1D-P03	231121.42	574124.86	86.60	60.50
S38-P1D-P04	231124.27	574126.19	86.60	60.50

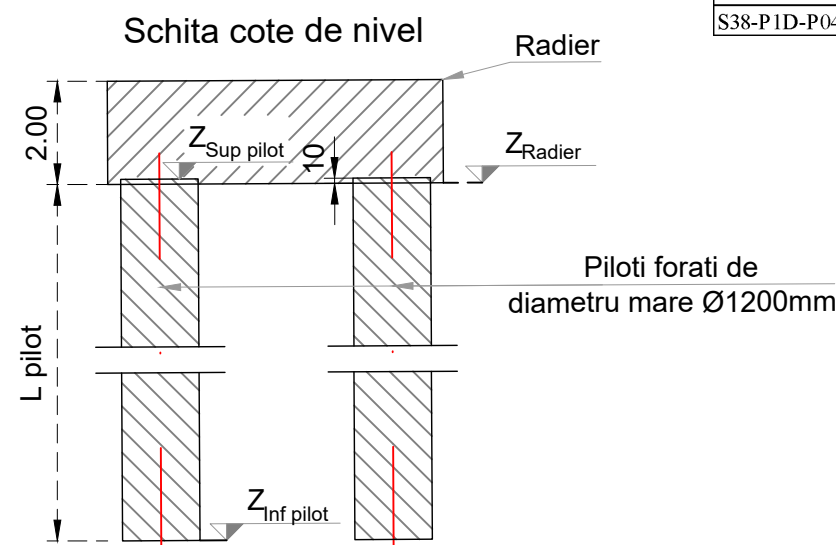
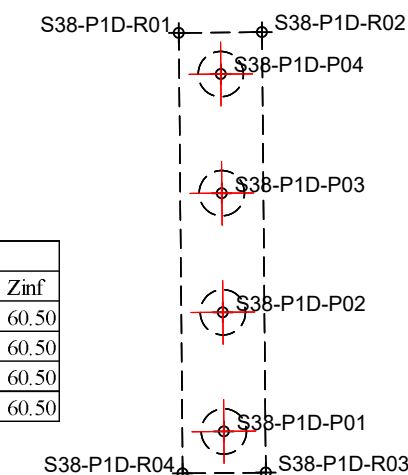

PROIECTANT / DESIGNER:
S.C. CONSTRANS S.R.L.



BENEFICIAR / BENEFICIARY:
MUNICIPIUL ARAD, MUNICIPIUL ORADEA, CONSILIUL JUDETEAN ARAD, CONSILIUL JUDETEAN BIHOR CNAIR

FUNCTIA / POSITION:
COORDONATOR DE PROIECT / PROJECT MANAGER

NUME / NAME:
ing. S. VEACESLAV

SEMNTATURA / SIGNATURE:
[Signature]

Titlu plansa / Drawing title:
Plan trasare - plan 1 / 2
Layout plan - drawing 1 / 2

REV / REV.:
R00

DATA / DATE:
11.2023

DETALII REVIZIE / REVISION DETAILS:
P.T.E.

PROIECTAT / DESIGNER:
Constrans

INVESTITIA / INVESTMENT:
ACTUALIZARE/COMPLETARE/REVIZUIRE (S.F. + P.A.C. + P.O.E + P.T.E.) "DRUM EXPRES ARAD ORADEA"
ACTUALIZATION/COMPLETION (S.F. + P.A.C. + P.O.E + P.T.E.) "EXPRESS ROAD ARAD ORADEA"

SEF PROIECT SPECIALITATE / TEAM LEADER
ing. D. COVELTIR

SEMNTATURA / SIGNATURE:
[Signature]

Pod pe DX la km 61+750 peste canal
Bridge on DX at km 61+750 over channel

FAZA PROIECTARE / DESIGN STAGE:
PROIECT TEHNIC DE EXECUTIE / EXECUTION TECHNICAL PROJECT

PROIECTAT / DESIGNER:
ing. V. URDAREANU

SEMNTATURA / SIGNATURE:
[Signature]

LUCRARI DE POD / BRIDGE WORKS

Contract /Contract: 14724/01.07.2021
Data /Date: 11.2023
Scara /Scale: 1:200

VERIFICAT / INTERNAL CHECKER:
ing. D. COVELTIR

SEMNTATURA / SIGNATURE:
[Signature]

Cod plansa / Drawing code:
CST-0121-PTE-02-DX- 02-P38-PTR-01-R00



UNIUNEA EUROPEANA



GUVERNUL ROMANIEI



Instrumente Structurale 2014-2020

PROIECT CO-FINANAT DIN FONDUL DE COEZIUNE, PRIN PROGRAMUL OPERATIONAL INFRASTRUCTURA MARE / PROJECT CO-FINANCED FROM THE COHESION FUND, THROUGH THE LARGE INFRASTRUCTURE OPERATIONAL PROGRAM

C2

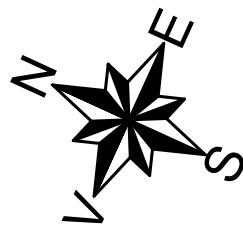
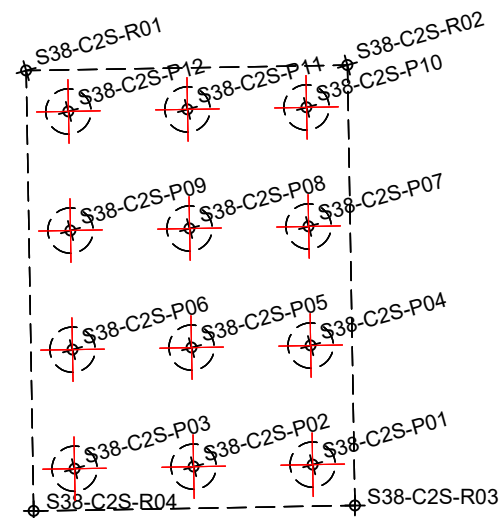

Arad

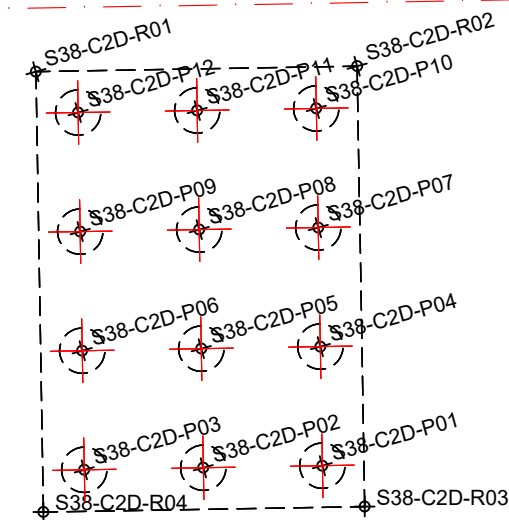

TRASARE RADIER CULEE "C2"-fir stg

Pct.	X-(EST)	Y-(NORD)	Z
S38-C2S-R01	231153.73	574101.44	87.95
S38-C2S-R02	231157.40	574093.77	87.95
S38-C2S-R03	231146.88	574088.76	87.95
S38-C2S-R04	231143.22	574096.43	87.95

TRASARE PILOTI CULEE "C2"-fir stg

Pct.	X-(EST)	Y-(NORD)	Zsup	Zinf
S38-C2S-P01	231147.40	574090.22	88.05	61.95
S38-C2S-P02	231146.04	574093.06	88.05	61.95
S38-C2S-P03	231144.69	574095.91	88.05	61.95
S38-C2S-P04	231150.24	574091.58	88.05	61.95
S38-C2S-P05	231148.89	574094.42	88.05	61.95
S38-C2S-P06	231147.53	574097.26	88.05	61.95
S38-C2S-P07	231153.09	574092.94	88.05	61.95
S38-C2S-P08	231151.73	574095.78	88.05	61.95
S38-C2S-P09	231150.37	574098.62	88.05	61.95
S38-C2S-P10	231155.93	574094.29	88.05	61.95
S38-C2S-P11	231154.57	574097.14	88.05	61.95
S38-C2S-P12	231153.21	574099.98	88.05	61.95

TRASARE RADIER CULEE "C2"-fir dr

Pct.	X-(EST)	Y-(NORD)	Z
S38-C2D-R01	231140.20	574094.98	87.95
S38-C2D-R02	231143.86	574087.31	87.95
S38-C2D-R03	231133.34	574082.29	87.95
S38-C2D-R04	231129.68	574089.97	87.95

TRASARE PILOTI CULEE "C2"-fir dr

Pct.	X-(EST)	Y-(NORD)	Zsup	Zinf
S38-C2D-P01	231133.86	574083.76	88.05	61.95
S38-C2D-P02	231132.51	574086.60	88.05	61.95
S38-C2D-P03	231131.15	574089.45	88.05	61.95
S38-C2D-P04	231136.71	574085.12	88.05	61.95
S38-C2D-P05	231135.35	574087.96	88.05	61.95
S38-C2D-P06	231133.99	574090.80	88.05	61.95
S38-C2D-P07	231139.55	574086.47	88.05	61.95
S38-C2D-P08	231138.19	574089.32	88.05	61.95
S38-C2D-P09	231136.83	574092.16	88.05	61.95
S38-C2D-P10	231142.39	574087.83	88.05	61.95
S38-C2D-P11	231141.03	574090.67	88.05	61.95
S38-C2D-P12	231139.68	574093.52	88.05	61.95

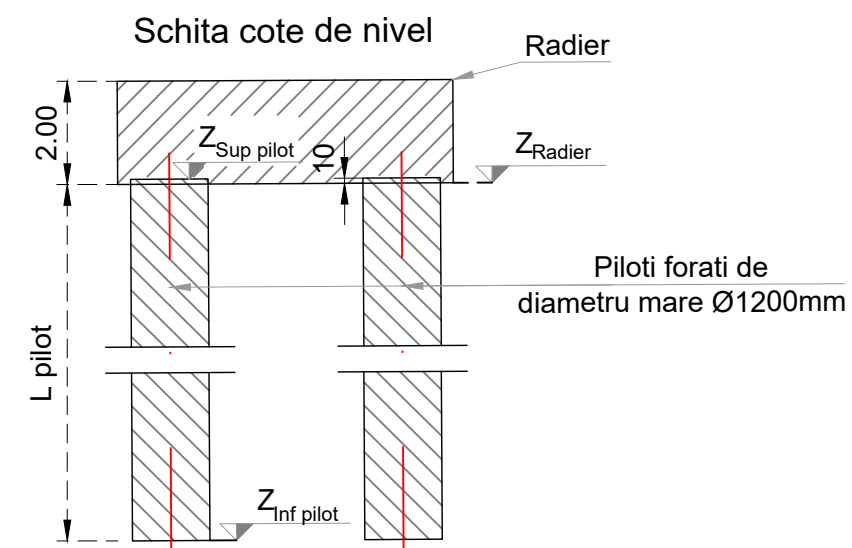

PROIECTANT / DESIGNER:
S.C. CONSTRANS S.R.L.



BENEFICIAR / BENEFICIARY:
MUNICIPIUL ARAD, MUNICIPIUL ORADEA, CONSILIUL JUDETEAN ARAD, CONSILIUL JUDETEAN BIHOR CNAIR

FUNCTIA / POSITION:
COORDONATOR DE PROIECT / PROJECT MANAGER

NUME / NAME:
ing. S. VEACESLAV

SEMNATURA / SIGNATURE:
[Signature]

Titlu plansa / Drawing title:
Plan trasare - plan 2 / 2
Layout plan - drawing 2 / 2

REV. / REV.:
R00

DATA / DATE:
11.2023

DETALII REVIZIE / REVISION DETAILS:
P.T.E.

PROIECTAT / DESIGNER:
Constrans

INVESTITIA / INVESTMENT:
ACTUALIZARE/COMPLETARE/REVIZUIRE (S.F. + P.A.C. + P.O.E + P.T.E.) "DRUM EXPRES ARAD ORADEA"
ACTUALIZATION/COMPLETION (S.F. + P.A.C. + P.O.E + P.T.E.) "EXPRESS ROAD ARAD ORADEA"

SEF PROIECT SPECIALITATE / TEAM LEADER
ing. D. COVELTIR

SEMNATURA / SIGNATURE:
[Signature]

Pod pe DX la km 61+750 peste canal
Bridge on DX at km 61+750 over channel

REV. / REV.:
R00

DATA / DATE:
11.2023

DETALII REVIZIE / REVISION DETAILS:
P.T.E.

PROIECTAT / DESIGNER:
Constrans

FAZA PROIECTARE / DESIGN STAGE:
PROIECT TEHNIC DE EXECUTIE / EXECUTION TECHNICAL PROJECT

PROIECTAT / DESIGNER:
ing. V. URDAREANU

SEMNATURA / SIGNATURE:
[Signature]

LUCRARI DE POD / BRIDGE WORKS

REV. / REV.:
R00

DATA / DATE:
11.2023

DETALII REVIZIE / REVISION DETAILS:
P.T.E.

PROIECTAT / DESIGNER:
Constrans

Contract / Contract: 14724/01.07.2021
Data / Date: 11.2023
Scara / Scale: 1:200

VERIFICAT / INTERNAL CHECKER:
ing. D. COVELTIR

SEMNATURA / SIGNATURE:
[Signature]

Cod plansa / Drawing code:
CST-0121-PTE-02-DX- 02-P38-PTR-02-R00

REV. / REV.:
R00

DATA / DATE:
11.2023

DETALII REVIZIE / REVISION DETAILS:
P.T.E.

PROIECTAT / DESIGNER:
Constrans



UNIUNEA EUROPEANA



GUVERNUL ROMANIEI



Instrumente Structurale 2014-2020

PROIECT CO-FINANAT DIN FONDUL DE COEZIUNE, PRIN PROGRAMUL OPERATIONAL INFRASTRUCTURA MARE / PROJECT CO-FINANCED FROM THE COHESION FUND, THROUGH THE LARGE INFRASTRUCTURE OPERATIONAL PROGRAM